

TABLE OF CONTENTS

Introduction	Page 2, 3
Emergency Lighting	
Phantom PM Series	4, 5
605-M Series	6
RSQ Series.....	7
RD Series	8, 9
TBR Series.....	10, 11
MG Series	12, 13
PG, P12G Series	14, 15
PN, P12N Series	16, 17
PQ, P12Q Series	18, 19
S12E Series	20
SL, S12L Series	21
SN, S12N Series	22
Fluorescent Power Pack	
FF-AM Series	23
AM Series	24, 25
Exit Signs and Combo Units	
Simplicity™ Series Exit Signs	26, 27
Genesis™ Series Exit Signs.....	28, 29
U8XL Series Exit Signs	30
U8XL Series Combo Unit	31
8XJSLED Series Combo Unit	32, 33
Severe XV™ Series Exit Sign.....	34
Severe XV™ Series Combo Unit	35
AC Central Systems	36
Remote Fixtures	
Saf-T-Ray™ SAF Series.....	37
Decorative Remote Series	38, 39
Remote Fixture Series.....	40, 41
Lamp Chart	42, 43
Accessories	44, 45
Popular Options	46
Improved Diagnostics	47
Wiring Size Guide	48
Life Safety	49-51
Limited Warranty	52

N.Y.C.-APPROVED

Lightalarms is proud to present its complete range of N.Y.C.-approved life safety equipment. For as long as there has been emergency lighting, New York City has specified the Lightalarms brand. We are proud to continue the tradition that began more than half a century ago with a new catalogue that showcases the complete range of Lightalarms N.Y.C.-approved equipment.



SETTING THE STANDARD

When it comes to life safety, there can be no compromise. The Lightalarms products on the following pages are designed, manufactured and tested to meet some of the most demanding standards in North America — N.Y.C. standards.

The complete line of Lightalarms life safety products meets or exceeds the requirements of UL 924, NFPA 101, Life Safety Code, N.E.C and I.C.C. standards.

From high-end architectural to industrial installations, for new construction and retrofit projects, there's a Lightalarms product to meet your specifications.

**Lightalarms — lighting the way
to safety since 1953.**





PHANTOM PM Series

Decorative Style Recessed Equipment
12-Volt, Maintenance-Free, Long Life Lead-Calcium Battery
Evaluated to UL 924 Standards

Blending into any environment, the Phantom PM Series emergency lighting unit goes unnoticed until it is needed. When AC power fails and the lights go out, the Phantom PM unit emerges to illuminate the path to safety. Once AC power is restored, the automated motor assembly drives the door back to the closed position.

FEATURES

- **RELIABILITY:** The Phantom PM Series has a three-year full warranty (excluding lamps).
- **CONSTRUCTION:** Design combines ease of installation for the contractor and quality of finish for the architect or designer. The lighting assembly features a high quality, white finish. The heavy-duty, galvanized steel back box has no holes and a corrosion-resistant finish.
- **MOUNTING:** Recess mounts into walls or ceiling.
- **ELECTRONICS:**
 - ♦ Automatic, temperature-compensated, charger.
 - ♦ High capacity, automatic, dust tight instantaneous transfer relay.
 - ♦ Low voltage disconnect prevents over discharge of battery. Automatic brownout protection is provided.
 - ♦ Fused output circuits.
- **CONTROLS:**
 - ♦ Internally illuminated test switch.
- **POWER REQUIREMENTS:**
 - ♦ 120/277 Volt AC.



APPLICATIONS

The "unseen solution" for use in walls or ceilings with a cavity. Ideally suited for any interior application where aesthetics are of importance.

BATTERY

Long-life, maintenance-free sealed Lead-Calcium. Provides 90 minutes of emergency illumination.

LAMP HEADS

The unit includes MR16 lamps supported by metallic swivels, with 100 degrees of aiming. MR16 lamps are available in 12, 20, 35 and 50 watts.

UNIT SELECTION CHART

Self-Powered Fixtures

12PM36-2(12)	12 watt heads (12-volt, 36 watts)
12PM54-2(12)	12 watt heads (12-volt, 54 watts)
12PM54-2(20)	20 watt heads* (12-volt, 54 watts)
12PM70-2(35)	35 watt heads* (12-volt, 70 watts)
12PM100-2(50)	50 watt heads* (12-volt, 100 watts)

*Do not exceed rated unit capacity.

Remote Fixtures (requires an external AC and DC source)

12PMR12-2	(2 heads, 12-volt, 12 watts each)
12PMR20-2	(2 heads, 12-volt, 20 watts each)
24PMR20-2	(2 heads, 24-volt, 20 watts each)
12PMR35-2	(2 heads, 12-volt, 35 watts each)
24PMR35-2	(2 heads, 24-volt, 35 watts each)
12PMR50-2	(2 heads, 12-volt, 50 watts each)
24PMR50-2	(2 heads, 24-volt, 50 watts each)

PHANTOM PM Series



ORDERING FORMAT

12 PM 36 -2 (12) -ID
 ① ② ③ ④ ⑤ ⑥

- ① — 12Voltage
- ② — PM.....Series
- ③ — 36Wattage (See Unit Selection Chart)
- ④ — -2Number of Lamps Heads
- ⑤ — (12).....Wattage of Lamps
- ⑥ — -ID.....Options

Custom colors and finishes available on request.

ORDERING FORMAT (for Remote)

12 PMR 12 -2
 ① ② ③ ④

- ① — 12Voltage
- ② — PMR.....Series
- ③ — 12Wattage of Lamps
(see remote selection chart)
- ④ — -2Number of Lamp Heads

POWER CONSUMPTION CHART

AC Input	Maximum		Stand-By	
	Input Current (A)	Input Power (Watts)	Input Current (A)	Input Power (Watts)
120V	0.21	21	0.060	4
277V	0.09	21	0.025	4

DIMENSIONS

Dimensions are approximate and subject to change.

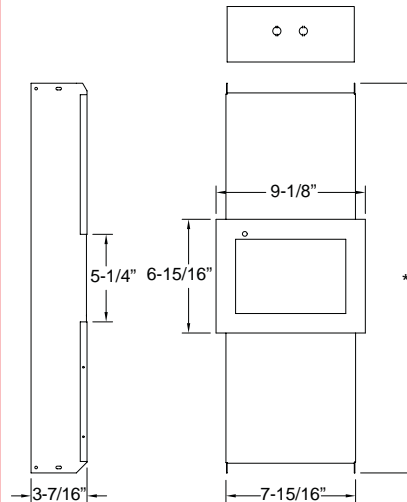

Charger & Battery Compartment:
 For use in walls or ceilings with a cavity, not for use in block walls or solid ceilings.
 **23-3/4" for up to 12V 70W, 29" for 12V 100W*
 *(not suitable for T-Bar ceiling)

UNIT RATING CHART

*Watts to 87-1/2% of rated battery voltage

Model #	1-1/2 hrs.	2 hrs.	3 hrs.	4 hrs.
12PM36	36	24	-	-
12PM54	54	40	36	24
12PM70	70	48	40	28
12PM100	100	70	60	40

*National Electrical Code Specification



OPTIONS

(Add suffix to Model No.)

Improved Diagnostics.....-ID
 Less Back Box.....-LBB*

*Unit must be installed with our back box to retain listing.

ACCESSORIES

(Order as separate item)

Remote Test SwitchPSW
 Back Box Only (36-70W Unit)061243-L*
 Back Box Only (100W Unit)061266-L*

*Order only when back box is needed in advance.



605-M Series

Decorative Style Recessed Gimbal Unit
6-Volt, Maintenance-Free, Lead-Calcium Battery
Listed to UL 924 Standards

The 605-M Series emergency luminaire is a classic recessed downlight style unit with a gimbal-mounted lamp. The unit recesses fully into the ceiling, leaving only the lens and trim visible.

FEATURES

- **RELIABILITY:** The 605-M Series has a three-year full warranty (excluding lamps and pilot lights).
- **CONSTRUCTION:** All components are contained in drawn steel back box. Standard finish of trim is white.
- **MOUNTING:** Recess mounts into ceiling. Series 605-M is UL-approved for use in insulated ceilings. Adjustable hanger bars are supplied with each unit.
- **ELECTRONICS:**
 - ♦ Automatic, temperature-compensated, pulse-type charger.
 - ♦ High capacity, automatic, dust-tight instantaneous transfer relay.
 - ♦ Labor-saving AC line latch prevents battery discharge during installation to a non-energized circuit.
 - ♦ Low voltage disconnect prevents overdischarge of battery. Automatic brownout protection is provided.
- **CONTROLS:**
 - ♦ Combination AC-ON/charge monitor LED.
 - ♦ Momentary test switch allows for quick operational check of entire system.
- **POWER REQUIREMENTS:**
 - ♦ 120/277 Vac, 60Hz, 0.3/0.15A.

APPLICATIONS

Ideally suited for low ceilings. Blends inconspicuously with existing recessed lighting schemes.

BATTERY

6-volt, maintenance-free sealed Lead-Calcium, Long Life Lead or Nickel-Cadmium. Provides 90 minutes of emergency illumination.

LAMP HEADS

Unit is supplied with an 8 watt, high-intensity halogen lamp. Gimbal ring has a horizontal rotation of 358° and a vertical angle adjustable to 42°.

ORDERING FORMAT

605 **P1** /**LH5** **-R** **-M** **-B**
① ② ③ ④ ⑤ ⑥

- ①— **605**Series
- ②— **P1**Battery Type and Capacity
- ③— **/LH5**Lamp Suffix
- ④— **-R**Recessed
- ⑤— **-M**Metal
- ⑥— **-B**.....Black

OPTIONS (Add suffix to Model No.)

Black Trim and Gimbal **-B**

ACCESSORIES

Remote Test Switch **PSW**
Wire Guard **WG11-L**



UNIT SELECTION CHART

Battery Type	Volts	Model No.	*Watts to 87-1/2% of Nominal Battery Voltage		Standard Lamps		
			1-1/2 Hrs.	2 Hrs.	Watts	Type	Replace. No.
Lead-Calcium	6	605P1/LH5-R-M	9	-	8	Halogen	580.0013
Long Life Lead	6	605E1/LH5-R-M	9	-	8	Halogen	580.0013
Nickel-Calcium	6	605C1/LH5-R-M	18	12	8	Halogen	580.0013
Long Life Lead	6	605E2/LH5-R-M	18	11	8	Halogen	580.0013

*National Electrical Code Specification

DIMENSIONS

Dimensions are approximate and subject to change.

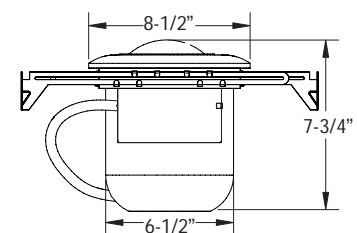
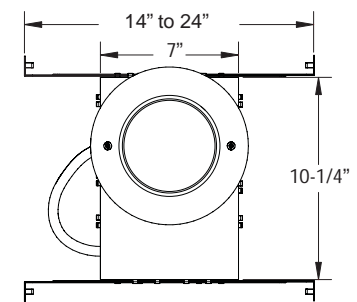

RSQ Series

Decorative Style Unit Equipment
6-Volt Maintenance-Free Long Life Lead-Calcium or Nickel-Cadmium Battery
Listed to UL 924 Standards

The RSQ Series is a clean, contemporary-styled unit that provides non-obtrusive emergency lighting in any institutional or commercial environment. These units are available as fully recessed mount.



APPLICATIONS

For institutional and commercial environments where overall style of decor is essential and where directional lighting is not critical.

BATTERY

Choice of 6-volt long life, maintenance-free sealed Lead-Calcium or Nickel-Cadmium battery. Provides 90 minutes of emergency illumination.

UNIT SELECTION CHART



No remote capability							
Volts	Model No.	Battery	*Watts to 87-1/2% of Nominal Battery Voltage		Standard Lamps		
			1-1/2 Hrs.	2 Hrs.	Watts	Type	Replace. No.
6	RSQG-NY	Sealed Lead	10	-	10	Halogen	580.0017
6	RSQN-NY	Sealed Nick. Cad.	10	-	10	Halogen	580.0017
With remote capability							
6	RSQG-D-NY	Sealed Lead	24	18	2x6	Halogen	580.0012
6	RSQN-D-NY	Sealed Nick. Cad.	24	18	2x6	Halogen	580.0012

*National Electrical Code Specification

LAMP HEADS

Furnished with one high efficiency tungsten halogen lamp. Provides a non-directional even light distribution with beam spread of more than 170°.

ORDERING FORMAT

RSQ G -NY
① ② ③

- ① — RSQ.....Series
- ② — GBattery type
- ③ — -NY.....NYC-Approved Version

OPTIONS (Add suffix to Model No.)

Self or Improved Diagnostics-ID*
Improved Diagnostics Non-Audible ...-IDNA
Voltmeter (not available with diagnostics)-V
Time Delay (12 minutes)-TD**

*Not available with Nicad
**Not required with ID/IDNA option

ACCESSORIES (Order as separate item)

Wire Guard..... WG11-L

FEATURES

- **RELIABILITY:** The RSQ Series comes complete with a 3-year full warranty (excluding lamps).
- **HOUSING:** 20 gauge fire-resistant steel with frame and trim finished in white enamel. Clear prismatic lens.
- **MOUNTING:** Fully recesses into T-bar or exposed Z-spline ceilings. Mounting brackets and supporting bars are included. Series RSQ is UL approved for use in insulated ceilings.
- **ELECTRONICS:**
 - ♦ Automatic, temperature compensated, pulse type charger.
 - ♦ High capacity, automatic, dust tight instantaneous transfer relay.
 - ♦ Low voltage disconnect prevents overdischarge of battery. Automatic brownout protection is provided.
 - ♦ Labor saving AC line latch prevents battery discharge during installation to a non-energized circuit.
- **CONTROLS:**
 - ♦ Red charger monitor LED indicates state of charge of the battery.
 - ♦ Momentary test switch for quick operational check of entire system.
 - ♦ Combination AC-ON/charge monitor LED.

- **POWER REQUIREMENTS:**
 - ♦ 120/277 Vac, 60Hz, 0.3/0.15A.

DIMENSIONS

Dimensions are approximate and subject to change.

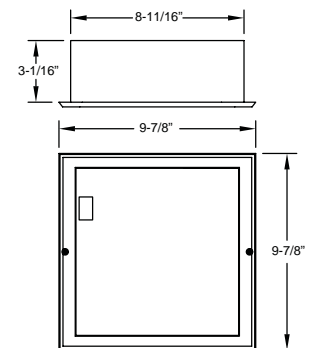



Also available
in black.

RD Series

Decorative Style Recessed Unit Equipment, 6 and 12-Volt,
Maintenance-Free, Lead-Calcium, Long Life Lead or Nickel-Cadmium Battery,
Listed to UL 924 Standards

The RD Series combines decorative styling, rugged construction and high performance for fully recessed applications. The low profile RD Series is unobtrusive, blends in well with any interior, and can be recessed in ceilings or walls.

FEATURES

- **RELIABILITY:** The RD Series has a three-year full warranty (excluding lamps).
- **CONSTRUCTION:** Construction of 20 gauge steel with an mist-white enamel finish.
- **MOUNTING:** Easily recesses into wall or ceiling. Mounting brackets included for installation in grid type suspended ceilings. Unit comes standard with adjustable bar hangers. Furnished with ELF645 heads with 6 or 12-volt lamps as specified.
- **ELECTRONICS:**
 - ♦ Automatic, temperature-compensated, pulse-type charger.
 - ♦ High capacity, automatic, dust tight instantaneous transfer relay.
 - ♦ Low voltage disconnect prevents over discharge of battery. Automatic brown out protection is provided.
 - ♦ Labor saving AC line latch prevents battery discharge during installation to a non-energized circuit.
- **CONTROLS:**
 - ♦ Red charge monitor LED indicates state of charge of the battery.
 - ♦ Pilot LED lamp indicates AC power is on.
 - ♦ Momentary test switch allows for quick operational check of entire system.
- **POWER REQUIREMENTS:**
 - ♦ 120/277 Vac, 60Hz, 0.3/0.15A.

APPLICATIONS

Ideal for use in applications that require fully-recessed, architecturally-styled units.

BATTERY

Unit comes standard with 6 or 12-volt maintenance-free, sealed Lead-Calcium battery. Nickel-Cadmium battery available as an option.

UNIT SELECTION CHART

Standard lamp is 6 or 12-volt, 12 watt

UNIT EQUIPMENT - WITH REMOTE CAPABILITY							
Sealed Maintenance-Free Battery Types	D.C. Voltage	Model Number		*Watts to 87-1/2% of rated battery voltage			
		ELF645 Lamps Heads	ELF2 Lamp Heads	1-1/2 hrs.	2 hrs.	3 hrs.	4 hrs.
Nickel Cadmium	6	2RD6C2	2RD6C2-ELF2	25	18	12	9
	12	2RD12C3	2RD12C3-ELF2	36	21	15	12
Long Life Lead	6	2RD6E2	2RD6E2-ELF2	27	19	14	10
	6	2RD6E3	2RD6E3-ELF2	36	24	17	13
	12	2RD12E3	2RD12E3-ELF2	36	24	17	13
Lead Calcium	6	2RD6M2	2RD6M2-ELF2	27	18	14	10
	6	2RD6M3	2RD6M3-ELF2	36	25	20	14
	12	2RD12M3	2RD12M3-ELF2	36	25	20	14

*National Electrical Code Specification

RD Series



LAMP HEADS

Supplied standard with ELF645, Par 36 size, high impact mar-resistant thermoplastic heads, furnished with 6 or 12-volt high intensity incandescent lamps. ELF2 heads also available upon request.

Example:

2RD12C3/LH3

2RD12C3/ELF2-LH3

ORDERING FORMAT

$\frac{2}{1}$ $\frac{RD}{2}$ $\frac{6}{3}$ $\frac{M}{4}$ $\frac{2}{5}$ $\frac{/LH4}{6}$ $\frac{-ID}{7}$

- ①— **2**.....No. of Heads (0, 1, 2)
- ②— **RD**Series
- ③— **6**.....DC Battery Backup
(6=6 Vdc, 12=12 Vdc)
- ④— **M**Battery Type (M=Lead-Calcium,
E=Long Life Lead C=Nickel-Cadmium)
- ⑤— **2**.....Capacity Indicator
(See Unit Selection Chart)
- ⑥— **/LH4**Lamp Suffix
- ⑦— **-ID**Improved Diagnostics (See Options)



DIMENSIONS

Dimensions are approximate and subject to change.

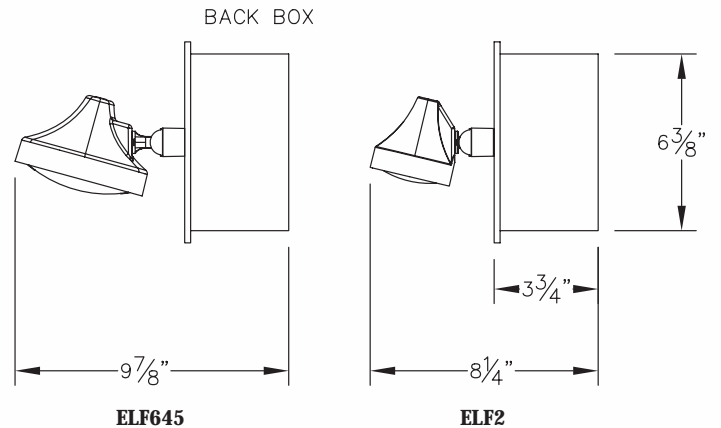
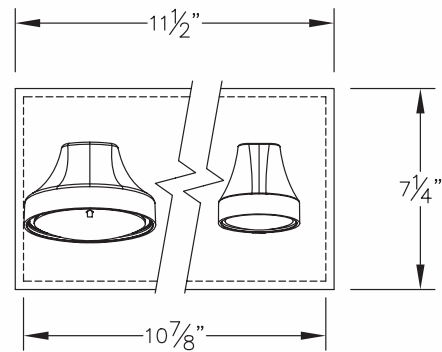

OPTIONS

(Add suffix to Model No.)

- Black Trimplate and Heads.....**-B**
- Ammeter or Voltmeter (Choose only one)**-A*** or **-V***
- Improved Diagnostics.....**-ID**
- Improved Diagnostics, Non-Audible.....**-IDNA**
- Time Delay.....**-TD****

* Not available with ID/IDNA option.

** Not required when using the ID/IDNA option.

ACCESSORIES

(Order as separate item)

- Wire Guard (ELF645 heads) **WG6-L**
- Remote Test Switch, Metal Faceplate **PSW**



TBR Series

Decorative Style Recessed Unit Equipment
6 and 12-Volt, Maintenance-Free, Lead-Calcium or
Nickel-Cadmium Batteries,
Listed to UL 924 Standards

The TBR Series combines decorative styling, rugged construction and high performance for fully recessed applications. Low profile, the TBR Series is unobtrusive, blends in well with any interior, and is designed to be recessed in grid ceilings.

FEATURES

- **RELIABILITY:** The TBR Series has a three-year full warranty (excluding lamps).
- **CONSTRUCTION:** 18-gauge, steel, finished in mist white enamel. Provision for mounting up to three heads.
- **MOUNTING:** Lay-in installation in T-bar grid ceiling. Back box has removable cover for ease of installation and full access to battery and charger.
- **ELECTRONICS:**
 - ♦ Automatic, temperature compensated, pulse type charger.
 - ♦ High capacity, automatic, dust tight instantaneous transfer relay.
 - ♦ Low voltage disconnect prevents overdischarge of battery. Automatic brownout protection is provided.
 - ♦ Labor saving AC line latch prevents battery discharge during installation to a non-energized circuit.
 - ♦ Fused output circuit.
- **CONTROLS:**
 - ♦ Red charge monitor LED indicates state of charge of the battery.
 - ♦ Amber AC-ON LED indicates AC power is on.
 - ♦ Momentary test switch allows for quick operational check of entire system.
- **POWER REQUIREMENTS:**
 - ♦ 120/277 Vac, 60Hz, 0.3/0.15A.

APPLICATIONS

For areas where a fully recessed "slim-line" ceiling unit is required. Ideal for locations where there is limited wall space and where the greater directional flexibility of ceiling-mounted heads is needed to provide a broader light distribution.

BATTERY

6 or 12-volt, long life, maintenance-free, sealed Lead-Calcium. Nickel-Cadmium available as an option.

UNIT SELECTION CHART

Volts	Model No. (Unit/Lamp Suffix)	*Watts to 87-1/2% of Nominal Battery Voltage				Standard Lamps			Cabinet
		1-1/2 Hrs.	2 Hrs.	3 Hrs.	4 Hrs.	Watts/Head	Type	Lamp Replac. No.	
6	2TBRC1/L9	27	20	14	10	9	Incand.	570.0016	S
	2TBRC2/L9	54	36	25	18	9	Incand.	570.0016	S
	2TBRC3/L9	81	48	33	24	9	Incand.	570.0016	L
12	2T12BRC2/L25	54	36	25	18	25	Incand.	570.0031	S

*National Electrical Code Specification

TBR Series



ORDERING FORMAT

$\frac{2}{1}$ **TBR** **C1** **/L9** **-ID**
 $\frac{1}{2}$ $\frac{3}{4}$ $\frac{5}{6}$

- ① — **2**No. of Heads (0, 1, 2, 3)
- ② — **TBR**Series
(TBR=6 Vdc, T12BR=12 Vdc)
- ③ — **C1**Capacity Indicator
(See Unit Selection Chart)
- ④ — **/L9**Lamp Suffix
- ⑤ — **-ID**Improved Diagnostics (See Options)

LAMP HEADS

Standard with ELF645, Par 36 size, high impact mar-resistant thermoplastic heads, furnished with high intensity incandescent lamps. ELF2 heads also available upon request.

Note: Optional lamps available.



DIMENSIONS

Dimensions are approximate and subject to change.

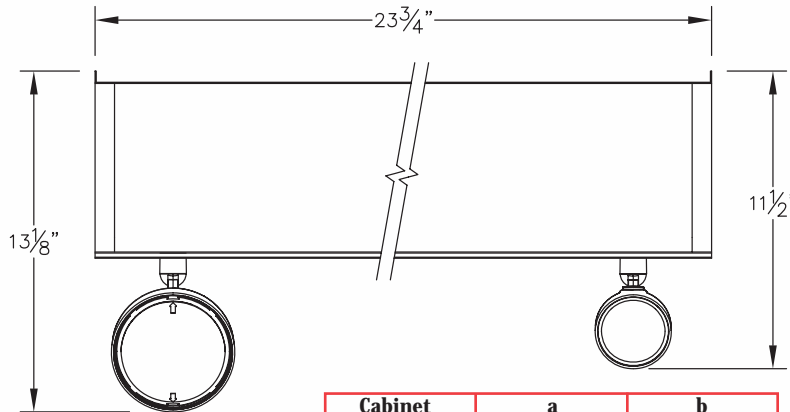

Cabinet	a	b
S	3-1/4"	4-5/8"
L	5-5/8"	7-1/8"

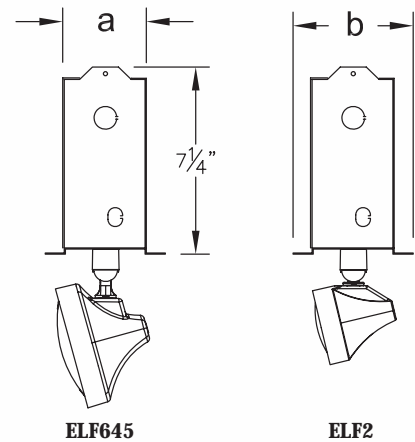

OPTIONS

(Add suffix to Model No.)

- Black Trimplate and Heads-B
- Ammeter or Voltmeter (Choose only one)-A or -V*
- Time Delay (12 min.)-TD**
- Improved Diagnostics-ID
- Improved Diagnostics, Non-Audible.....-IDNA
- Nickel-Cadmium Battery-N***

*Not available with ID/IDNA option.

**Not required when using the ID/IDNA option.

***Consult factory for NiCad wattage ratings.

ACCESSORIES

(Order as separate item)

- Remote Test Switch, Metal FaceplatePSW



MG Series

Industrial/Commercial Unit Equipment, 6 and 12-Volt,
Maintenance-Free, Lead-Calcium or Nickel-Cadmium Battery,
Listed to UL 924 Standards

The MG Series is an excellent combination of economy, quality and versatility. Its compact, all-metal housing is offered in a wide variety of battery choices and wattages. The MG Series comes with our highly reliable pulse type charger. Improved Diagnostics are available as an option.

FEATURES

- **RELIABILITY:** The MG Series comes complete with a 3-year full warranty (excluding lamps).
- **HOUSING:** Constructed of 20 gauge steel with a mist white enamel finish. Hinged cabinet door for easy access. Furnished standard with two Par 36 size, high impact, mar resistant, thermoplastic head with one 12 watt lamp per head.
- **MOUNTING:** Conduit knockouts and rear keyhole mounting slots are provided.
- **ELECTRONICS:**
 - ♦ Automatic, temperature compensated, pulse type charger.
 - ♦ High capacity, automatic, dust-tight instantaneous transfer relay.
 - ♦ Low voltage disconnect prevents overdischarge of battery. Automatic brownout protection is provided.
 - ♦ Labor saving AC line latch prevents battery discharge during installation to a non-energized circuit.
- **CONTROLS:**
 - ♦ Red charge monitor LED indicates state of charge of the battery.
 - ♦ Orange AC-ON LED indicates AC power is on.
 - ♦ Momentary test switch allows for quick operational check of entire system.
- **POWER REQUIREMENTS:**
 - ♦ 120/277 Vac, 60Hz, 0.3/0.15A.

APPLICATION

Our compact housing design meets most requirements for moderate loads. This unit is reliable, economical and can be used in all public areas and most commercial applications.

BATTERY

6 or 12 volt, sealed maintenance-free Lead-Calcium or Nickel-Cadmium batteries.

UNIT SELECTION CHART

Sealed Maintenance-Free Battery Types	Volts	Model No. (Unit/Lamp Suffix)	*Watts to 87-1/2% of Nominal Battery Voltage				Cabinet Size
			1-1/2 Hrs	2 Hrs	3 Hrs	4 Hrs	
Lead-Calcium	6	2MG1/LH6-M	27	18	14	-	S
		2MG2/LH6-M	54	37	28	21	L
	12	2M12G1/LH3-M	36	25	20	14	S
		2M12G2/LH3-M	54	37	28	21	L
Nickel-Cadmium	6	2MN1/LH6-M	25	18	12	-	S
	12	2M12N1/LH3-M	36	21	15	12	S
		2M12N2/LH3-M	50	36	25	18	S

12W Bi-Pin Halogen, ELF645 Heads Standard
*National Electrical Code Specification

MG Series



ORDERING FORMAT

$\frac{2}{1}$ $\frac{MG}{2}$ $\frac{2}{3}$ $\frac{/LH6}{4}$ $\frac{-M}{5}$ $\frac{-V}{6}$

- ①— **2**No. of Heads (0, 1, 2, 3)
- ②— **MG**Series/DC Voltage
(MG=6 Vdc, M12G=12 Vdc)
- ③— **2**Capacity Indicator
(See Unit Selection Chart)
- ④— **/LH6**Lamp Suffix
- ⑤— **-M**Standard Mist White Enamel Finish
- ⑥— **-V**Voltmeter (See Options)

LAMP HEADS

Standard with ELF645, Par 36 size, high impact mar-resistant thermoplastic heads, furnished with 12W high intensity halogen lamps. ELF2 heads also available upon request.

Note: Optional lamps available.

DIMENSIONS

Dimensions are approximate and subject to change.

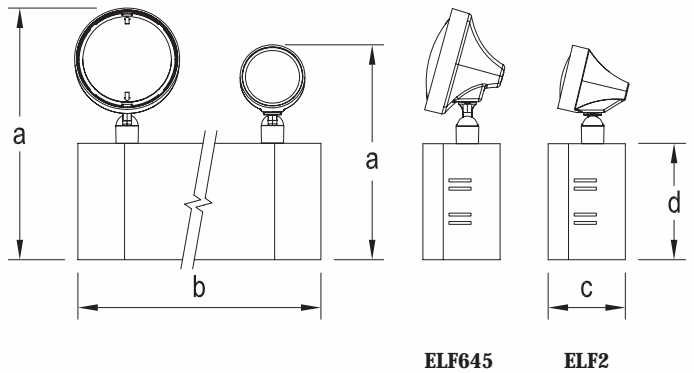

Cabinet	a	b	c	d
S	11-3/8"// 9-3/4"	11"	3-1/2"	5-1/4"
L	12-3/8"//10-3/4"	12-1/2"	4"	6-1/4"



OPTIONS

(Add suffix to Model No.)

- Black Housing and Heads (Replace -M by)**-B**
- Ammeter or Voltmeter (Choose only one).....**-A or -V***
- Disconnect Switch.....**-DS*****
- Improved Diagnostics.....**-ID****
- Improved Diagnostics, Non-Audible.....**-IDNA**
- Time Delay (12 minutes).....**-TD*****
- Tamper Proof.....**-TP**
- Front Mounted Heads (for Low Ceilings).....**-FM**
- 3-wire Cord & Plug.....**-3CP**
- 3-wire Cord & Plug (277V).....**-3CP-277**

*Not available with ID/IDNA option.

**Not available with NiCad Battery

***Not required when using the ID/IDNA option.

ACCESSORIES

(Order as separate item)

- Mounting Platform.....**MP-PQA**
- Wire Guard (S Cabinet).....**WG1-L**
- Wire Guard (L Cabinet).....**WG2-L**
- Wire Guard (Front Mounted Heads).....**WG10-L**
- Vandal Resistant Cover.....**CPS**
- Vandal Resistant NEMA-4X Cover.....**CPS-4X**



PG, P12G Series

Industrial/Commercial Unit Equipment
6 or 12-Volt, Maintenance-Free Lead-Calcium Battery
Listed to UL 924 Standards

The PG, P12G Series is a traditionally-styled, multi-purpose emergency lighting unit that offers reliability, versatility, performance and cost-efficiency in an aesthetically-pleasing design.

FEATURES

- **RELIABILITY:** The PG, P12G Series has a three-year full warranty (excluding lamps).
- **HOUSING:** Heavy duty steel case with front access panel and mist white enamel finish.
- **MOUNTING:** Conduit knockouts and rear keyhole mounting slots are provided.
- **ELECTRONICS:**
 - ▶ Automatic, temperature-compensated, pulse-type charger.
 - ▶ High capacity, automatic, dust tight instantaneous transfer relay.
 - ▶ Labor-saving AC line latch prevents battery discharge during installation to a non-energized circuit.
 - ▶ Low voltage disconnect prevents over discharge of battery. Automatic brownout protection is provided.
 - ▶ Fused output circuits (PG2, P12G1).
- **CONTROLS:**
 - ▶ Red charger monitor LED indicates state of charge of the battery.
 - ▶ Amber AC-ON LED indicates AC power is on.
 - ▶ Momentary test switch allows for quick operational check of entire system.
- **POWER REQUIREMENTS:**
 - ▶ 120/277 Vac, 60Hz, 0.3/0.15A.

APPLICATIONS

Designed to meet requirements for moderate loads, the PG, P12G Series is a reliable, economical choice for most public, commercial and industrial areas.

BATTERY

6 or 12-Volt, maintenance-free sealed Lead-Calcium. Battery capacities meet the 90 minute required run time or extended run times based on lamp load.

UNIT SELECTION CHART

Volts	Model No. (Unit/Lamp Suffix)	*Watts to 87-1/2% of Nominal Battery Voltage			
		1-1/2 Hrs	2 Hrs	3 Hrs	4 Hrs
6	2PG1-NY/L9-M	27	20	14	-
	2PG2-NY/L9-M	54	36	27	18
12	2P12G1-NY/L9-M	54	36	27	18

*National Electrical Code Specification

PG, P12G Series



ORDERING FORMAT

- | | | | | | | |
|----------|-----------|----------|------------|------------|-----------|------------|
| 2 | PG | 1 | -NY | /L9 | -M | -ID |
| ① | ② | ③ | ④ | ⑤ | ⑥ | ⑦ |
- ① — **2**No. of Heads (0, 1, 2, 3)
 ② — **PG**Series/DC Voltage
 (PG=6 Vdc, P12G= 12 Vdc)
 ③ — **1**Capacity Indicator
 (See Unit Selection Chart)
 ④ — **-NY**.....New York City Spec.
 ⑤ — **/L9**.....Lamp Suffix
 ⑥ — **-M**Standard Mist White Finish
 ⑦ — **-ID**Improved Diagnostics (See Options)

LAMP HEADS

Standard with ELF645, Par 36 size, high impact mar-resistant thermoplastic heads, furnished with high intensity incandescent lamps. ELF2 heads also available upon request.

Note: Optional lamps available.

DIMENSIONS

Dimensions are approximate and subject to change.

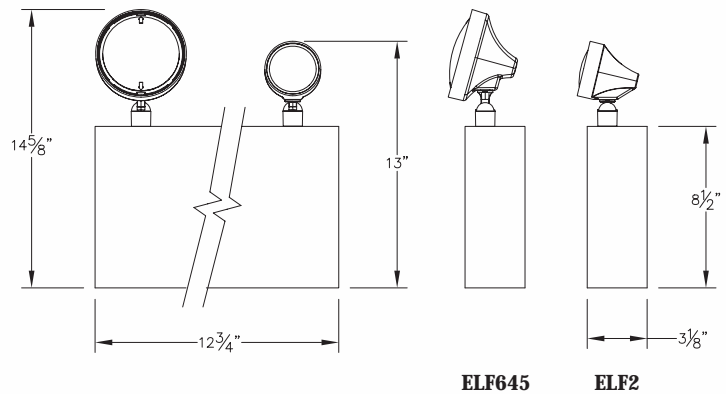

OPTIONS

(Add suffix to Model No.)

- Black Housing and Heads (Replace "-M" by) **-B**
- Voltmeter **-V***
- Disconnect Switch **-DS****
- Improved Diagnostics **-ID**
- Improved Diagnostics (Non-Audible) **-IDNA**
- Time Delay **-TD****
- Tamper Proof **-TP**
- 3-Wire Cord and Plug **-3CP**
- 3-Wire Cord and Plug (277V) **-3CP-277**

*Not available with diagnostics.

**Not required with the ID/IDNA option.

ACCESSORIES

(Order as separate item)

- Wire Guard **WG2-L**
- Mounting Platform **MP-PQA**



PN, P12N Series

Industrial/Commercial Unit Equipment 6 or 12-Volt,
Maintenance-Free, Nickel-Cadmium Battery
Listed to UL 924 Standards

The PN, P12N Series is a traditionally styled, high performance unit. Long-life Nickel-Cadmium batteries are maintenance-free and designed specifically for environments where lighting units may be exposed to fluctuations in temperature.

FEATURES

- **RELIABILITY:** The PN, P12N Series has a three-year full warranty (excluding lamps).
- **HOUSING:** Heavy duty steel case with front access panel and mist white enamel finish.
- **MOUNTING:** Conduit knockouts and rear keyhole mounting slots are provided.
- **ELECTRONICS:**
 - ▶ Automatic, temperature-compensated, pulse-type charger.
 - ▶ High capacity, automatic, dust-tight instantaneous transfer relay.
 - ▶ Labor-saving AC line latch prevents battery discharge during installation to a non-energized circuit.
 - ▶ Automatic brownout protection is provided.
 - ▶ Fused output circuit.
- **CONTROLS:**
 - ▶ Red charger monitor LED indicates state of charge of the battery.
 - ▶ Amber AC-ON LED indicates AC power is on.
 - ▶ Momentary test switch allows for quick operational check of entire system.
- **POWER REQUIREMENTS:**
 - ▶ 120/277 Vac, 60Hz, 0.3/0.15A.

APPLICATIONS

This series is offered where an attractive conventional emergency lighting unit is required. These units are reliable yet economic for all public, commercial and industrial areas. Recommended where the long-life and maintenance-free features of sealed Nickel-Cadmium batteries are required.

BATTERY

Nickel-Cadmium batteries outperform lead acid batteries in dramatic ambient temperature fluctuations. These units are equipped with 6 or 12-volt, long life, maintenance-free sealed Nickel-Cadmium.

UNIT SELECTION CHART

**At Additional Cost

Volts	Model No. (Unit/Lamp Suffix)	*Watts to 87-1/2% of Nominal Battery Voltage				Standard Lamps			Cabinet
		1-1/2 Hrs.	2 Hrs.	3 Hrs.	4 Hrs.	Watts/Head	Type Replace. No.	Lamp	
6	2PN1/L9-M	25	20	14	10	9	Incand.	570.0016	A
	2P12N1/L12-M	50	36	25	18	12	Incand.	570.0028	A
12	2P12N2/L12-M	72	60	50	36	12	Incand.	570.0028	B
	Optional Lamps**								
6	2PN1/LH6-M	25	20	14	10	12	Bi-Pin Halogen	580.0011	A
12	2P12N1/LH3-M	50	36	25	18	12	Bi-Pin Halogen	580.0015	A
	2P12N2/LH3-M	72	60	50	36	12	Bi-Pin Halogen	580.0015	B

*National Electrical Code Specification

PN, P12N Series



ORDERING FORMAT

- | | | | | | |
|--------------------------------|---|---|------------------|---|------------------------------|
| ① | ② | ③ | ④ | ⑤ | ⑥ |
| 2 | P12N | 2 | /LH3 | -M | -V |
| ① — 2 | ② — P12N | ③ — 2 | ④ — /LH3 | ⑤ — -M | ⑥ — -V |
|No. of Heads (0, 1, 2, 3) |Series/DC Voltage
(PN = 6 Vdc, P12N = 12 Vdc) |Capacity Indicator
(See Unit Selection Chart) |Lamp Suffix |Standard Mist White
Enamel Finish |Voltmeter (See Options) |

LAMP HEADS

Standard with ELF645, Par 36 size, high impact mar-resistant thermoplastic heads, furnished with high intensity incandescent lamps. ELF2 heads also available upon request.

Note: Optional lamps available.

DIMENSIONS

Dimensions are approximate and subject to change.

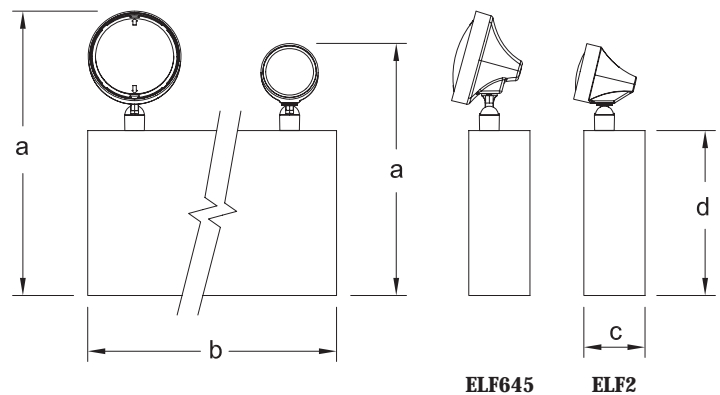

Cabinet	a	b	c	d
A	14-5/8"//13	12-3/4"	3-1/8"	8-1/2"
B	16-3/8"//14-3/4"	16-1/8"	5-7/16"	10-1/4"



OPTIONS

(Add suffix to Model No.)

- Black Housing and Heads (Replace "-M" by) **-B**
- Voltmeter **-V***
- Ammeter **-A***
- Disconnect Switch **-DS****
- Improved Diagnostics, Non-Audible **-IDNA**
- Time Delay (12 min.) **-TD****
- Tamper Proof **-TP**
- 3-Wire Cord and Plug **-3CP**
- 3-Wire Cord and Plug (277V) **-3CP-277**

*Not available with IDNA.
**Not required with IDNA Option.

ACCESSORIES

(Order as separate item)

- Wire Guard (A Cabinet) **WG2-L**
- Wire Guard (B Cabinet) **WG3-L**
- Mounting Platform **MP-PQA**



PQ, P12Q Series

Industrial/Commercial Unit Equipment, 6 and 12-Volt,
Maintenance-Free, Lead-Calcium Battery
Listed to UL 924 Standards

The PQ , P12Q Series is a traditionally styled battery unit with high capacity, maintenance-free batteries — the perfect combination of function and performance for most industrial and commercial environments.

FEATURES

- **RELIABILITY:** The PQ, P12Q Series has a three-year full warranty (excluding lamps).
- **HOUSING:** Heavy duty steel case with front access panel has mist white enamel finish.
- **MOUNTING:** Conduit knockouts and rear keyhole mounting slots are provided.
- **ELECTRONICS:**
 - ♦ Automatic, temperature compensated, pulse type charger.
 - ♦ High capacity, automatic, dust tight instantaneous transfer relay.
 - ♦ Low voltage disconnect prevents overdischarge of battery. Automatic brownout protection is provided.
 - ♦ Labor saving AC line latch prevents battery discharge during installation to a non-energized circuit.
 - ♦ Fused output circuit.
- **CONTROLS:**
 - ♦ Red charge monitor LED indicates state of charge of the battery.
 - ♦ Amber AC-ON LED indicates AC power is on.
 - ♦ Momentary test switch allows for quick operational check of entire system.
- **POWER REQUIREMENTS:**
 - ♦ 120/277 Vac, 60Hz, 0.3/0.15A.

APPLICATIONS

Industrial, institutional and commercial environments where remote capability or extended operating times are required.

BATTERY

6 or 12-volt, maintenance-free sealed Lead-Calcium.

UNIT SELECTION CHART

**At Additional Cost

Volts	Model No. (Unit/Lamp Suffix)	*Watts to 87-1/2% of Nominal Battery Voltage				Standard Lamps			Cabinet
		1-1/2 Hrs.	2 Hrs.	3 Hrs.	4 Hrs.	Watts/Head	Type	Lamp Replace. No.	
6	2PQ2/L25-M	100	75	50	36	25	Incand.	570.0038	B
	2PQ3/L25-M	200	150	100	72	25	Incand.	570.0038	C
12	2P12Q1/L25-M	100	75	50	36	25	Incand.	570.0031	B
	2P12Q2/L25-M	200	150	100	72	25	Incand.	570.0031	C
Optional Lamps**									
6	2PQ2/LH6-M	100	75	50	36	12	Bi-Pin Halogen	580.0011	B
	2PQ3/LH6-M	200	150	100	72	12	Bi-Pin Halogen	580.0011	C
12	2P12Q1/LH3-M	100	75	50	36	12	Bi-Pin Halogen	580.0015	B
	2P12Q2/LH3-M	200	150	100	72	12	Bi-Pin Halogen	580.0015	C

*National Electrical Code Specification

PQ, P12Q Series



ORDERING FORMAT

- | | | | | | | |
|----|---------------|----------------|---------------|------------------|----------------|----------------|
| | $\frac{2}{1}$ | $\frac{PQ}{2}$ | $\frac{2}{3}$ | $\frac{/L25}{4}$ | $\frac{-M}{5}$ | $\frac{-V}{6}$ |
| ①— | 2 | | | | | |
| ②— | PQ | | | | | |
| ③— | 2 | | | | | |
| ④— | /L25 | | | | | |
| ⑤— | -M | | | | | |
| ⑥— | -V | | | | | |
- ①— 2No. of Heads (0, 1, 2, 3)
 ②— PQSeries/DC Voltage
 (PQ = 6 Vdc, P12Q = 12 Vdc)
 ③— 2Capacity Indicator
 (See Unit Selection Chart)
 ④— /L25Lamp Suffix
 ⑤— -MStandard Mist White Enamel Finish
 ⑥— -VVoltmeter (See Options)

LAMP HEADS

Standard with ELF645, Par 36 size, high impact mar-resistant thermoplastic heads, furnished with high intensity incandescent lamps. ELF2 heads also available upon request.

Note: Optional lamps available.

DIMENSIONS

Dimensions are approximate and subject to change.

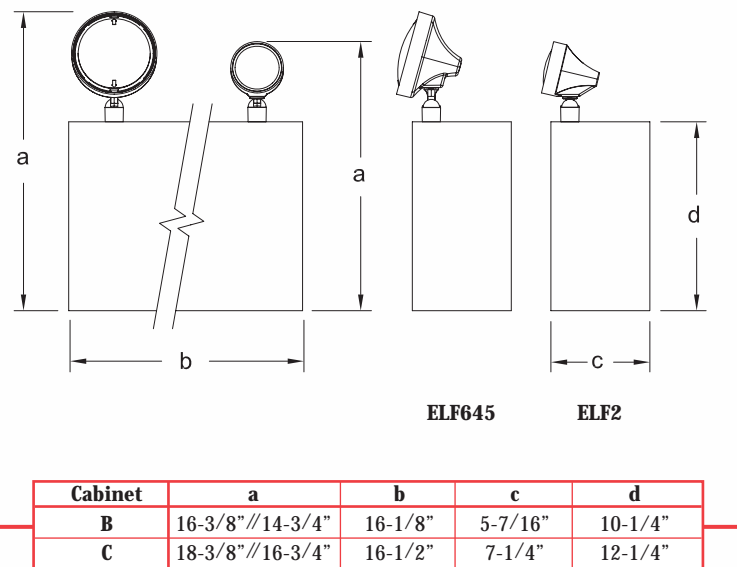

OPTIONS

(Add suffix to Model No.)

- Black Housing and Heads (Replace "-M" by) -B
- Voltmeter -V*
- Ammeter -A*
- Improved Diagnostics -ID
- Improved Diagnostics, Non-Audible -IDNA
- Time delay (12 min.) -TD**
- Tamper Proof -TP
- School Commission Authority -SCA***
- 3-Wire Cord & Plug -3CP
- 3-Wire Cord & Plug (277V) -3CP-277

*Voltmeter and ammeter not available with the ID/IDNA option.
 **Not required with the ID/IDNA option.
 ***School Construction Authority approved with the ELF622 heads.

ACCESSORIES

(Order as separate item)

- Wire Guard **WG3-L**
- Mounting Platform (C Cabinet) **MP-PQB**
- Mounting Platform (B Cabinet) **MP-PQA**



S12E Series

Industrial/Commercial Unit Equipment
12-Volt, Maintenance-Free, Lead-Calcium Battery
Listed to UL 924 Standards

The S12E Series offers high performance, reliability and flexibility. Its high capacity, maintenance-free battery offers extended illumination and multiple remote capability.

FEATURES

- **RELIABILITY:** The S12E Series has a three-year full warranty (excluding lamps and pilot lights).
- **HOUSING:** Heavy duty steel case with front access panel and gray enamel finish.
- **MOUNTING:** Conduit knockouts and rear keyhole mounting slots are provided. Mounting platform or bracket available.
- **ELECTRONICS:**
 - ▶ Automatic, temperature compensated, pulse type charger.
 - ▶ High capacity, automatic, dust tight instantaneous transfer relay.
 - ▶ Low voltage disconnect prevents overdischarge of battery. Automatic brownout protection is provided.
 - ▶ Labor saving AC line latch prevents battery discharge during installation to a non-energized circuit.
 - ▶ Two separately fused output circuits.
- **CONTROLS:**
 - ▶ Red charge monitor LED indicates state of charge of the battery.
 - ▶ Orange AC-ON LED indicates AC power is on.
 - ▶ Momentary test switch allows for quick operational check of entire system.
- **POWER REQUIREMENTS:**
 - ▶ 120/277 Vac, 60Hz, 0.3/0.15A.

APPLICATIONS

Designed for applications requiring high-capacity, maintenance-free batteries, multiple remote capability or extended operating times. The 12-volt battery allows for longer remote wiring runs without voltage drop.

BATTERY

12-volt maintenance-free sealed lead calcium.

ORDERING FORMAT

$\frac{2}{1}$ **S12E** $\frac{4}{3}$ /L25 $\frac{-G}{5}$ $\frac{-V}{6}$

- ① — **2 (0, 1, 2, 3)**....Number of Heads
- ② — **S12E**Series
- ③ — **4**Capacity Indicator
- ④ — **/L25**.....Lamp Suffix
- ⑤ — **-G**Gray Enamel Finish
- ⑥ — **-V**Option (Voltmeter)

LAMP HEADS

PAR 36 size, high impact mar-resistant thermoplastic heads, furnished with high intensity incandescent lamps.

OPTIONS (Add suffix to Model No.)

Voltmeter (Not available with diagnostics) .. -V
 Ammeter (Not available with diagnostics).... -A
 Disconnect Switch -DS**
 Time Delay (12 min.) -TD**
 Improved Diagnostics -ID*
 Improved Diagnostics Non-Audible.. -IDNA*
 3-wire Cord & Plug.....-3CP
 3-wire Cord & Plug (277V)-3CP-277
 Mist White Color (Replace -G by)-M

*S12E4 only
**Not required with ID/IDNA option.

ACCESSORIES (Order as separate item)

Guard (S12E4) **WG3-L**
 Guard (S12E 5/S12E6)..... **WG4-L**
 Mounting Platform (S12E4) **MP-A**
 Mounting Platform (S12E5/6)..... **MP12-LA**
 Mounting Bracket (S12E4) **MB-A**



UNIT SELECTION CHART

Volts	Model No. (Unit/Lamp Suffix)	*Watts to 87-1/2% of Nominal Battery Voltage				Standard Lamps			Cabinet
		1-1/2 Hrs.	2 Hrs.	3 Hrs.	4 Hrs.	Watts / Head	Type	Lamp Replace. No.	
12	2S12E4/L25-G	200	150	107	85	25	Incand.	570.0031	C
	2S12E5/L25-G	300	225	165	127	25	Incand.	570.0031	D
	2S12E6/L25-G	400	300	214	170	25	Incand.	570.0031	D

*National Electrical Code Specification

DIMENSIONS

Dimensions are approximate and subject to change.

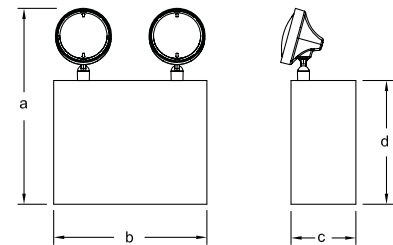

Cabinet	a	b	c	d
C	18-3/8"	16-1/2"	7-1/4"	12-1/4"
D	18-3/8"	27"	7-1/4"	12-1/4"

SL, S12L Series

Industrial/Commercial Unit Equipment
6 or 12-Volt, Wet, Refillable Lead Acid Battery
Listed to UL 924 Standards

The SL, S12L Series features conventional styling in a high capacity, lead acid battery unit that delivers extended illumination times.



APPLICATIONS

Ideal for all industrial, commercial and institutional environments requiring extended illumination time, high capacity and remote capability.

BATTERY

6 or 12-volt Long Life wet refillable Lead acid battery in transparent plastic containers with visible gravity indicator.

ORDERING FORMAT

- 2** **SL** **9** **/L25** **-G** **-V**
 ① ② ③ ④ ⑤ ⑥
- ①— **2 (0, 1, 2, 3)**Number of Heads
 ②— **SL**.....Series
 ③— **9**Capacity Indicator
 ④— **/L25**Lamp Suffix
 ⑤— **-G**.....Gray Enamel Finish
 ⑥— **-V**.....Option (Voltmeter)

LAMP HEADS

PAR 36 size, high impact mar-resistant thermoplastic heads, furnished with high intensity incandescent lamps.

OPTIONS (Add suffix to Model No.)

- Voltmeter -V
 Ammeter -A
 Disconnect Switch -DS**
 Time Delay (12 min.) -TD**
 Improved Diagnostics -ID*
 Improved Diagnostics Non-Audible -IDNA*
 3-wire Cord & Plug..... -3CP
 3-wire Cord & Plug (277V) -3CP-277
 Mist White Color (Replace -G by) -M

*2SL3 only
*Not required with ID/IDNA option

ACCESSORIES (Order as separate item)

- Mounting Platform (SL)MP-A
 Mounting Bracket (6-Volt models only) ..MB-A
 Guard (Model SL) WG3-L
 Guard (Model S12L) WG4-L
 Mounting Platform (S12L)MP12-LA



FEATURES

- **RELIABILITY:** The SL, S12L Series has a three-year full warranty (excluding lamps and pilot lights).
- **HOUSING:** Heavy duty steel case with front access panel has gray enamel finish.
- **MOUNTING:** Conduit knockouts and rear keyhole mounting slots are provided.
- **ELECTRONICS:**
 - ♦ Automatic, temperature compensated, pulse type charger.
 - ♦ High capacity, automatic, dust tight instantaneous transfer relay.
 - ♦ Low voltage disconnect prevents overdischarge of battery. Automatic brownout protection is provided.
 - ♦ Labor saving AC line latch prevents battery discharge during installation to a non-energized circuit.
 - ♦ Two separately fused output circuits.
- **CONTROLS:**
 - ♦ Red charge monitor LED indicates state of charge of the battery.
 - ♦ Orange AC-ON LED indicates AC power is on.
 - ♦ Momentary test switch allows for quick operational check of entire system.
- **POWER REQUIREMENTS:**
 - ♦ 120/277 Vac, 60Hz, 0.3/0.15A.

UNIT SELECTION CHART

Volts	Model No. (Unit/Lamp Suffix)	*Watts to 87-1/2% of Nominal Battery Voltage				Standard Lamps			Cabinet
		1-1/2 Hrs.	2 Hrs.	3 Hrs.	4 Hrs.	Watts/Head	Type	Lamp Replace. No.	
6	25L3/L25-G	100	80	50	40	25	Incand.	570.0038	C
	25L9/L25-G	200	150	125	100	25	Incand.	570.0038	C
	25L105/L25-G	200	200	175	125	25	Incand.	570.0038	C
12	2512L9/L25-G	350	300	250	200	25	Incand.	570.0031	D
	2512L105/L25-G	400	400	300	250	25	Incand.	570.0031	D

*National Electrical Code Specification

DIMENSIONS

Dimensions are approximate and subject to change.

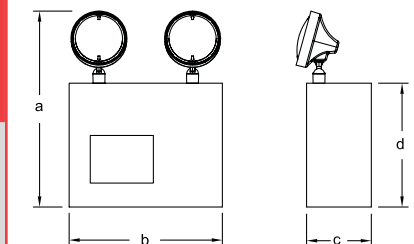

Cabinet	a	b	c	d
C	18-3/8"	16-1/2"	7-1/4"	12-1/4"
D	18-3/8"	27"	7-1/4"	12-1/4"



SN, S12N Series

Industrial/Commercial Unit Equipment
6 or 12-Volt, Wet, Refillable Nickel-Cadmium Battery
Listed to UL 924 Standards

The SN, S12N Series offer the highest and widest in capacity as well as the highest battery reliability. Able to withstand temperature fluctuations and provide extended illumination times, these units can also be connected to remote heads or exits.

FEATURES

- **RELIABILITY:** The SN, S12N Series has a three-year full warranty (excluding lamps).
- **HOUSING:** Heavy duty steel case with front access panel and gray enamel finish.
- **MOUNTING:** Conduit knockouts and rear keyhole mounting slots are provided. Mounting platform or bracket available.
- **ELECTRONICS:**
 - ♦ Automatic, temperature-compensated, pulse-type charger.
 - ♦ High capacity, automatic, dust-tight instantaneous transfer relay.
 - ♦ Labor-saving AC line latch prevents battery discharge during installation to a non-energized circuit.
 - ♦ Automatic brownout protection is provided.
 - ♦ Two separately fused output circuits.
- **CONTROLS:**
 - ♦ Red charger monitor LED indicates state of charge of the battery.
 - ♦ Amber AC-ON LED indicates AC power is on.
 - ♦ Momentary test switch allows for quick operational check of entire system.
- **POWER REQUIREMENTS:**
 - ♦ 120/277 Vac, 60Hz, 0.3/0.15A.

APPLICATIONS

Excellent high capacity units ideal where extended burn times may be required, and/or remote fixtures or exits will be connected. Unit offers special advantages of the long life wet, refillable Nickel-Cadmium battery including excellent recharging capability, and superior performance over extended temperature ranges.

BATTERY

6 or 12-volt high performance Nickel-Cadmium battery in translucent plastic cells.

LAMPS HEADS

PAR 36 size, high impact mar-resistant thermoplastic heads, furnished with high intensity incandescent lamps.

Note: Optional lamps available.

ORDERING FORMAT

- $\frac{2}{1}$ $\frac{SN}{2}$ $\frac{4}{3}$ $\frac{/L25}{4}$ $\frac{-G}{5}$ $\frac{-V}{6}$
- ① — 2 (0, 1, 2, 3) ..No. of Heads
 - ② — SNSeries
 - ③ — 4Capacity Indicator
 - ④ — /L25Lamp Suffix
 - ⑤ — -GMist White Enamel Finish
 - ⑥ — -VOptions (Voltmeter)

OPTIONS (Add suffix to Model No.)

- Voltmeter..... -V
- Ammeter -A
- Disconnect Switch..... -DS
- Time Delay (12 min.) -TD
- 3-wire Cord & Plug -3CP
- 3-wire Cord & Plug (277V) -3CP-277
- Mist White Color (Replace "-G" by)..... -M

ACCESSORIES

(Order as separate item)

- Guard (Model SN) WG3-L
- Guard (Model S12N) WG4-L
- Mounting Platform (Model SN) MP-A
- Mounting Platform (Model S12N) .. MP12-LA
- Mounting Bracket (Model SN only) MB-A

UNIT SELECTION CHART

Volts	Model No. (Unit/Lamp Suffix)	*Watts to 87-1/2% of Nominal Battery Voltage				Standard Lamps			Cabinet
		1-1/2 Hrs.	2 Hrs.	3 Hrs.	4 Hrs.	Watts/Head	Type	Lamp Replace. No.	
6	2SN2/L25-G	50	45	25	18	25	Incand.	570.0038	C
	2SN3/L25-G	70	60	35	25	25	Incand.	570.0038	C
	2SN4/L25-G	100	80	50	35	25	Incand.	570.0038	C
	2SN6/L25-G	130	105	70	50	25	Incand.	570.0038	C
	2SN7/L25-G	160	130	80	60	25	Incand.	570.0038	C
12	2S12N2/L25-G	100	90	64	50	25	Incand.	570.0031	D
	2S12N3/L25-G	140	130	90	70	25	Incand.	570.0031	D
	2S12N4/L25-G	200	166	120	90	25	Incand.	570.0031	D
	2S12N6/L25-G	260	210	150	112	25	Incand.	570.0031	D
	2S12N7/L25-G	320	278	200	150	25	Incand.	570.0031	D

*National Electrical Code Specification

DIMENSIONS

Dimensions are approximate and subject to change.

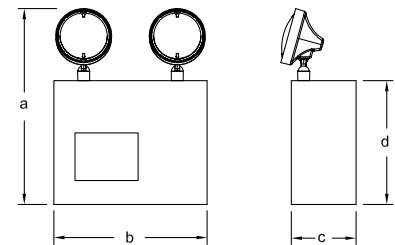

Cabinet	a	b	c	d
C	18-3/8"	16-1/2"	7-1/4"	12-1/4"
D	18-3/8"	27"	7-1/4"	12-1/4"



FF-AM Series

Self-Powered Fluorescent Fixture
Sealed Nickel-Cadmium Battery
Listed to UL 924 Standards



The FF-AM Series is a tamper- and vandalproof fluorescent fixture that combines the functions of normal area lighting and emergency lighting in one fixture.

APPLICATIONS

A virtually indestructible luminaire for areas subject to severe abuse. Suitable for schools, public restrooms, outdoor exits/entrances, terminals and other heavily accessed areas.

BATTERY

Long life, maintenance-free sealed Nickel-Cadmium.

ORDERING FORMAT

FF-AM -2 -20 -120
① ② ③ ④

- ① — FF-AM.....Series
- ② — -2No. of Lamp Sockets
- ③ — -20Wattage of Lamps
- ④ — -120Voltage of Fixture

LAMPS

Available with sockets for: one (1) 20 watt, one (1) 34 watt, two (2) 20 watt or two (2) 34 watt T12 lamps, or one (1) or two (2) 32-watt T8 lamps supplied by others.



UNIT SELECTION CHART

MODEL	A	B	C	Lamp Type
FF-AM-1-20-120 FF-AM-1-20-277 FF-AM-2-20-120 FF-AM-2-20-277	24-1/4"	4-1/2"	4-3/8"	F20T12
FF-AM-1-34-120 FF-AM-1-34-277 FF-AM-2-34-120 FF-AM-2-34-277	48-1/4"	4-1/2"	4-3/8"	F34T12
FF-AM-1-32-120 FF-AM-1-32-277 FF-AM-2-32-120 FF-AM-2-32-277	48-1/4"	4-1/2"	4-3/8"	F32T8

DIMENSIONS

Dimensions are approximate and subject to change.

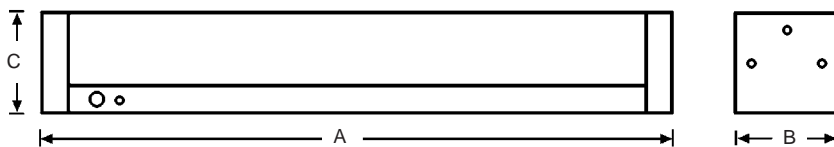

FEATURES

- **RELIABILITY:** The FF-AM Series has a three-year full warranty (excluding lamps and pilot lights).
- **HOUSING:**
 - ♦ Housing is constructed of 16 gauge steel and secured with tamper-proof screws. Tamper-proof screw driver bit is included.
 - ♦ Completely self-contained and maintenance-free.
 - ♦ Surface mounting.
- **DIFFUSER:** One piece injection molded .125" UV stabilized unbreakable polycarbonate lens. Features a prismatic pattern on the bottom and linear refractive sides for brightness control and 180° uniform light distribution.
- **BATTERY PACK:** High efficiency battery pack, complete with inverter charger and battery provides emergency power to one lamp in fixture for 90 minutes.
- **ELECTRONICS:**
 - ♦ Fully automatic solid-state charger.
 - ♦ Low voltage disconnect prevents overdischarge of battery.
- **CONTROLS:**
 - ♦ Pilot light and test switch.
- **POWER REQUIREMENTS:**
 - ♦ Battery pack is dual voltage 120/277 volt AC input supply. Voltage for fluorescent fixture must be specified 120 or 277V and is indicated by complete model number.



AM Series

Fluorescent Power Packs
Sealed Nickel-Cadmium Battery
Listed to UL 924 Standards

The AM Series fluorescent power packs are a cost-efficient solution for conversion of new or existing fluorescent fixtures into emergency lighting units.

FEATURES

- **RELIABILITY:** The AM Series power packs have a 3-5 year full warranty. Please see chart on page 25.
- **HOUSING:** Unit components are housed in a compact ballast-size case.
- **INSTALLATION:**
 - ▶ Installation is simple and cost-efficient. Unit mounts easily inside or on top of fixture using wire end caps.
 - ▶ Can be wired to operate with switched, unswitched or normally off fixtures without affecting normal operation.
 - ▶ Can be used with Circline, U-shaped and energy-saving lamps. For VHO, SHO and Power Groove® lamps, use the AM7, AM10 or AM12.
 - ▶ Power Groove is a registered trademark of GE.
 - ▶ Compatible with standard, energy-saving, dimming and electronic AC ballasts.
- **ELECTRONICS:**
 - ▶ Fully automatic solid state charger.
 - ▶ Automatic transfer relay energizes lamp instantaneously upon failure of normal AC supply.
 - ▶ Low voltage disconnect prevents overdischarge of battery.
- **CONTROLS:**
 - ▶ External test switch and pilot light.
- **POWER REQUIREMENTS:**
 - ▶ 120/277 Vac, 60Hz, 0.3/0.15A.

APPLICATIONS

The AM Series power packs are ideally suited for any commercial application where conversion of fluorescent fixtures to emergency lighting is a cost-efficient alternative.

BATTERY

Long life, maintenance-free, sealed Nickel-Cadmium.

ACCESSORIES

(Order as separate item)

Remote test switch and pilot light.....	PSW
Wire end caps for AM32.....	EC6
Wire end caps for AM10.....	EC10



Listed

AM Series



DIMENSIONS

Dimensions are approximate and subject to change.

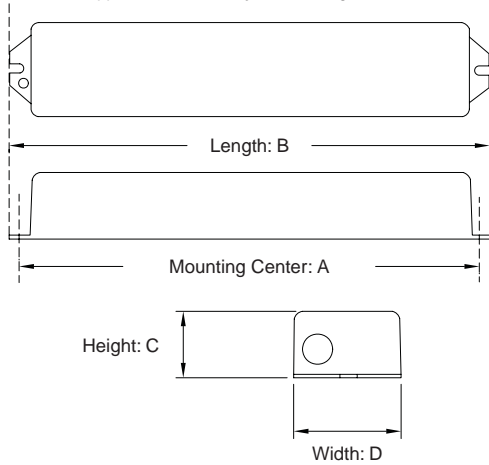

Model No.	DIMENSIONS			
	A	B	C	D
AM7	9"	9 ⁵ / ₈ "	1 ¹ / ₂ "	2 ³ / ₈ "
AM10	14 ¹ / ₁₆ "	14 ⁵ / ₈ "	1 ¹ / ₂ "	2 ³ / ₄ "
AM11	8 ⁷ / ₈ "	9 ¹ / ₂ "	1 ¹ / ₂ "	2 ³ / ₈ "
AM12	12 ¹ / ₂ "	13 ¹ / ₈ "	1 ¹ / ₂ "	2 ¹ / ₄ "
AM18	11 ¹ / ₂ "	12"	1 ¹ / ₂ "	2 ³ / ₄ "
AM20	9"	9 ¹ / ₂ "	1 ¹ / ₂ "	2 ³ / ₈ "
AM23	12 ³ / ₄ "	13 ¹ / ₈ "	1 ¹ / ₂ "	2 ³ / ₈ "
AM28	13 ³ / ₄ "	14 ¹ / ₄ "	1 ³ / ₁₆ "	1 ³ / ₁₆ "
AM30	15 ⁷ / ₈ "	16 ³ / ₈ "	3"	3"
AM32-L	9"	9 ⁵ / ₈ "	1 ¹ / ₂ "	2 ³ / ₈ "
AM54	17"	17 ¹ / ₂ "	1 ³ / ₁₆ "	1 ³ / ₁₆ "
AM80-D	12 ³ / ₄ "	13 ¹ / ₈ "	1 ¹ / ₂ "	2 ³ / ₈ "
AM540	21"	21 ¹ / ₂ "	1 ³ / ₁₆ "	1 ³ / ₁₆ "

UNIT SELECTION CHART

Model No.	Lamp Operated in Emergency Mode	Emergency Illumination Time	Lumens	Wire End Caps	Warranty
AM7	1 lamp 2'-8' (20W-215W) or 2 lamps 2'-4' (20W-40W)	90 min.	700	Included	3 year full
AM10	1 lamp 2'-8' (20W-215W) or 2 lamps 2'-4' (20W-40W)	90 min.	1400	Optional Order #EC10	3 year full
AM11	1 compact fluorescent lamp (7, 9 or 13W)	90 min.	650	Not required	3 year full
AM12	1 lamp 2'-8' (20W-215W) or 2 lamps 2'-4' (20W-40W)	90 min.	1300	Included	5 year full
AM18	1 compact fluorescent lamp (18W & 26W)	90 min.	650	Not required	3 year full
AM20	1 compact fluorescent lamp or 2 compact fluorescent lamps (10W-42W)	90 min.	650	Not required	3 year full
AM23	2 lamps 2'-4'	90 min.	1400	Included	3 year full
AM28	1 lamp 2'-4'	90 min.	500	Optional order #EC54	3 year full
AM30	1 lamp 2'-8' or 2 lamps 2'-4' or 42W 4 pin compact fluorescent	90 min.	3000	Not required	3 year full
AM32-L	1 lamp 2'-4' (20W-40W)	90 min.	550	Optional Order #EC6	3 year full
AM54	1 lamp 2'-4'	90 min.	825	Optional order #EC54	3 year full
AM80-D	Most 2'-8' single, bi-pin T8+T12, long compact, HO+HVO fluorescent lamps	90 min.	1300	Not required	5 year full
AM540	1 lamp 2'-4' (40W-50W) Most 2'-4' T5 or T8 and 40-55 watts 4 pin compact fluorescent	90 min.	1300	Optional order #EC54	3 year full



SIMPLICITY™ Series

Die-Cast Aluminum, 8 or 6-inch Exit Sign
LED Edge-Lit, AC only or Self-Powered
Listed to UL 924 Standards

The Simplicity™ Series exit sign is a snap to install and complements any decor. Using energy saving LED technology, the Simplicity Series features state-of-the-art acrylic panels and precision etched lettering for maximum clarity, visibility and aesthetic appeal.

FEATURES

- **RELIABILITY:** The Simplicity Series comes complete with a five-year warranty.
- **POWER REQUIREMENTS:** 120/277 Vac, 60Hz, 0.3/0.15A.
- **HOUSING:** Modular sign allows for easy installation. Crafted from precision die-cast aluminum. Lightweight and rugged. Universal backbox for all mounting applications.
- **LED STRIP:** LED Strip design allows for rotation for either ceiling or wall mounting. The LED Strip light source offers unequalled energy efficiency with long life legend illumination.
- **TRIM PLATE:** Innovative, aesthetically pleasing design in your choice of either flat, dome, or pyramid shape to accent any decor perfectly.
- **FACE PANEL:** Our LED edge-lit acrylic panels are the pinnacle of the industry. State-of-the-art technology allows us to extrude the acrylic panels resulting in maximum clarity and illumination proven superior to molded panels. Furthermore, our precision etched letters further enhance clarity and illumination.
- **MODULAR DESIGN:** A retainer clip allows for face panel installation that is a “snap” while ensuring a tight fit.
- **DIE-CAST ALUMINUM:** Trim ring used for recessed application, ensures proper seal, and eliminates light leaks.
- **SELF-POWERED UNITS**
 - ♦ **BATTERY:** Long-life, maintenance-free, sealed Nickel-Cadmium battery illuminates the sign for a minimum of 90 min. in emergency mode.
 - ♦ **CHARGER:** Supplied with an automatic, precise constant current charger. The charger is temperature-compensated, short-circuit protected and capable of recharging the battery in accordance with UL 924 standards.

SELF-TEST / DIAGNOSTIC FEATURE

(Optional)

The self-test/diagnostic feature continuously monitors the charger assembly, battery and LED assembly current. If a fault is indicated, the external service required indicator will illuminate. The internal fault indicators will then indicate the nature of the fault. The self-test/diagnostic will self test for 30 seconds every 30 days, 30 minutes every 60 days and 90 minutes annually. Meets NFPA 101 Life Safety Code requirements for periodic testing.

POWER CONSUMPTION CHART

Model	AC Specs		DC Specs	
AC-Only	120 to 277 Vac	2W	-	-
AC/DC	120 to 277 Vac	2W	6 to 24 Vdc	Less than 2W
Self-Powered	120 to 277 Vac	2.5W	NiCad Battery	Min. 90 minutes

CHOICE OF TRIM PLATES

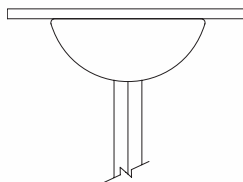

Dome Trim

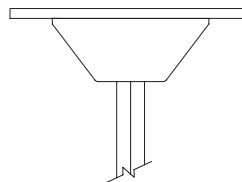

Pyramid trim

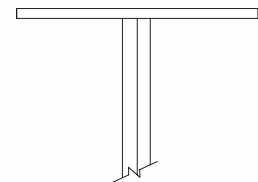

Flat Trim

- Dome or pyramid can be pendant mounted.
- Flat trim for recessed ceilings only. Can be used with drywall ceiling.

ARROW (CHEVRON) DESIGNATION



Chevron Right (CR)



Chevron Left (CL)



Single Face
Double Chevron (1DC)
Double Face
Double Chevron (2DC)

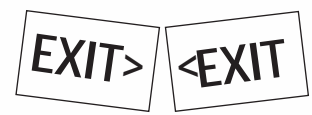

Double Face
Single Chevron (CLCR)
Represents each side of a double face panel.

*Wording and chevron's not to scale. Illustration purposes only.

SIMPLICITY™ Series



EASY INSTALLATION

- A quick connect plug is used to wire the LED strip to the charger and power supply.
- Torsion springs on the trim plate slide into the back box to provided a tight seal between both.
- The modular design results in easy “snap in” of face panel.

OPTIONS

(Add suffix to Model No.)

- Flasher/Buzzer (Self-powered only)-**FB**
- Fire Alarm Activated Flasher-**FAF**
- Dual Circuit (AC models only)-**2**
- Self-Test Diagnostics (Self-powered only)-**D**

For special wording, contact factory.

ACCESSORIES

(Add suffix to Model No.)

- Pendant, White **PW-***
- Pendant, Black..... **PB-***

*Custom pendant length for dome and pyramid trims available, consult factory (12", 24", 36" etc).



DIMENSIONS

Dimensions are approximate and subject to change.

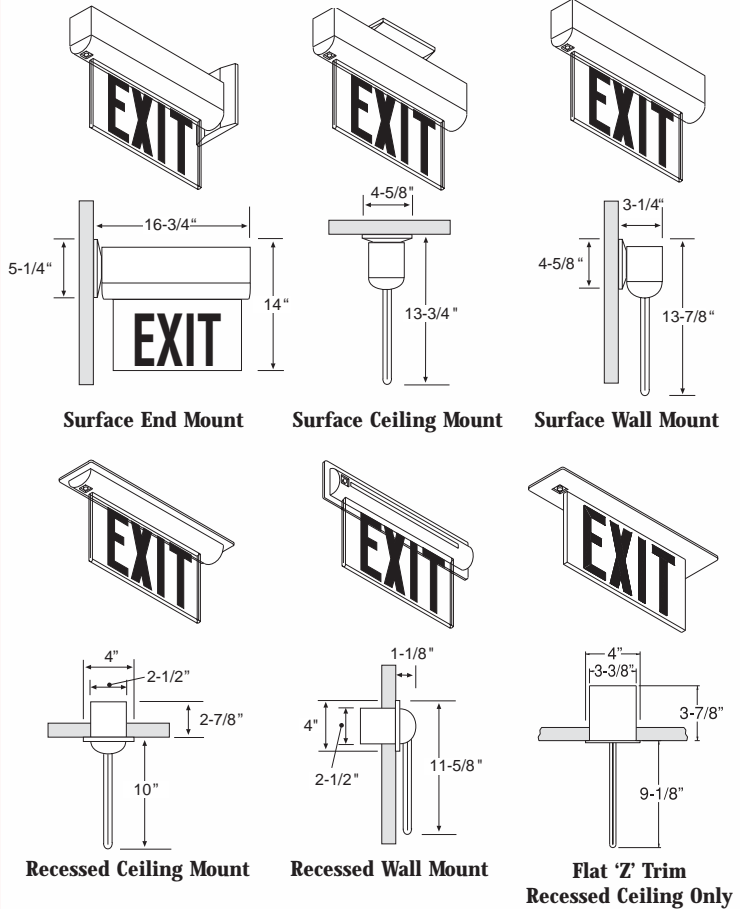

ORDERING INFORMATION

Example: **8 SPLED A RW Z CLCR**

--	--	--	--	--	--	--

Panel Size	Series	Unit Color	Panel Type	Trim	Directional Chevron	Options
8 = 8-inch Letters Blank = 6-inch Letters	SLED = AC Only SPLED = Self-Powered	W = White A = Brushed Aluminum B = Black DB = Bronze PB = Polished Brass CH = Chrome	*RC = Red/Clear RM = Red/Mirror RW = Red/White * Single face only	D = Dome P = Pyramid Z = Flat Trim	Blank = Single Face, No Chevron 2 = Double Face, No Chevron CR = Chevron Right CL = Chevron Left CLCR = Double Face, Single Chevron 2DC = Double Face, Double Chevron 1DC = Single Face, Double Chevron	See Options



GENESIS™ Series

Die-Cast Aluminum, 8 or 6-inch Exit Sign
LED AC, AC/DC, or Self-Powered
Listed to UL 924 Standards

The Genesis™ Series LED exit sign combines visual appeal, durability and energy efficiency in a compact, contemporary design. Available in AC only, AC/DC or self-powered models, the Genesis Series of exit signs is ideally suited for installation in any commercial interior where aesthetics are important.

FEATURES

- **RELIABILITY:** The Genesis™ Series comes complete with a five-year warranty.
- **HOUSING:** Precision die cast aluminum housing features invisible, universal chevron and mounting knockouts. Low profile mounting canopy included with all exit signs for universal top, end or back mount.
- **ELECTRICAL:** All AC only signs come wired as AC/DC signs which operate off a remote DC power source when AC power fails. DC input is a 2-wire, 6-48Vdc universal input.
- **LIGHT SOURCE:** High intensity LED's with diffuser disperses light and enhances brightness. LED's draw only 2 watts of electricity for either single or double face signs.
- Optional damp location listing on all models.
- **SELF-POWERED UNITS**
 - ▶ **HOUSING:** Self-Powered Models are self contained, all circuitry and batteries are contained inside the exit housing.
 - ▶ **BATTERY:** Long life, maintenance-free, sealed Nickel-Cadmium battery.
 - ▶ **ELECTRONICS:** Fully integrated circuitry includes a 120/277 Vac input transformer, automatic, temperature compensated charger, charge monitor LED and test switch.

SELF-TEST / DIAGNOSTIC FEATURE

(Standard)

The self-test diagnostic feature continuously monitors the charger assembly, battery and LED assembly current. If a fault is indicated, the external service required indicator will illuminate. The internal fault indicators will then indicate the nature of the fault. The self-test/diagnostic will self test for 30 seconds every 30 days, 30 minutes every 60 days and 90 minutes annually. Meets NFPA 101 Life Safety Code requirements for periodic testing.

POWER CONSUMPTION CHART

Model (6 in.)	AC Specs		DC Specs	
AC-Only	120 to 277 Vac	1.25W	-	-
AC/DC	120 to 277 Vac	1.25W	6 to 24 Vdc	Less than 1.5W
Self-Powered	120 to 277 Vac	1.60W	NiCad Battery	Min. 90 minutes

Model (8 in.)	AC Specs		DC Specs	
AC-Only	120 to 277 Vac	2.5W	-	-
AC/DC	120 to 277 Vac	2.5W	6 to 24 Vdc	1.6W
Self-Powered	120 to 277 Vac	2.9W	NiCad Battery	Min. 90 minutes

GENESIS™ Series



OPTIONS

(Add suffix to Model No.)

- Dual Circuit (AC-only)-2
- Open Face / Special Wording-Y**
- Vandal Resistant Screws-VR
- Vandal Shield and Screws-LVR
- Fire Alarm Activated Flasher-FAF
- Flasher/Buzzer (Self-powered only)-FB
- Damp Location Listed.....-DL
- Canopy:
- SCA Approved for New Construction-SCA*
- SCA Approved for Retrofit Work-SCAR*

*SCA/SCAR: School Construction Authority Approved
 **Consult factory

ACCESSORIES

(Order as separate item)

- Pendant Mount WhiteGPW-*
- Pendant Mount BlackGPB-*
- Wire Guard (Wall Mount) (8 in.)WG1-L
- Wire Guard (Ceiling Mount) (8 in.)WG3-L
- Wire Guard (Wall Mount) (6 in.)WG13-L
- Wire Guard (Ceiling Mount) (6 in.)WG14-L
- Wire Guard (End Mount) (6 in.)WG15-L
- Wire Guard (End Mount) (8 in.)WG17-L
- Vandal Shield (Wall Mount)VRC
- Vandal Shield, NEMA-4X (Wall Mount)..VRC-4X

*Custom pendant length and colors available,
 consult factory (12", 24", 36" etc).
 Note: 8 in. = School Construction Authority Approved



DIMENSIONS

Dimensions are approximate and subject to change.

Standard Canopy (SCA)

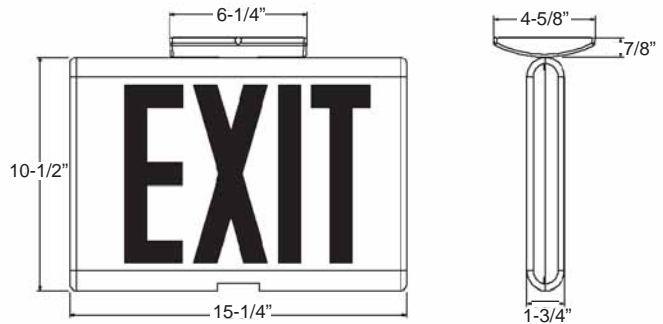

Retrofit Canopy (SCAR)

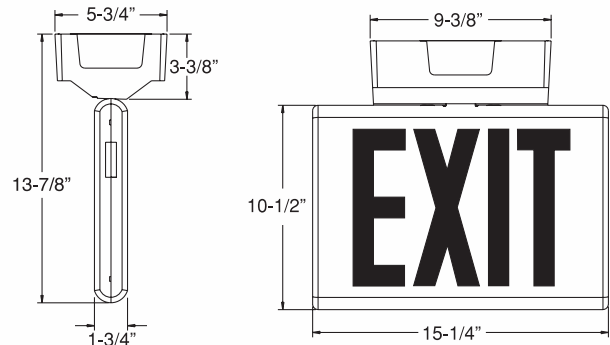

ORDERING INFORMATION

Example: 8 GXE B R A-LVR

--	--	--	--	--	--	--

Letter Size	Series	Housing Color	Letter Color	Face Color	Options	Standard Series Designator
8 = 8-inch Letters 82 = 8-inch Letters Double Face Blank = 6-inch Letters	GX = AC-only GXE = Self-Powered	B = Black W = White A = Brushed Aluminum DB = Dark Bronze PB = Polished Brass	R = Red	B = Black W = White A = Brushed Aluminum	See Options	Blank = 8" Exit -N = 6" Exit



U8XL Series

All Metal, 8-inch
LED Exit Sign, AC or Self-Powered
Listed to UL 924 Standards

The U8XL Series combines versatility with highly-efficient, energy saving illumination. AC-only and Self-powered models available. The same size as the AC-only model, the self-powered model is self-contained with the batteries and circuitry within the exit housing.

FEATURES

- RELIABILITY:** The U8XL Series has a three-year full warranty for self-powered units only (excluding lamps and fuses). Highly energy efficient – consumes a maximum of 3 watts in AC.
- HOUSING:** Durable metal housing. Standard finish is mist white, although other finishes are available. Consult ordering information for details. Housing includes knockouts for universal mounting to wall or ceiling box. The faceplates shall be constructed of metal and come standard metal with knockout chevrons.
- LIGHT SOURCE:** Long-life, high-brightness, LED light source of ALINGAP technology. LEDs provide uniform illumination across the entire exit legend, for both single and double face signs.
- SELF-POWERED UNITS**
 - BATTERY:** Long-life Nickel-Cadmium battery to provide a minimum of 90 minutes of emergency operation.
- POWER REQUIREMENTS:**
 - 120/277 Vac, 60Hz, 0.3/0.15A.
- ELECTRONICS:**
 - AC-ON and charge monitor LED
 - Low voltage disconnect prevents over discharge of the battery
 - Labor saving AC line latch prevents battery discharge during installation to a non-energized circuit.

APPLICATIONS

Ideally suited for commercial and institutional applications requiring an attractive, yet robust energy efficient exit sign.

OPTIONS

(Add suffix to Model No.)

Fire Alarm Activated Flasher-FAF
Flasher/Buzzer (Self-Powered)-FB
Vandal Resistant Screws-VR
Vandal Shield and Screws-LVR

ACCESSORIES

(Order as separate item)

Wire Guard (Wall Mount)WG2-L
Wire Guard (End Mount)WG17-L
Pendant BlackPB-*
Pendant WhitePW-*

*Custom pendant length available, consult factory (12", 24", 36" etc.)

POWER CONSUMPTION CHART

Model (8 in.)	AC Specs		DC Specs	
AC-Only	120-277 Vac	Less than 2.7W	-	-
AC/DC	120-277 Vac	Less than 2.7W	6 to 24 Vdc	Less than 1.5W
Self-Powered	120-277 Vac	Less than 2.7W	NiCad Battery	Min. 90 minutes

DIMENSIONS

Dimensions are approximate and subject to change.

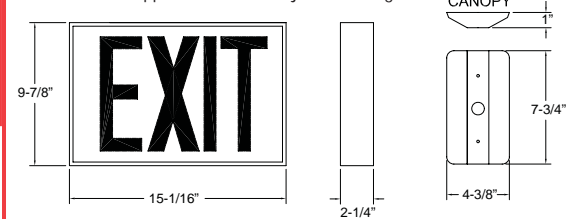

ORDERING INFORMATION

Example: U 8XL EN W R W

--	--	--	--	--	--	--

Style	Model	Type	Color	Letter Color	Stencil	Options
U = Universal 2 Faces & Canopy	8XL = XL Series	Blank = AC only EN = Self-Powered Nickel-Cadmium	W = White B = Black	R = Red	W = White B = Black A = Aluminum	See Options

U8XL Combo Series

All Metal, 8-inch Combination Unit
Listed to UL 924 Standards

NEW DESIGN: more battery capacity, more light output !

The new design of the U8XL mini-system series features 30% to 67% more battery capacity and more powerful emergency lights, including the option of modern-look, MR16 halogen lamps.

The immediate benefits for the customer are an improved illumination on the floor and a longer path of egress covered by the new unit, which translates to better lighting and cost savings.



APPLICATIONS

Ideally suited for commercial and institutional applications that require a low-profile unit with various mounting configurations.

OPTIONS

(Add suffix to Model No.)

- Fire Alarm Activated Flasher-FAF
- Flasher/Buzzer (Self-Powered)-FB
- Vandal Resistant Screws-VR
- Vandal Shield and Screws-LVR

ACCESSORIES

(Order as separate item)

- Wire Guard (Combo)WG3-L

DIMENSIONS

Dimensions are approximate and subject to change.

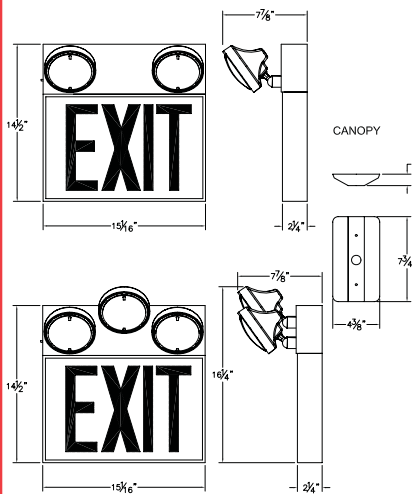

FEATURES

- **RELIABILITY:** The U8XL Series comes standard with a three-year full warranty (excluding lamps and fuses).
- **HOUSING:**
 - ♦ Durable steel housing, includes knock-outs for universal mounting to the wall or ceiling.
 - ♦ EXIT faceplates are constructed of Aluminum and come standard with knock-out chevrons
- **BATTERY:** The unit comes standard with a sealed, maintenance-free Lead-Calcium battery, able to supply the EXIT sign plus 30 Watts of power in emergency mode.
- **LIGHT SOURCE:**
 - ♦ The EXIT sign is illuminated by long-life, high-brightness LEDs of ALINGAP technology, consuming less than One Watt of power.
 - ♦ The unit comes standard with Par 36 size thermoplastic heads with wedge base incandescent lamps. Optional lamp heads and lamps are available upon request, consult the factory.
- **ELECTRONICS:**
 - ♦ Pulse-type charger circuit maintains the battery performance in stand-by mode
 - ♦ AC-ON and Hi-Charge monitor LEDs
 - ♦ Low-voltage disconnect prevents deep discharge of the battery
 - ♦ AC line latch allows the battery connection during installation to a non-energized AC circuit.
- **POWER REQUIREMENTS:**
 - ♦ 120/277 Vac, 60Hz, 0.23/0.10A.

POWER CONSUMPTION CHART

Dual voltage input 120/277VAC, 60Hz, 0.23/0.10 Amp. This consumption includes the EXIT sign module, which consumes less than 1 Watt of power

Battery	Emergency Power	# of Heads	Lamp Types	Remarks
Lead-Calcium	30 Watts	3	Incand. 6V 9W	Standard
		3	MR16 6V 10W	Add suffix M10*
		2	Quartz 6V 12W	Add suffix LH6
Nickel-Cadmium	24 Watts	2	Incand. 6V 9W	Standard
		2	MR16 6V 10W	Add suffix M10*
		2	Quartz 6V 12W	Add suffix LH6

* Mini-heads only



ORDERING INFORMATION

Example: U 8XL W R W /3L

--	--	--	--	--	--	--

Style	Model	Battery Type	Color	Letter Color	Stencil	# of Heads
U = Universal 2 Faces & Canopy	8XL =XL Combo Series	Blank = Lead-Acid N = Nickel-Cadmium	W = White B = Black	R = Red	W = White B = Black A = Aluminum	/0 = No heads /2L = 2 Large Heads /3L = 3 Large Heads /2M = 2 Mini Heads /3M = 3 Mini Heads



LED Series 8XJSLED Series

12V Steel Emergency Lighting and 8-inch LED Exit Sign
Sealed Maintenance Free Lead-Calcium Battery
Listed to UL 924 Standards

Aesthetically attractive, economical unit ideal for commercial or institutional facilities. The 8XJSLED Series combines 12-volt, 2 or 3-head emergency lighting with an 8" LED exit in one housing. This combo offers quick and easy installation along with multiple remote capability to power additional exits or emergency remote fixtures.

FEATURES

- **RELIABILITY:** The 8XJSLED Series comes complete with a three-year full warranty (excluding lamps, pilot lights and fuses).
- **HOUSING:** The resistant housing is fabricated using 20-gauge precision die formed steel. This single housing, exit combination with two or three thermoplastic lamp heads. Standard mist white enamel finish. Please contact the factory for other available finishes.
- **LAMP HEADS:** Lamp heads are constructed of injection molded thermoplastic material with the option of two or three emergency lighting heads, which mount directly to the unit. Heads are fully adjustable and the front lens assembly is molded from translucent clear acrylic for efficient lumen output. Rotation stops are molded into all heads as per UL 924 specifications. When ordering option with (-2/3) heads, the unit shall come with 2 heads mounted on the unit and one spare head included in the box.
- **BATTERY:** The 8XJSLED unit contains a 12V sealed, maintenance-free lead calcium rechargeable battery. A low voltage disconnect shall be provided to shut off the lamp load and circuitry to protect battery from possible damage due to deep discharge. This unit has 90 minutes, minimum, of emergency back-up.
- **LIGHT SOURCE:** This unit is equipped with ultra-high brightness Aluminum Indium Gallium Phosphate (ALINGAP) LED. Both the AC and battery operation utilize the same set of high brightness LED. The emergency heads are furnished with lamp heads wedge based, T5, tungsten high lumen output lamps. The standard unit comes with 12 watt heads.

APPLICATIONS

The 8XJSLED unit is ideal for all industrial, commercial and institutional environments requiring extended illumination time and remote capability.

BATTERY

12 volt sealed maintenance free Lead-Calcium rechargeable battery. The unit has 90 minutes, minimum of emergency back-up.

POWER CONSUMPTION CHART

Energy Data	Ac Input	Maximum		Stand-By	
		Input Current (A)	Input Power (Watts)	Input Current (A)	Input Power (Watts)
Entire Unit	120V	0.225	19.5	0.060	5.2
	277V	0.095	19.0	0.025	5.2



Exit sign modules have earned the Energy Star by consuming less than 1 watt.

8XJSLED Series



OPTIONS

(Add suffix to Model No.)

Extra 36W Remote Capacity-R

ACCESSORIES

(Order as separate item)

Mounting PlatformMP-PQA

Wire GuardWG3-L

DIMENSIONS

Dimensions are approximate and subject to change.

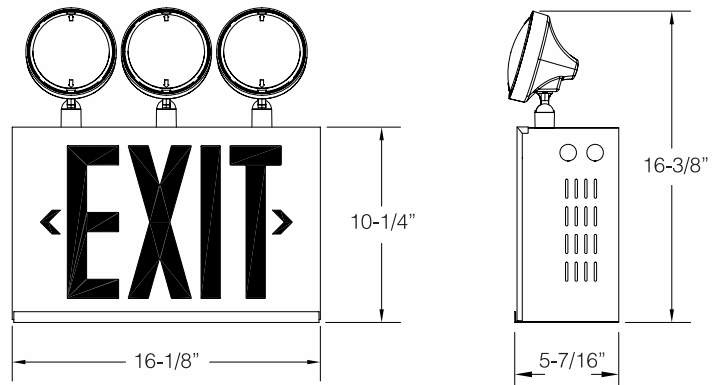

ORDERING INFORMATION

Example: B8XJSLED-0-BRA-R

Housing Color	Series	Number of Heads	Letter/Face Color	Options
Blank = White B = Black	8XJSLED = 12V-36W	-0 = No Head (36W Output) -2 = Two Heads (12W each) (12W Remote) -3 = Three Heads (12W each) -2/3 = Two Heads Mounted on Unit and one Un-Installed Spare in the Box (12W each)	Blank = White Face/Red Fiber -BRA = Brushed Aluminum Face/Red Fiber	Blank = No Options -R = Extra Remote Capacity (36W) (72W Total Output)



SEVERE™ XV Series

NEMA-4X Rated, Self-Powered Exit Sign
standard with Self-Test/Diagnostic Circuitry
Listed to UL 924 Standards

The Severe™ XV Series, certified for NEMA-4X, is designed specifically for high abuse areas, wet locations and cold weather applications (-20°C (-4°F) for self-powered and -40°C (-40°F) for AC and AC/DC models). Please see "CW" option below. The Severe™ XV Series exit sign is unaffected by the vibrations, ambient temperature swings and typical power surges detrimental to standard exit light sources.

FEATURES

- RELIABILITY:** The Severe™ XV Series has a five-year full warranty. Unit comes standard with tamper-resistant magnetic test switch and self-diagnostic circuitry on all self-powered models.
- HOUSING:** Rugged PVC frame is fully gasketed around lens and canopy to prevent water infiltration. The sealed faceplate is constructed of heavy duty, vandal-resistant polycarbonate with evenly illuminated legend.
- LIGHT SOURCE:** Light emitting diodes (LED). Red LED technology shall be long-life, energy-efficient ALINGAP. An LED-sensitive diffuser shall be mounted behind the legend to provide the 6" high by 3/4" stroke letters with even illumination.
- ELECTRICAL:** The equipment shall operate with universal two-wire AC input voltage from 120Vac to 277Vac at less than 3 watts and universal two-wire DC input voltage from 6Vdc to 24Vdc at less than 1.5 watts for single and double face signs.

- POWER REQUIREMENTS:**
▶ 120/277 Vac, 60Hz.



NEMA-4X

idEXIT
Improved diagnostics

APPLICATIONS

Ideally suited for any environment that strains standard exit signage such as schools, transit platforms, parking garages, security areas/prisons, hose down areas, wet and cold locations and any areas prone to vandalism.

OPTIONS (Add prefix to Model No.)

- Dual Circuit Operation (120/120 or 277/277)2*
- Fire Alarm Activated Flasher-FAF
- Flasher/Buzzer (Self-Powered Only) ..-FB
- Flasher-FL
- 6, 12, 24 or 48 Volt DC Kit.....DC
- Open Face/Special WordingY
- Cold Weather Unit (-20°C (-4°F))CW
- Kit to Convert Single to Double Face (white)DFKR-WT
- Kit to Convert Single to Double Face (black)DFKR-BK

*AC only units.

BATTERY

Sealed maintenance-free Nickel-Cadmium battery for superior performance and long life. Provides 90 minutes of emergency operation upon AC failure. Batteries recharge as per UL requirements.

DIMENSIONS

Dimensions are approximate and subject to change.

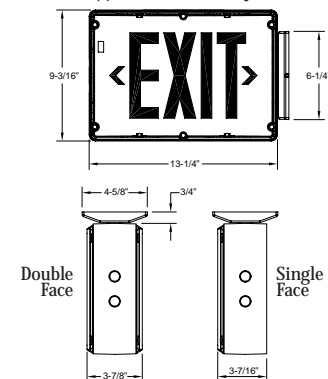

POWER CONSUMPTION CHART

Model	AC Specs		DC Specs	
	AC-Only	120 to 277 Vac	1.2W	-
AC/DC	120 to 277 Vac	1.2W	6 to 24 Vdc	Less than 1.5W
Self-Powered	120 to 277 Vac	3.7W	NiCad Battery	Min. 90 minutes

ORDERING INFORMATION

Example: XVE-1-R-D-4X

--	--	--	--	--	--	--

Color Option Housing/Face	Series	Faces	Legend Colors	Diagnostics	Housing	Options
Blank = Black/Black BW = Black/White BA = Black/Alum. GB = Gray/Black GW = Gray/White GA = Gray/Alum. WB = White/Black WW = White/White WA = White/Alum.	XV = AC-Only XVE = Self-powered Nickel-Cadmium Battery	-1 = Single Face -2 = Double Face	-R = Red	Blank = AC-Only Models -D = Standard on all Self-Powered Models	-4X = Standard NEMA-4X Housing	See Options

SEVERE™ XV Combo Series

NEMA-4X Combo Unit
Listed to UL 924 Standards

The Severe™ XV Series NEMA-4X Rated Combo in an impressive, state-of-the-art illumination for use in harsh environments. It is offered with the choice of 5 watt, LED lamp heads or an MR16 light source.



APPLICATIONS

Offering impressive illumination of the path of egress, the Severe XV Series is designed for use in a wide range of applications, specifically high abuse areas, wet and cold locations.

BATTERY

Sealed maintenance-free Nickel-Cadmium battery for superior performance and long life. Provides 90 minutes of emergency operation upon AC failure. Batteries recharge as per UL requirements.

POWER CONSUMPTION CHART

Model	AC Specs		
	Voltage	Current	Power
XV12E	120 to 277 Vac	0.12/0.06A	Less than 13W
XV24E	120 to 277 Vac	0.18/0.09A	Less than 20W
CW Options	120 to 277 Vac	0.20A	Less than 23W



Listed



DIMENSIONS

Dimensions are approximate and subject to change.

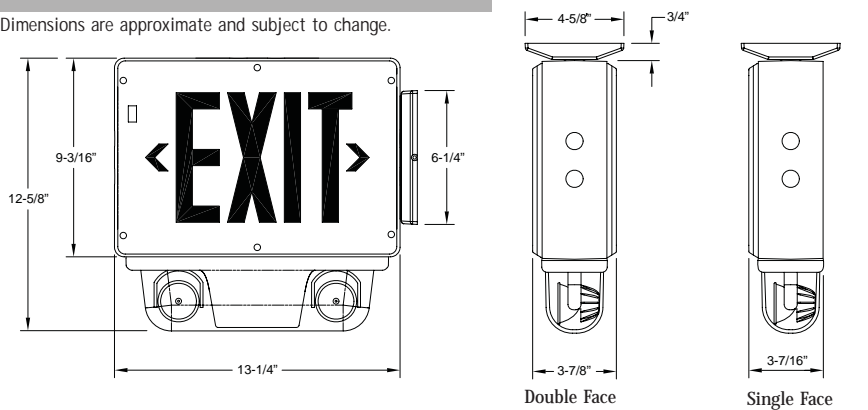

FEATURES

- **RELIABILITY:** The Severe™ XV Series has a five-year full warranty. Unit comes standard with non-intrusive magnetic test switch and continuous self-diagnostic monitoring and monthly self-testing.

- **HOUSING:** Rugged PVC frame is fully gasketed around lens and canopy to prevent water infiltration. The sealed faceplate is constructed of heavy duty, vandal-resistant polycarbonate with uniform ALINGAP technology Red LED illuminated legend. Choice of white, black or grey housing and face. Universal mounting: wall, end or ceiling.

- **LIGHT SOURCE:**
 - ♦ High efficiency MR16 lamps up to 12V, 12W or white LED (12V, 5W) emergency lights. Emergency lights shall be fully adjustable.

- **ELECTRICAL:** The equipment shall operate with universal two-wire AC input voltage from 120Vac to 277Vac.

- **POWER REQUIREMENTS:**
 - ♦ 120/277 Vac, 60Hz, 0.12/0.20A.

ORDERING INFORMATION

Example: XV12E1RD4X/2M6CW4

--	--	--	--	--	--	--	--	--	--

Housing/ Face Color	Series	Capacity	Faces	Letter Color	Diagnostics	Housing	# of Heads	Lamp/ Wattage	Options
Blank = Black/Black BW = Black/White BA = Black/Alum. WW = White/White WB = White/Black WA = White/Alum. GA = Gray/Alum. GW = Gray/White GB = Gray/Black	XV	12E = 6V-12W 24E = 12V-24W	1 = Single Face 2 = Double Face	R = Red Letters	D = Improved Diagnostics Non-Audible (standard) DA = Improved Diagnostics-Audible	4X = NEMA-4X	/0 = 0 Heads* /2 = Two Heads	M6 = MR16, 6V - 6W M12 = MR16, 12V - 12W L5 = LED, 12V - 5W	*CW4 = Cold Weather *Available in 12E1 Version Only (-40°C) (-40°F) FAF = Flasher (Fire Alarm Activated) **FB = Flasher/Buzzer (a.c. Power Failure) **Not Available with "DA" Option FL = Flasher (A.C. Power Failure)



AC Central Systems

Lightalarms central systems are battery based power systems designed to operate loads in the event of a utility failure or brownout condition. All systems are self-contained and fully automatic.

Batteries offered with central systems:

- Sealed Maintenance-Free Lead-Calcium (AC Systems)
- Refillable Nickel-Cadmium (AC Systems)



IPS (Interruptable)

Single phase power systems for incandescent and fluorescent emergency lighting systems

- 98% efficient
- 2mS transfer time
- PWM/IGBT technology
- Micro-processor control
- User programmable with password protection
- UL 924 Listed
- Automatic event and alarm log
- RS232 communications port
- Input circuit breaker
- Modular design
- Low audible noise
- Normally off output
- From 500KVa to 16.7KVa

Single Phase Fast Transfer (Uninterruptible)

Single phase power systems for HID, incandescent and fluorescent emergency lighting systems.

- 98% efficient
- PWM/IGBT technology
- Micro-processor control
- User programmable with password protection
- UL 924 Listed
- Automatic event and alarm log
- RS232 communications port
- Input circuit breaker
- Modular design
- Low audible noise
- Normally on output
- From 500KVa to 16.7KVa



Three Phase Fast Transfer (Uninterruptible)

On-line AC power systems for HID incandescent and fluorescent emergency lighting systems.

- 98% efficient
- PWM/IGBT technology
- Micro-processor control
- User programmable with password protection
- UL 924 Listed
- Automatic event and alarm log
- RS232 communications port
- Input circuit breaker
- Modular design
- Low audible noise
- Internal battery circuit breaker/fuse
- From 4.8KVa to 50KVa

All information and specifications contained on this page are subject to change without notice.

Saf-T-Ray™ SAF Series

Decorative Style Wall Mount Remote Fixture
Listed to UL 924 Standards

The Saf-T-Ray™ wall sconce unit was designed and engineered with durability and sophistication in mind. Its low-profile aesthetic design will provide an attractive alternative to the typical two-headed standard emergency lighting fixtures.



APPLICATIONS

The Saf-T-Ray is suitable for outdoor and indoor use, in a wide range of applications where aesthetics cannot be compromised.

LAMPS HEADS

Precise beam control is provided with two fully adjustable MR16 halogen lamps, secured in an attractive molded swivel assembly for maximum light output. Saf-T-Ray will provide an average of one-foot candle along the path of egress. Saf-T-Ray can also be used with the premium option of the high efficiency 3-Watt MR16 white LED lamp. IES photometric data files are available.



DIMENSIONS

Dimensions are approximate and subject to change.

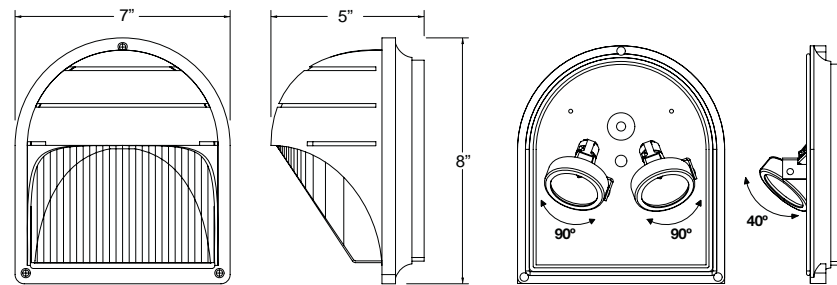

FEATURES

- **HOUSING:** The premium die-cast aluminum housing is designed to withstand extreme weather conditions. Ideal for damp, wet and cold location specifications, the unit has a fully gasketed cover with vandal resistant screws available as an option. Available in four (4) textured powder paint finishes: white, black, dark bronze and dark gray. Other colors and finishes available for custom projects.
- **DIFFUSER:** Polycarbonate diffuser maximizes light output and completes the wall sconce decorative lines. A robust polycarbonate lens is ideal for applications where impact- and tamper-resistant emergency lighting are specified.



ORDERING INFORMATION

Example: SAF-2/M12-M 6

Series	# of Lamps	Lamp Type/Wattage	Color	Voltage	Option
SAF = Remote	-1 = 1 Lamp (AC Only) -2 = 2 Lamps (Standard)	/L5 = LED - 5 watt (12V Only) /M6 = MR16 - 6 watt (6V Only) /M10 = MR16 - 10 watt (6V Only) /M12 = MR16 - 12 watt (12V or 24V only) /M20 = MR16 - 20 watt (12V or 24V Only) /AC = 1 med. Base Socket only (max.60W), no Lamp Included, for Non-Emergency	-M = White -B = Black -DG = Dark Gray -DB = Dark Bronze	6 = 6V 12 = 12V 24 = 24V	VR = Vandal-Resistant Screws



Decorative Remote Series

Lamps: MR16 halogen, 6V, 12V, 24V

To Order: -20W (-20 watts), -35W (-35 watts), -50W (-50 watts),
-6W (-6 watts, 6V only), -10W (-10 watts, 6V only)



AC Systems

Color: WH = white, BK = black

DR1161

Description: Single compact adjustable decorative lighting heads

Dimensions: 4.48" diameter base, 5.2" height



DR2161

Description: Double compact adjustable decorative lighting heads

Dimensions: 4.48" diameter base, 4.0" height



DR3161

Description: Triple compact adjustable decorative lighting heads

Dimensions: 11.0" diameter base, 5.2" height



Surface Type

Color: WH = white, BK = black

DR1160

Description: Single compact adjustable decorative lighting heads

Dimensions: 4.48" diameter base, 5.2" height



DR2160

Description: Double compact adjustable decorative lighting heads

Dimensions: 4.48" diameter base, 4.0" height



DR3160

Description: Triple compact adjustable decorative lighting heads

Dimensions: 11.0" diameter base, 5.2" height



Surface Type

Color: WH = white, BK = black

DR1130

Description: Single compact adjustable decorative lighting heads

Dimensions: 4.48" diameter base, 5.9" height



DR2130

Description: Double compact adjustable decorative lighting heads

Dimensions: 4.48" diameter base, 4.5" height



DR3130

Description: Triple compact adjustable decorative lighting heads

Dimensions: 11.0" diameter base, 5.9" height

ORDERING FORMAT

Series	Color	Wattage	Voltage
DR1130	WH = White BK = Black	/M6 = 6W /M10 = 10W /M12 = 12W /M20 = 20W /M35 = 35W /M50 = 50W	6 = 6V 12 = 12V 24 = 24V

Decorative Remote Series

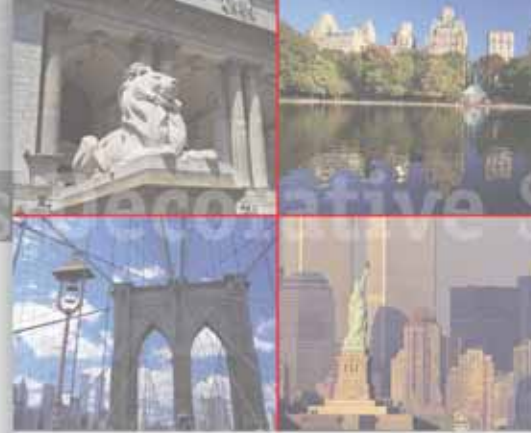

Recessed Type*

RSTH24

Description: Decorative lighting head

Dimensions: 4.0" diameter base

Color Suffix: WH = white, BK = black , CH = chrome,
PB = polished brass, BN = brushed nickel



Recessed Type*

RSTH18

Description: Decorative lighting head

Dimensions: 4.0" diameter base

Color Suffix: WH = white or BN = brushed nickel



Recessed Type*

RSTH18R

Description: Decorative lighting head

Dimensions: 4.0" diameter base

Color Suffix: WH = white or BN = brushed nickel



Recessed Type*

RSTH19

Description: Decorative lighting head

Dimensions: 4.0" diameter base

Color Suffix: WH = white



Recessed Type Housing

LU-GRHR03

Description: New construction housing

Dimensions: 5.6" x 14.24"



Recessed Type Housing

LU-GRHR06

Description: Insulated ceilings housing

Dimensions: 7.25" x 14.24"

*Recessed gimbal assemblies require a recessed housing and are sold separately.

ORDERING FORMAT

Series	Color	Wattage	Voltage
RSTH18	WH = White BK = Black CH = Chrome	PB = Polished Brass BN = Brushed Nickel	/M6 = 6W /M20 = 20W /M10 = 10W /M35 = 35W /M12 = 12W /M50 = 50W
			6 = 6V 12 = 12V 24 = 24V

Remote Fixture Series



ELF2, ELF2D, ELF2T

DESCRIPTION: Single, double or triple PAR18 size indoor lighting head with fully adjustable swivel; all thermoplastic construction.

FINISH: Mist white, black.

LAMPS: Wedge base incandescent or bi-pin halogen.

VOLTS: 6, 12 or 24Vdc

MAXIMUM WATTS: 18



ELF3, ELF3D, ELF3T

DESCRIPTION: Single or double MR16 size indoor lighting heads with fully adjustable swivel. All thermoplastic construction.

FINISH: Mist white, black.

LAMPS: MR16.

VOLTS: 6 or 12Vdc

MAXIMUM WATTS: 20



ELF622, ELF622D, ELF622T

DESCRIPTION: Single, double or triple PAR36 size indoor lighting heads, with fully adjustable swivel to 358°. All aluminum construction.

FINISH: Mist White, Black or Chrome.

MOUNTING: Standard with round aluminum plate for mounting directly to 4" outlet box (4-gang plate for ELF622D optional).

LAMPS: Double contact bayonet base or wedge base incandescent, bi-pin halogen, sealed beam.

VOLTS: 6, 12, 24, 32/36 or 120Vdc

MAXIMUM WATTS: 25 (10 watts for 120V)



ELF645, ELF645D, ELF645T

DESCRIPTION: Single, double or triple PAR36 size lighting head with fully adjustable swivel, all thermoplastic construction.

FINISH: Mist White, Gray or Black.

MOUNTING: Standard with round plate for mounting directly to 4" outlet box (4-gang plate for ELF645D optional).

LAMPS: Double contact bayonet base or wedge base incandescent, bi-pin halogen, sealed beam.

VOLTS: 6, 12, 24, 32/36 or 120Vdc

MAXIMUM WATTS: 25 watts per head



ELF647, ELF647D, ELF647T

DESCRIPTION: NEMA CLASSIFIED. Single, double or triple PAR36 size lighting head with fully adjustable swivel, all thermoplastic construction, and stainless steel screws. Standard with round aluminum plate for mounting directly to 4" outlet box. Fixtures are rain and dust-tight as well as corrosion resistant.

FINISH: Mist White, Gray or Black.

MOUNTING: Standard with round plate for mounting directly to 4" outlet box.

LAMPS: PAR36 sealed incandescent.

VOLTS: 6 or 12Vdc

MAXIMUM WATTS: 25 watts per head

Remote Fixture Series

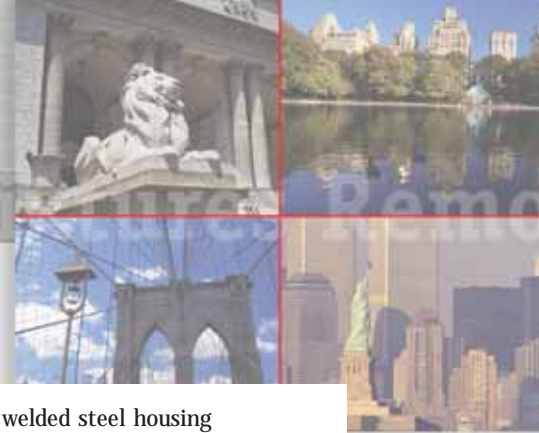

ELF605M, ELF605P

DESCRIPTION: Recessed round gimbal fixture with welded steel housing and plastic (ELF605P) or metal (ELF605M) trim. Lamp has a horizontal rotation of 358° and vertical angle adjustable to 42°.

FINISH: White (standard).

MOUNTING: Recessed (wall or ceiling). Plaster frame and standard 4" outlet box provided.

LAMPS: Double contact bayonet base or wedge base incandescent or bi-pin halogen, sealed beamed.

VOLTS: 6, 12, 24, 32/36 or 120Vdc

MAXIMUM WATTS: 25 watts (6 watts for 120V)



ELF606

DESCRIPTION: Round, surface mounted gimbal fixture with welded steel housing. Lamp has a horizontal rotation of 358° and vertical angle adjustable to 42°.

FINISH: Housing: Matte white.

Trim: White.

MOUNTING: Surface (wall or ceiling). 1/2" or 3/4" knockout provided.

LAMPS: Sealed beam incandescent, double contact bayonet base, wedge-base incandescent, bi-pin halogen.

VOLTS: 6 or 12Vdc

MAXIMUM WATTS: 25 watts per head



ELF610

DESCRIPTION: Recessed adjustable eyeball fixture, can be rotated through 358° and adjustable to 42°.

FINISH: White enamel.

MOUNTING: Recessed (wall or ceiling).

LAMPS: Single contact bayonet base.

VOLTS: 6, 12, 24Vdc

MAXIMUM WATTS: 26 watts per head



ELF644, ELF644-FR

DESCRIPTION: Remote SQUARE-LITE to match RSQ Series shown on page 7. Constructed from high impact, mar-resistant thermoplastic with plated steel reflector and prismatic acrylic lens.

FINISH: Back box: Black satin Front case: Mist white

MOUNTING: Available for surface, semi-recessed (order SQR kit), or fully recessed (order FSQR kit) mounting. Fully recesses into T-bar or exposed Z-spline ceilings. Supporting bars or rods supplied by others.

LAMPS: Bi-pin halogen lamp.

VOLTS: 6 or 12Vdc

MAXIMUM WATTS: 14 watts per lamp

Lamp type(s), voltage and maximum wattage available for fixtures are shown under lamp description. Determine lamp type, voltage and wattage required for your application, then select lamp from lamp chart on pages 42 and 43.

ORDERING FORMAT

Series ELF647	Lamps Suffix /4044	Color M = Mist White	Voltage 12 = 12V

Lamp Chart

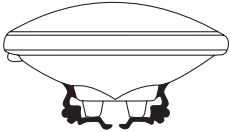
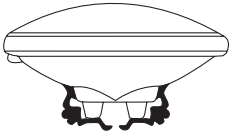

PAR36 SEALED BEAM LAMPS — (Available by Special Order)

 SEALED BEAM HALOGEN PAR36	Unit/System Battery Voltage	Watts	Rated Volts	Lamp Suffix/ Lamp Number	Replacement Number	Center Beam Candle Power (CP)	
	 SEALED BEAM INCANDESCENT PAR36	6 VOLT	HALOGEN				
6			6	H7556	550.0022	400	
8			6	H7551	550.0036	550	
10			6	H7552	550.0037	650	
12			6	H7553	550.0019	850	
20		6	H7554	550.0021	1400		
12 VOLT		HALOGEN					
		8	12	H7555	550.0024	550	
		12	12	H7557	550.0025	850	
37		12	H7616	550.0047	70,000		
6 VOLT		INCANDESCENT					
		8	6	7613	550.0018	400	
	12	6	4042	550.0030	1100		
	18	6	4014	550.0016	1500		
	25	6	4510	550.0017	800		
	30	6	4515	550.0035	5500		
	12 VOLT	INCANDESCENT					
		12	12	4044	550.0026	1110	
		18	12	4414	550.0027	1500	
		25	12	4446	550.0023	400	
		35	12	4406	550.0032	600	
		25	12	25 PAR36 WFL	550.0028	360	
		25	12	25 PAR36 VWFL	550.0050	160	
		50	12	50 PAR36 NSP	550.0043	11,000	
		50	12	50 PAR36 WFL	550.0029	900	

Note: Light output: Stated in candle power or lumens

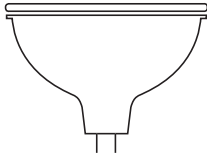
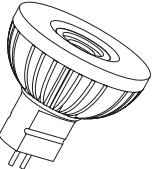
 HALOGEN MR16	Unit/System Battery Voltage	Watts	Rated Volts	Lamp Suffix		Replacement Number	Center Beam Candle Power (CP)
				for Units	add Volt for Remote Fixtures		
 LED MR16 Shape	6 VOLT	5	6	M5	6	580.0072	110
		6	6	M6	6	580.0074	130
		10	6	M10	6	580.0079	250
	12 VOLT	12	12	M12	12	580.0080	300
		20	12	M20	12	580.0075	600
		35	12	M35	12	580.0083	1300
		50	12	M50	12	580.0076	2100
		24 VOLT	12	24	M12	24	580.0070
	20		24	M20	24	580.0077	600
	35		24	M35	24	580.0084	1200
	50		24	M50	24	580.0078	1800
	12 VOLT LED	5*	12	L5	12	580.0063	205

* 3W white LED and 2W to drive engine

Accessories

Wire Guards

Wire Guard 1
Catalog Number: WG1-L

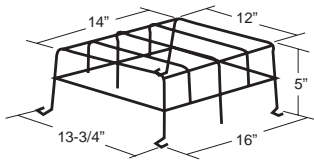

Wire Guard 6
Catalog Number: WG6-L

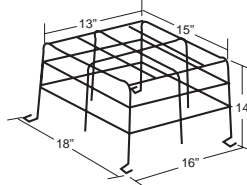

Wire Guard 12
Catalog Number: WG12-L

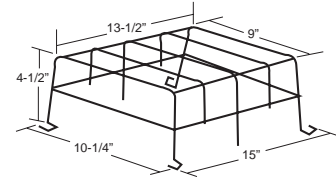

Wire Guard 2
Catalog Number: WG2-L

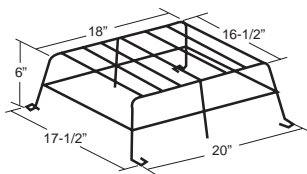

Wire Guard 8
Catalog Number: WG8-L

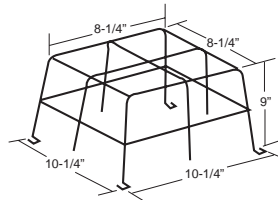

Wire Guard 13
Catalog Number: WG13-L

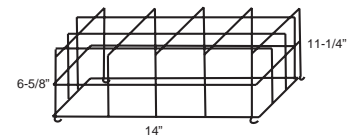

Wire Guard 3
Catalog Number: WG3-L

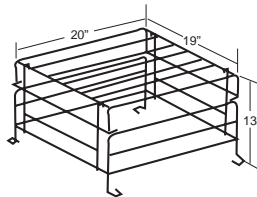

Wire Guard 9
Catalog Number: WG9-L

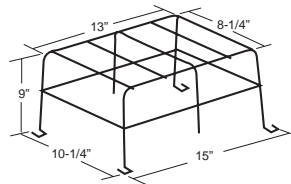

Wire Guard 14
Catalog Number: WG14-L

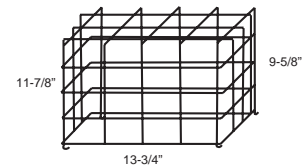

Wire Guard 4
Catalog Number: WG4-L

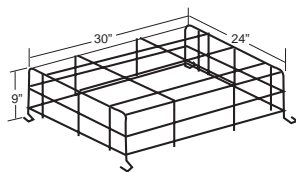

Wire Guard 10
Catalog Number: WG10-L

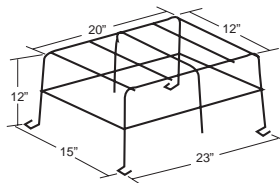

Wire Guard 15
Catalog Number: WG15-L

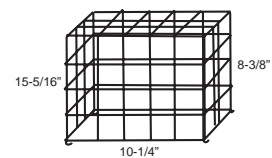

Wire Guard 5
Catalog Number: WG5-L

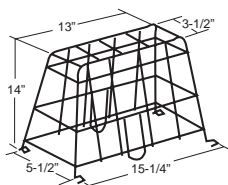

Wire Guard 11
Catalog Number: WG11-L

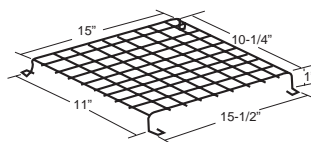

Wire Guard 17
Catalog Number: WG17-L

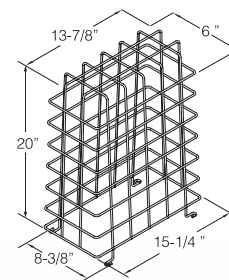

Dimensions are approximate and subject to change.

Accessories

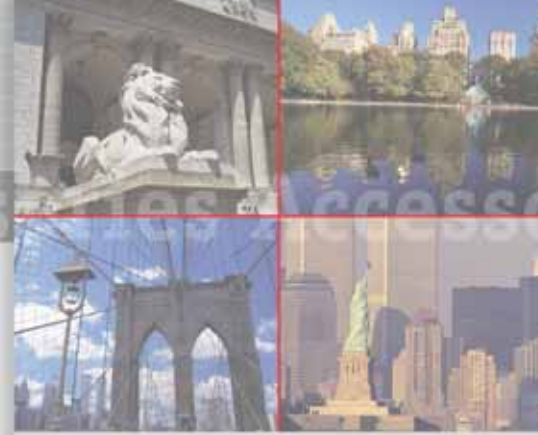

- 14 gauge steel
- Corrosion resistant undercoat
- Oven baked finish
- 1/2" retaining lip on three sides
- Keyhole slots for easy mounting

Model	Dimensions (inches)						
	A	B	C	D	E	F	G
MP-PQB (Mist)	17	7 ³ / ₄	12 ¹ / ₄	16	3/4	5/16	5/8
MP-A (Gray)	17	7 ³ / ₄	12 ¹ / ₄	16	3/4	5/16	5/8
MP-PQA (Mist)	16 ³ / ₈	5 ³ / ₄	10 ¹ / ₄	12 ¹ / ₂	7/8	3/16	7/16
MP12	27 ¹ / ₂	7 ³ / ₄	12 ¹ / ₄	16	1 ⁵ / ₈	5/32	5/16

Dimensions are approximate and subject to change.

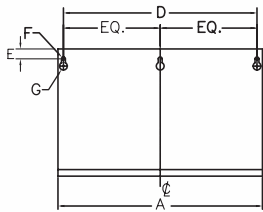

MP-PQB + MP-A

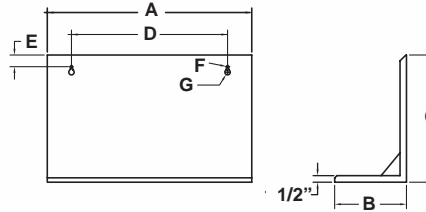

MP-PQA

Mounting Platforms

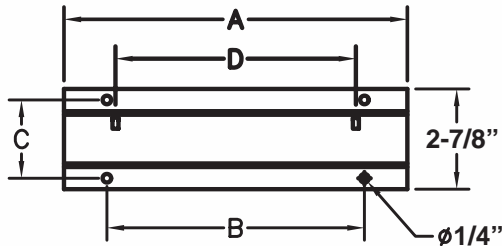

- 16 gauge steel
- Corrosion resistant undercoat
- Oven baked finish
- Supplied with rubber stand-offs for unit and machine screws to secure unit to bracket

Model	Dimensions (inches)			
	A	B	C	D
MB-A	10	7 ³ / ₄	2 ³ / ₁₆	7
MB-B	14 ¹ / ₄	11 ³ / ₄	2 ³ / ₁₆	12 ⁵ / ₈

Dimensions are approximate and subject to change.

Mounting Brackets

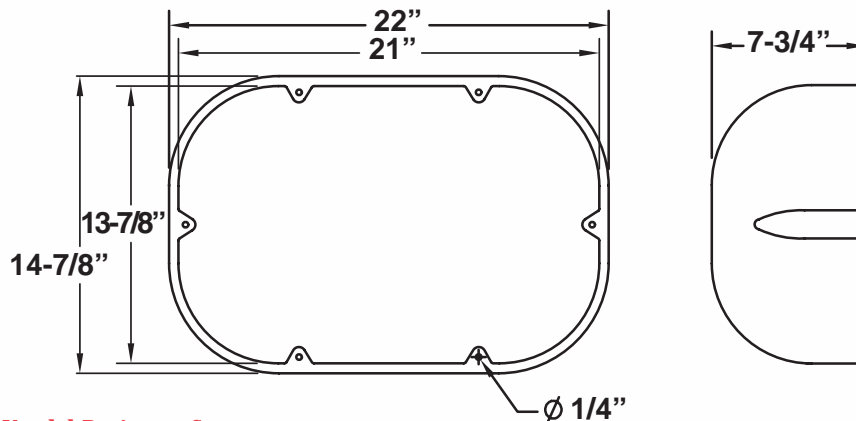

Vandal Resistant Cover

Application: MG Series

Catalog Number: CPS or CPS-4X (NEMA-4X)

Dimensions are approximate and subject to change.

Vandal Resistant Covers

Popular Options

Lightalarms life safety equipment is available with a range of options that can be added to enhance performance, simplify testing or adapt equipment for use in specific environments. Please refer to individual product pages to verify availability of individual options on specific equipment.

Voltmeter

Option provides a visual indication, in the test mode, of the unit's battery voltage. The good/check meter face allows maintenance personnel to recognize charger and battery function.

Add Suffix: -V

Ammeter

Option provides an indication of charge current when the unit is in the equalize mode. This verifies charger capability and the current acceptance of the battery.

Add Suffix: -A

Dual Circuit

Option provides two A.C. input circuits to permit 2 separate A.C. sources to energize the sign. Available in 120/120Vac or 277/277Vac.

Add Suffix: -2

Tamper Proof

Tamper proof screws may be used on certain units to avoid unauthorized entry to circuitry or vandalism.

Add Suffix: -TP

Disconnect Switch

Option will disconnect lamp load when area is not in use during prolonged power failure. The switch may also be used to reactivate emergency power to remote or built in heads.

Add Suffix: -DS

Time Delay

Option is designed to be used in areas where HID type lamps are used for normal lighting. As these lamps require several minutes to re-strike and to produce their nominal lighting output, it is necessary to also hold the emergency lighting on for this period, even after the AC utility has been restored. A time delay unit can be helpful in areas where it is difficult to directly access an emergency lighting unit's test switch. The power to the unit can be briefly switched off and on at the breaker panel, and the maintenance person can then return to the unit and observe a timed emergency operation.

Add Suffix: -TD

Remote Test Switch

A hardwired push button test switch connected in series with the AC emergency line facilitates testing emergency lighting units that are not easily accessible.

Add Suffix: -PSW

Damp Location

Option for environments that are subject to moderate amounts of moisture (humidity), and a temperature range between 10°C (50°F) and 40°C (104°F). Example: partially protected exterior areas such as canopies, stairwells, etc.

Add Suffix: -DL

Thermal Jacket

Option to be used in areas where temperature may drop below 0°C (32°F). The thermostat will activate the heating pad at 0°C and will cut off at 16°C (61°F). The heating pad is rated at 50 watts. Contact factory for temperature limitations.

Add Suffix: -H1 (120V) -H2 (277 V)

Self-Test/Diagnostic Feature (for exit signs)

Option is designed to continuously monitor the charger assembly, battery and LED assembly current. If a fault is indicated the external service required indicator will illuminate. The diagnostic/self test will self test for 30 seconds every 30 days, 30 minutes every 60 days and 90 minutes annually. Meets NFPA 101 Life Safety Code requirements for periodic testing.

Add Suffix: -D

Improved Diagnostics/Improved Diagnostics Non-audible (ID/IDNA, for battery units)

See page 47.

Improved Diagnostics

By incorporating our most popular standard diagnostics features with a powerful 8-bit microcontroller, our new Improved Diagnostics system assures unsurpassed reliability in one, totally contained system. In the event of an equipment malfunction, the improved diagnostics system produces an audible warning in the form of an intermittent beep and the LED indicator associated with the fault will illuminate continuously. When the problem is acknowledged by depressing the alarm/silence/test button, the alarm is silenced and the LED indicator changes to a flashing mode until the problem is corrected.

- Continually monitors system parameters
- Incorporates state-of-the-art microcontroller technology
- ID includes audio and visual service alarms
- IDNA non-audible version for visual service alarms only
- Self-testing in accordance with NFPA101, Life Safety Code

FEATURES

- **BATTERY FAILURE:**
(Red) Illuminates if the battery is shorted or battery voltage drops below preset value. Will also detect incorrect battery (ie. 6Vdc vs. 12Vdc)
- **BATTERY DISCONNECT:**
(Red) Illuminates if the battery circuit is open.
- **CHARGER FAILURE:**
(Red) Illuminates when charger is not functioning properly by monitoring the charger current.
- **LAMP FAILURE:**
(Red) Illuminates when one or more emergency lamps fail. Also monitors remote lamps.
- **SERVICE ALARM:**
(Red) Illuminates when a fault is detected that requires a qualified service technician.
- **AC ON:**
(Green) Lit when line voltage is present.
- **CHARGER ON:**
(Amber) Illuminates when charger is recharging the battery.
- **ALARM ON:**
Button is used to acknowledge and silence alarms. Also functions as a manual test switch to simulate a power failure.
- **SELF TESTING:**
Unit tests itself every thirty days for one minute, thirty minutes on the sixth month and ninety minutes annually.
- **TO ORDER FOR COMPATIBLE UNIT:**
Add suffix -ID to model number
Add suffix -IDNA (for non-audible circuit) to model number.

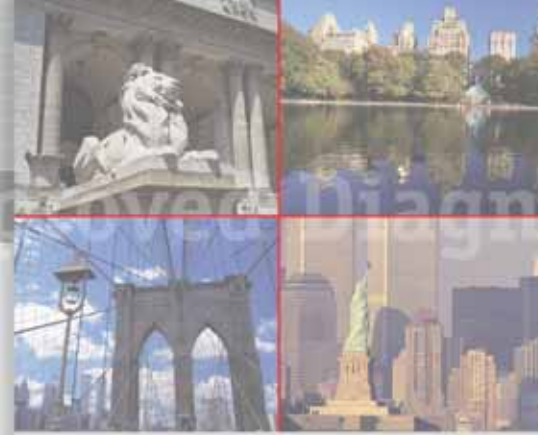



Wiring Size Guide

Determining Wire Size

The following information is provided to assist in designing proper emergency lighting systems effectively and economically by using the smallest permissible wire size for load circuits. When remote lighting fixtures and/or exit signs are connected to emergency lighting units, circuit runs must be of sufficient size to maintain a proper operating voltage to all lamps. The National Electrical Code limits voltage to drop to a maximum of 5% of nominal. The table below gives the maximum length or wire run based on systems voltage, wire gauge and total wattage on the run. **To determine the maximum length of a wire run not listed**, divide the value of the load in watts into the constant listed at the bottom of each row. Example, the maximum wire run for #10 wire on a 12 volt system, with a 54 watt load, is $3397 \div 54$ or, 62 feet.

Conversely, **to determine the maximum load on a run of known length**, divide the length into the constant. Example, a 36 foot run of #12 wire on a 6 volt systems can be loaded to, $534 \div 36$, or 14 watts; on #10 wire, 23 watts.

Total watts on wire run	WIRING DISTANCE IN FEET (Maximum Voltage Drop 5%)												
	6 volt wire size				12 volt wire size					24 volt wire size			
	#12	#10	#8	#6	#12	#10	#8	#6	#4	#12	#10	#8	#6
6	89	141	225	357	356	566	900	1431	+	1425	+	+	+
8	66	106	168	268	267	424	675	1073	1707	1068	1698	+	+
9	59	94	150	238	237	377	600	954	1517	949	1509	+	+
10	53	84	135	214	213	339	540	859	1366	854	1358	+	+
12	44	70	112	178	178	283	450	715	1138	712	1132	1801	+
16	33	53	84	134	133	212	337	536	853	534	849	1350	+
18	29	47	75	119	118	188	300	477	758	474	754	1200	1909
24	22	35	56	89	89	141	225	357	569	356	566	900	1431
25	21	33	54	85	85	135	216	343	546	341	543	864	1374
27	19	31	50	79	79	125	200	318	505	316	503	800	1272
30	17	28	45	71	71	113	180	286	455	284	452	720	1145
36	14	23	37	59	59	94	150	238	379	237	377	600	954
42	12	20	32	51	50	80	128	204	325	203	323	514	818
45	11	18	30	47	47	75	120	190	303	189	301	480	763
48	11	17	28	44	44	70	112	178	284	178	283	450	715
50	10	16	27	42	42	67	108	171	273	170	271	432	687
75	7	11	18	28	28	45	72	114	182	113	181	288	458
100	5	8	13	21	21	33	54	85	136	85	135	216	343
150	—	5	9	14	14	22	36	57	91	56	90	144	229
200	—	—	6	10	10	16	27	42	68	42	67	108	171
250	—	—	5	8	8	13	21	34	54	34	54	86	137
300	—	—	—	7	7	11	18	28	45	28	45	72	114
400	—	—	—	5	5	8	13	21	34	21	33	54	85
500	—	—	—	—	—	6	10	17	27	17	27	43	68
Constant	534	849	1350	2148	2137	3397	5403	8590	13660	8548	13588	21613	34363

Longer Wire Runs

The wiring distances give the maximum length of a battery circuit, assuming that the entire load is concentrated at the end of the circuit. If loads are uniformly spaced along the circuit path (equal watts, equal distances), the lengths in the table may be increased, based on number of fixtures on a given circuit, by means of the chart and formula below.

Number of Fixtures	2	3	4	5	6	N
Multiply Feet By	1.33	1.5	1.6	1.67	1.7	$12n/(n+1)$

For example, a 36 foot long, 6 volt circuit has (3) 9 watt heads spaced 12 feet apart. According to the wire run table, # 8 wire must be used (at 50 feet for a 5% voltage drop.) but, by multiplying the 31 feet for #10 wire by 1.5, a 46 1/2 foot wire run is acceptable, so #10 wire may be used and still meet the 5% voltage drop limitation.

Note: According to the National Electrical Code, Article 720-Y, the smallest permissible wire size for systems under 50 volts is the #12 wire gauge.

Life Safety Code

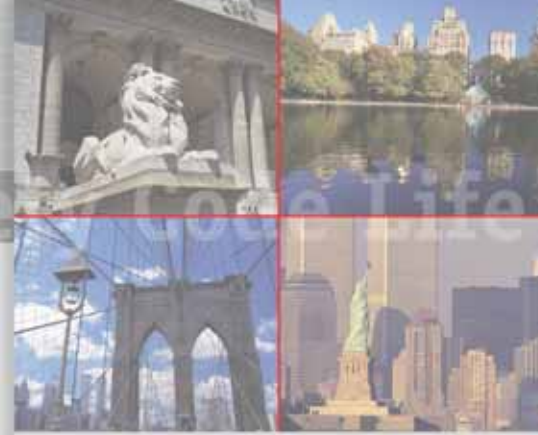

7.8 Illumination of Means of Egress.

7.8.1 General.

7.8.1.1* Illumination of means of egress shall be provided in accordance with Section 7.8 for every building and structure where required in Chapter 11 through Chapter 42. For the purposes of this requirement, exit access shall include only designated stairs, aisles, corridors, ramps, escalators, and passageways leading to an exit. For the purposes of this requirement, exit discharge shall include only designated stairs, aisles, corridors, ramps, escalators, walkways, and exit passageways leading to a public way.

7.8.1.2 Illumination of means of egress shall be continuous during the time that the conditions of occupancy require that the means of egress be available for use, unless otherwise provided in 7.8.1.2.2.

7.8.1.2.1 Artificial lighting shall be employed at such locations and for such periods of time as are necessary to maintain the illumination to the minimum criteria values herein specified.

7.8.1.3* The floors and other walking surfaces within an exit and within the portions of the exit access and exit discharge designated by 7.8.1.1 shall be illuminated as follows:

- (1) During conditions of stair use, the minimum illumination for new stairs shall be at least 10 ft-candle (108 lux), measured at the walking surfaces.
- (2) The minimum illumination for floors and walking surfaces, other than new stairs during conditions of stair use, shall be to values of at least 1 ft-candle (10.8 lux), measured at the floor.
- (3) In assembly occupancies, the illumination of the floors of exit access shall be at least 0.2 ft-candle (2.2 lux) during periods of performances or projections involving directed light.
- (4) *The minimum illumination requirements shall not apply where operations or processes require low lighting levels.

7.8.1.4* Required illumination shall be arranged so that the failure of any single lighting unit does not result in an illumination level of less than 0.2 ft-candle (2.2 lux) in any designated area.

7.8.1.5 The equipment or units installed to meet the requirements of Section 7.10 also shall be permitted to serve the function of illumination of means of egress, provided that all requirements of section 7.8 for such illumination are met.

7.8.2 Sources of Illumination.

7.8.2.1* Illumination of means of egress shall be from a source of considered reliable by the authority having jurisdiction.

7.8.2.2 Battery-operated electric lights and other types of portable lamps or lanterns shall not be used for primary illumination of means of egress. Battery-operated electric lights shall be permitted to be used as an emergency source to the extent permitted under Section 7.9

7.9 Emergency Lighting.

7.9.1 General.

7.9.1.1* Emergency lighting facilities for means of egress shall be provided in accordance with Section 7.9 for the following:

- (1) Buildings or structures where required in Chapter 11 through Chapter 42
- (2) Underground and limited access structures as addressed in Section 11.7
- (3) High-rise buildings as required by other sections of this Code
- (4) Doors equipped with delayed-egress locks

(5) Stair shaft and vestibule of smokeproof enclosures, for which the following also apply:

- (a) The stair shaft and vestibule shall be permitted to include a standby generator that is installed for the smokeproof enclosure mechanical ventilation equipment.
 - (b) The standby generator shall be permitted to be used for the stair shaft and vestibule emergency lighting power supply.
- (6) New access-controlled egress doors in accordance with 7.2.1.6.2.

7.9.1.2 For the purposes of 7.9.1.1, exit access shall include only designated stairs, aisles, corridors, ramps, escalators, and passageways leading to an exit. For the purposes of 7.9.1.1, exit discharge shall include only designated stairs, ramps, aisles, walkways, and escalators leading to a public way.

7.9.1.3 Where maintenance of illumination depends on changing from one energy source to another, a delay of not more than 10 seconds shall be permitted.

7.9.2 Performance of System.

7.9.2.1* Emergency illumination shall be provided for not less than 1-1/2 hours in the event of failure of normal lighting. Emergency lighting facilities shall be arranged to provide initial illumination that is not less than an average of 1 ft-candle (10.8 lux) and, at any point, not less than 0.1 ft-candle (1.1 lux) measured along the path of egress at floor level. Illumination levels shall be permitted to decline to not less than an average of 0.6 ft-candle (6.5 lux) and, at any point, not less than 0.06 ft-candle (0.65 lux) at the end of the 1-1/2 hours. A maximum-to-minimum illumination uniformity ratio of 40 to 1 shall not be exceeded.

7.9.2.2 New emergency power systems for emergency lighting shall be at least Type 10, Class 1.5, Level 1, in accordance with NFPA 110, *Standard for Emergency and Standby Power Systems*.

7.9.2.3* The emergency lighting system shall be arranged to provide the required illumination automatically in the event of any of the following:

- (1) Failure of public utility or other outside electrical power supply
- (2) Opening of a circuit breaker or fuse
- (3) Manual act(s), including accidental opening of a switch controlling normal lighting facilities

7.9.2.4 Emergency generators providing power to emergency lighting systems shall be installed, tested, and maintained in accordance with NFPA 110, *Standard for Emergency and Standby Power Systems*. Stored electrical energy systems where required in this Code, shall be installed and tested in accordance with NFPA 111, *Standard on Stored Electrical Energy Emergency and Standby Power Systems*.

7.9.2.5 Unit equipment and battery systems for emergency luminaires shall be listed to UL 924, *Standard for Emergency Lighting and Power Equipment*.

7.9.2.6* Existing battery-operated emergency lights shall use only reliable types of rechargeable batteries provided with suitable facilities for maintaining them in properly charged condition. Batteries used in such lights or units shall be approved for their intended use and shall comply with NFPA 70, *National Electrical Code*.

7.9.2.7 The emergency lighting system shall be either continuously in operation or shall be capable of repeated automatic operation without manual intervention.



Life Safety Code (cont'd)

7.9.3 Periodic Testing of Emergency Lighting Equipment.

7.9.3.1 Required emergency lighting systems shall be tested in accordance with one of the three options offered by 7.9.3.1.1, 7.9.3.1.2, or 7.9.3.1.3.

7.9.3.1.1 Testing of required emergency lighting systems shall be permitted to be conducted as follows:

- (1) Functional testing shall be conducted at 30-day intervals for not less than 30 seconds.
- (2) Functional testing shall be conducted annually for not less than 1-1/2 hours if the emergency lighting system is battery powered.
- (3) The emergency lighting equipment shall be fully operational for the duration of the tests required by 7.9.3.1.1 (1) and 7.9.3.1.1 (2).
- (4) Written records of visual inspections and tests shall be kept by the owner for inspection by the authority having jurisdiction.

7.9.3.1.2 Testing of required emergency lighting systems shall be permitted to be conducted as follows:

- (1) Self-testing/self-diagnostic battery-operated emergency lighting equipment shall be provided.
- (2) Self-testing/self-diagnostic, battery-operated emergency lighting equipment shall automatically perform not less than once every 30 days a test for not less than 30 seconds and a diagnostic routine.
- (3) Self-testing/self-diagnostic battery-operated emergency lighting equipment shall indicate failures by a status indicator.
- (4) A visual inspection shall be performed at intervals not exceeding 30 days.
- (5) Functional testing shall be conducted annually for not less than 1-1/2 hours.
- (6) Self-testing/self-diagnostic battery-operated emergency lighting equipment shall be fully operational for the duration of the 1-1/2 hour test.
- (7) Written records of visual inspections and tests shall be kept by the owner for inspection by the authority having jurisdiction.

7.9.3.1.3 Testing of required emergency lighting systems shall be permitted to be conducted as follows:

- (1) Computer-based, self-testing/self-diagnostic battery-operated emergency lighting equipment shall be provided.
- (2) The emergency lighting equipment shall automatically perform not less than once every 30 days a test for not less than 30 seconds and a diagnostic routine.
- (3) The emergency lighting equipment shall automatically perform annually a test for not less than 1-1/2 hours.
- (4) The emergency lighting equipment shall be fully operational for the duration of the tests required by 7.9.3.1.3(2) and 7.9.3.1.3(3).
- (5) The computer-based system shall be capable of providing a report of the history of tests and failures at all times.

7.10 Marking of Means of Egress.

7.10.1 General.

7.10.1.1 Where Required. Means of egress shall be marked in accordance with section 7.10 where required in Chapter 11 through Chapter 42.

7.10.1.2* Exits. Exits, other than main exterior exit doors that obviously and clearly are identifiable as exits, shall be marked by an approved sign that is readily visible from any direction of exit access.

7.10.1.3 Exit Door Tactile Signage. Tactile signage shall be provided to meet the following criteria, unless otherwise provided in 7.10.1.4:

- (1) Tactile signage shall be located at each exit door requiring an exit sign.
- (2) Tactile signage shall read as follows: EXIT.
- (3) Tactile signage shall comply with ICC/ANSI A117.1, *American National Standard for Accessible and Usable Buildings and Facilities*.

7.10.1.4 Existing Exemption. The requirements of 7.10.1.3 shall not apply to existing buildings, provided that the occupancy classification does not change.

7.10.1.5 Exit Access.

7.10.1.5.1 Access to exits shall be marked by approved, readily visible signs in all cases where the exit or way to reach the exit is not readily apparent to the occupants.

7.10.1.5.2* New sign placement shall be such that no point in an exit access corridor is in excess of the rated viewing distance or 100 ft (30 m), which ever is less, from the nearest sign.

7.10.1.6* Floor Proximity Exit Signs. Where floor proximity exit signs are required by Chapter 11 through Chapter 42, such signs shall be located near the floor level in addition to those signs required for doors or corridors. These signs shall be illuminated in accordance with 7.10.5. Externally illuminated signs shall be sized in accordance with 7.10.6.1. The bottom of the sign shall be not less than 6 in. (150 mm), but not more than 18 in. (455 mm), above the floor. For exit doors, the sign shall be mounted on the door or adjacent to the door, with the nearest edge of the sign within 4 in. (100 mm) of the door frame.

7.10.1.7* Floor Proximity Egress Path Marking. Where floor proximity egress path marking is required in Chapter 11 through Chapter 42, a listed and approved floor proximity egress path marking system that is internally illuminated shall be installed within 18 in. (455 mm) of the floor. The system shall provide a visible delineation of the path of travel along the designated exit access and shall be essentially continuous, except as interrupted by doorways, hallways, corridors, or other such architectural features. The system shall operate continuously or at any time the building fire alarm system is activated. The activation, duration, and continuity of operation of the system shall be in accordance with 7.9.2. The system shall be maintained in accordance with the product manufacturing listing.

7.10.1.8* Visibility. Every sign required in Section 7.10 shall be located and of such size, distinctive color, and design that it is readily visible and shall provide contrast with decorations, interior finish, or other signs. No decorations, furnishings, or equipment that impairs visibility of a sign shall be permitted. No brightly illuminated sign (for other than exit purposes), display, or object in or near the line of vision of the required exit sign that could detract attention from the exit sign shall be permitted.

7.10.1.9 Mounting Location. The bottom of new egress markings shall be located at a vertical distance of not more than 6 ft 8 in. (2030 mm) above the top edge of the egress opening intended for designation by that marking. Egress markings shall be located at a horizontal distance of not more than the required width of the egress opening, as measured from the edge of the egress opening intended for designation by that marking to the nearest edge of the marking.

7.10.2* Directional Signs. A sign complying with 7.10.3 with a directional indicator showing the direction of travel shall be placed in every location where the direction of travel to reach the nearest exit is not apparent.

7.10.3* Sign Legend.

7.10.3.1 Signs required by 7.10.1 and 7.10.2 shall read as follows in plainly legible letters, or other appropriate working shall be used:

EXIT

7.10.3.2* Where approved by the authority having jurisdiction, pictograms shall be permitted.

7.10.4* Power Source. Where emergency lighting facilities are required by the applicable provisions of Chapter 11 through Chapter 42 for individual occupancies, the signs, other than approved self-luminous signs and listed photoluminescent signs in accordance with 7.10.7.2, shall be illuminated by the emergency lighting facilities. The levels of illumination of the signs shall be in accordance with 7.10.6.3 or 7.10.7 for the required emergency lighting duration as specified in 7.9.2.1. However, the level of illumination shall be permitted to decline to 60 percent at the end of the emergency lighting duration.

Life Safety Code (cont'd)

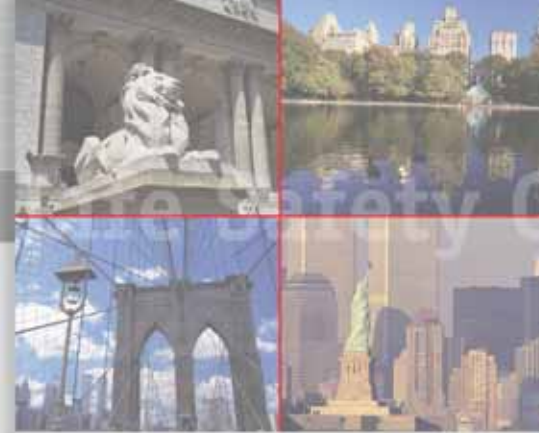

7.10.5 Illumination of Signs.

7.10.5.1* General. Every sign required by 7.10.1.2, 7.10.1.5, or 7.10.8.1, other than where operations or processes require low lighting levels, shall be suitably illuminated by a reliable light source. Externally and internally illuminated signs shall be legible in both the normal end emergency lighting mode.

7.10.5.2* Continuous Illumination.

7.10.5.2.1 Every sign required to be illuminated by 7.10.6.3, 7.10.7, and 7.10.8.1 shall be continuously illuminated as required under the provisions of Section 7.8, unless otherwise provided in 7.10.5.2.2.

7.10.6 Externally Illuminated Signs.

7.10.6.1* Size of Signs.

7.10.6.1.1 Externally illuminated signs required by 7.10.1 and 7.10.2, other than approved existing signs, unless otherwise provided in 7.10.6.1.2, shall read EXIT or shall used other appropriate wording in plainly legible letters sized as follows:

- (1) For new signs, the letters shall be not less than 6 in. (150 mm) high, with the principal strokes of letters not less than 3/4 in. (19 mm) wide.
- (2) For existing signs, the required wording shall be permitted to be in plainly legible letters not less than 4 in. (100 mm) high.
- (3) The word EXIT shall be in letters of a width not less than 2 in. (51 mm), except the letter I, and the minimum spacing between letters shall be not less than 3/8 in. (9.5 mm).
- (4) Signs legend elements larger than the minimum established in 7.10.6.1.1(1) through 7.10.6.1.1(3) shall use letter widths, strokes, and spacing in proportion to their height.

7.10.6.1.2 The requirements of 7.10.6.1.1 shall not apply to marking required by 7.10.1.3 and 7.10.1.6.

7.10.6.2* Size and Location of Directional Indicator.

7.10.6.2.1 Directional indicators, unless otherwise provided in 7.10.6.2.2, shall comply with the following:

- (1) The directional indicator shall be located outside of the EXIT legend, not less than 3/8 in. (9.5 mm) from any letter.
- (2) The directional indicator shall be of a chevron type, as shown in Figure 7.10.6.2.1.
- (3) The directional indicator shall be identifiable as a directional indicator at a distance of 40 ft (12 m).
- (4) A directional indicator larger than the minimum established for compliance with 7.10.6.2.1(3) shall be proportionately increased in height, width, and stroke.
- (5) The directional indicator shall be located at the end of the sign for the direction indicated.



Figure 7.10.6.2.1 Chevron-Type Indicator.

7.10.6.2.2 The requirements of 7.10.6.2.1 shall not apply to approved existing signs.

7.10.6.3* Level of Illumination. Externally illuminated signs shall be illuminated by not less than 5ft-candles (54 lux) at the illuminated surface and shall have a contrast ratio of not less than 0.5.

7.10.7 Internally Illuminated Signs.

7.10.7.1 Listing. Internally illuminated signs shall be listed in accordance with UL 924, *Standard for Emergency Lighting and Power Equipment*, unless they meet one of the following criteria:

- (1) They are approved existing signs.
- (2) They are existing signs having the required wording in legible letters not less than 4 in. (100 mm) high.
- (3) They are signs that are in accordance with 7.10.1.3 and 7.10.1.6.

7.10.7.2* Photoluminescent Signs. The face of a photoluminescent sign shall be continually illuminated while the building is occupied. The illumination levels on the face of the photoluminescent sign shall be in accordance with its listing. The charging illumination shall be a reliable light source as determined by the authority having jurisdiction. The charging light source shall be of a type specified in the product markings.

7.10.8 Special Signs.

7.10.8.1 Sign Illumination.

7.10.8.1.1 Where required by other provisions of this Code, special signs shall be illuminated in accordance with 7.10.5, 7.10.6.3, and 7.10.7.

7.10.8.1.2 Where emergency lighting facilities are required by the applicable provisions of Chapter 12 through Chapter 42, the required illumination of special signs shall additionally be provided under emergency lighting conditions.

7.10.8.2 Characters. Special signs, where required by other provisions of this Code, shall comply with the visual character requirements of ICC/ANSI A117.1, *American National Standard for Accessible and Usable Buildings and Facilities*.

7.10.8.3* No Exit.

7.10.8.3.1 Any door, passage, or stairway that is neither an exit nor a way of exit access and that is located or arranged so that it is likely to be mistaken for an exit shall be identified by a sign that reads as follows.

**NO
EXIT**

7.10.8.3.2 The NO EXIT sign shall have the word NO in letters 2 in. (51 mm) high, with a stroke width of 3/8 in. (9.5 mm), and the word EXIT in letters 1 in. (25 mm) high, with the word EXIT below the word NO, unless such sign is an approved existing sign.

7.10.9 Testing and Maintenance.

7.10.9.1 Inspection. Exit signs shall be visually inspected for operation of the illumination sources at intervals not to exceed 30 days or shall be periodically monitored in accordance with 7.9.3.1.3.

7.10.9.2 Testing. Exit signs connected to or provided with a battery-operated emergency illumination source, where required in 7.10.4, shall be tested and maintained in accordance with 7.9.3.

*NFPA 101® Life Safety Code® 2006 Edition
©2005, NFPA, All Rights Reserved
Life Safety Code® and NFPA 101® are registered trademarks
of the National Fire Protection Association, Inc.*

Limited Warranty

- 1.0 **Lightalarms** 6, 12 and 24 volt Emergency Lighting Unit Equipment (excluding lamps and fuses) are fully warranted to be free of defects in material and workmanship under normal use for a period of three years from date of installation (see Paragraph 2.0).
- 1.1 **Lightalarms** 6, 12 and 24 volt Unit Equipment Batteries are warranted as follows (Warrant below includes the 3-year full warranty on entire unit as called out in Paragraph 1.0).
- 1.2 **Lightalarms** 4 volt Emergency Lighting Unit Equipment (excluding lamps, and fuses) is fully warranted to be free of defects in material and workmanship under normal use for a period of one year from date of installation (see Paragraph 2.0).

BATTERY TYPE	LIFE EXPECTANCY	SHELF LIFE*	FULL WARRANTY	PRO RATA WARRANTY
Sealed Lead-Calcium	8 years	6 months	3 years	3 years
Sealed Lead-Calcium (Immobilized Electrolyte)	12 years	6 months	5 years	5 years
Sealed Long Life Lead	12 years	6 months	5 years	5 years
Sealed Nickel-Cadmium	15 years	1 year	5 years	7 years
Refillable Lead-Calcium	15 years	6 months	3 years	8 years
Refillable Nickel-Cadmium	15 years	2 years	5 years	7 years

***MAXIMUM STORAGE LIFE. MUST BE RECHARGED IF NOT PLACED IN SERVICE OR BATTERY WARRANTY VOID**

- 2.0 The full warranty period begins on the date of installation or 90 days from date of shipment, whichever date is earlier.
- 2.1 Should a defect appear in the equipment or batteries listed in Paragraphs 1.0, 1.1 or 1.2 above within the specified full warranty period, Lightalarms will repair or replace equipment without charge (see Paragraph 3.3). Such repair or replacement shall be the purchaser's exclusive remedy.
- 2.2 The Pro-rata Warranty Period for batteries begins on the date the full warranty period ends.
- 2.3 A battery determined to be defective during the Pro Rata Warranty Period shall be repaired or replaced at a cost equal to the net price in effect at the time, reduced by the percentage obtained in multiplying 10% by the number of full years remaining in the total warranty period. Such repair or replacement at this adjusted price shall be the purchaser's exclusive remedy.
- 3.0 All warranties are subject to proper installation and maintenance in accordance with the instructions supplied.
- 3.1 Any material deemed defective must be returned, freight prepaid, to the factory for evaluation (see Paragraph 5.0-5.3). Any changes in circuitry or components by other than authorized Lightalarms personnel or its service companies will void the warranty.
- 3.2 All warranties are limited to the repair and/or replacement or parts or equipment, which, upon examination at our plant, are determined to be defective and in our judgement are subject to repair or replacement under warranty. Replacement of lamps and fuses is not included in the warranty.
- 3.3 If new replacement parts are shipped before defective goods are received for evaluation, the replacement parts will be invoiced at the net price in effect at that time. These charges will be credited if, upon receipt and evaluation of goods, a defect is determined. Only replacement parts will be shipped under these circumstances, if field replacement is possible. **Lightalarms FACTORY ONLY RESERVES THE RIGHT TO SHIP NEW UNIT EQUIPMENT FOR REPLACEMENT PURPOSES.** Units returned after installation cannot be restored to 100% saleable condition.
- 4.0 In no event shall Lightalarms be liable for backcharges of any kind, including, without limitation, labor charges for field repair or late penalties.
- 4.1 This warranty does not cover damages caused by improper maintenance of installation or damage due to installation in areas with other than normal temperatures and environmental conditions per application specifications. Lightalarms assumes no responsibility for any damage to people, property, apparatus or otherwise resulting from improper installation or maintenance of its Emergency Lighting Unit Equipment.
- 4.2 This warranty does not cover damages caused by abuse, fire or Act of God.
- 4.3 In no event shall Lightalarms be liable for incidental or consequential damages.
- 4.4 The foregoing warranty is in lieu of all other warranties, expressed or implied, or merchantability, fitness for a particular purpose or any other thing. Except as stated in this warranty, Lightalarms shall not be liable for any defects in, or breach of any contract relating to, the quality of performance of Lightalarms Equipment under any theory of law including, without limitation, contract, negligence, strict liability or misrepresentation.
- 4.5 Lightalarms warranty coverage shall not apply to any equipment of another manufacturer used in conjunction with Lightalarms Equipment.
- 4.6 Some states do not allow limitation on how long an implied warranty lasts, so the above limitation may not apply to you. Some states do not allow the exclusion or limitation of incidental or consequential damages, so the above limitation or exclusion may not apply to you. This written warranty gives you specific legal rights and you may also have other rights which vary from state to state.
- 5.0 No returned defective materials will be accepted without a Returned Goods Authorization issued in writing by an authorized Lightalarms employee.
- 5.1 Purchaser is responsible for secure packing of returned materials to provide best possible assurance against damage in shipment.
- 5.2 Defective batteries of any kind must not be returned to Lightalarms's factory without strict adherence to special instructions for handling and shipping. WARNING Never ship a refillable wet battery in any type of emergency lighting equipment. Failure to adhere to this policy will void warranty.
- 5.3 Defective goods returned to the factory must be shipped prepaid. COLLECT RETURNED SHIPMENT WILL BE REFUSED. Freight charges to return repaired equipment or ship replacement equipment to the purchaser to be paid by Lightalarms. Factory will return repaired goods via same shipping method as received.

FAILURE TO COMPLY WITH ANY OF THE STIPULATIONS SET FORTH WILL VOID THE WARRANTY.

ANY EXCEPTIONS TO THE FOREGOING WARRANTY MUST BE REQUESTED AND ACCEPTED IN WRITING PRIOR TO SHIPMENT.

LIGHTALARMS EQUIPMENT NOT LISTED IN PARAGRAPHS 1.0, 1.1 OR 1.2 IS WARRANTED AS DESCRIBED

ON ITS INDIVIDUAL DATA SHEET WITH THE STIPULATIONS AS STATED IN PARAGRAPHS 2.0-5.3.