

## ■ Decorative Series

Phantom Series <i>(NEW &amp; Improved Design)</i> ....	8-9
Mini-Phantom Series <i>(NEW)</i> .....	10-11
Camray Series <i>(NEW)</i> .....	12-13
TBR Series .....	14
RD Series .....	15
605P1 Series .....	16
RSTH Decorative Series .....	17
Square-Lite, SQ, SQ-D Series .....	18
Sunspec Series <i>(Discontinued)</i> .....	19
Gloweye Series <i>(Discontinued)</i> .....	20
Permanence Series <i>(Discontinued)</i> .....	21

## ■ Phantom Series

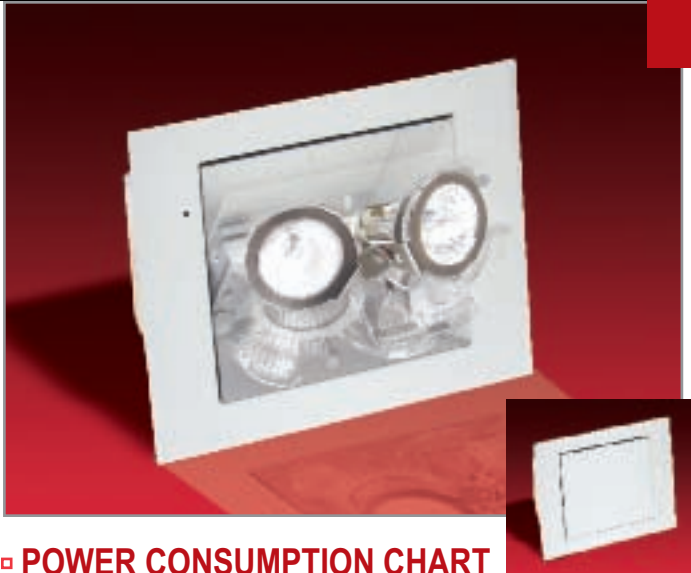

### ■ POWER CONSUMPTION CHART

AC Input	Maximum		Stand-By*	
	Input Current	Input Power	Input Current	Input Power
120 Vac	0.25 A	30W	0.1 A	11W
120 Vac	0.12 A	30W	0.05 A	11W

\* Stand-by power consumption is 50% lower for Lead-Calcium batteries

### ■ UNIT RATING CHART

Model	Watts to 87.5% of rated battery voltage*			
	1 1/2 hrs.	2 hrs.	4 hrs.	8 hrs.
PHM40, PHN40	40	30	24	-
PHM70, PHN70	70	50	40	24
PHM100, PHN100	100	70	50	40

\* National Electrical Code Specification

### ■ OPTIONS

(Add Suffix to Model No.)	Suffix
Damp location listing (available on all models except PHN100).....	DL
Improved diagnostic (audible) .....	ID
Improved diagnostic (non-audible) .....	IDNA
Time delay (T1=5, T2=10, or T3=15 minutes).....	T_*

\*\* (ID or IDNA) includes a Time Delay function, if needed it can be enabled/disabled in the field or it can be preset at the factory by including the suffix ID-T\_ or IDNA-T\_

### ■ ACCESSORIES (order as a separate item)

Remote test switch (Metal Faceplate): .....	PSW
Remote test switch (Plastic Faceplate): .....	PSW-1

## New and Improved Design

### THE UNSEEN SOLUTION

#### Virtually Invisible Emergency Lighting

The Phantom Series is architecturally designed for unobtrusive use in walls with cavity (dry walls with 4-inch studs) or un-insulated ceilings with horizontal beams or T-bar structures. In normal conditions (stand-by) the unit is completely concealed in the wall or ceiling. In case of power failure the door of the unit rotates open 180° and exposes the emergency lights (two high-efficiency MR16 lamps) to illuminate the path of egress.

Once AC power returns or at the end of discharge period, the lights turn off and the door rotates closed automatically, driven by a patent-pending, energy storage circuit. If needed the backbox can be shipped separately.

For remote head, please refer to page 98.

### ■ FEATURES

#### Reliability

Each unit is fully computer-tested and aligned mechanically for optimum operation. The electrical parts (motor, electronic circuitry) carry a five-year warranty.

#### Unit Data

The normally exposed parts of the unit (flat door and frame) are covered with a high-quality, powder coated textured off-white finish, which integrates well with most wall and ceiling paints. The surface finish can also be customized on site with paint, wallpaper or other coverings. The self-powered battery unit is contained in a heavy-duty galvanized steel back-box, concealed in the wall or ceiling and includes a combined test switch and pilot light, accessible through the frame. Special bar hangers for installation in sheet rock or T-bar ceilings are included in the package. The module includes the electrical junction box and is installed on the wall stud or ceiling beam with the help of a simple, U-shape bracket. Each unit comes standard with two (2) MR-16 halogen lamps, of specified power ranging from 12W to 50Watts each.

#### PulsePlus Battery Charger

The charger circuitry offers a 120/277 Vac 60 Hz, 0.25/0.12 Amp, automatic charger, built around a micro-controller integrated circuit. Circuit standard features: current limiting, temperature-compensated cut-off voltage, brown-out transfer, low-voltage battery disconnect and battery lockout (Prevents activation in the d.c. mode until initial a.c. activation).

#### Power Requirements

120/277Vac, 60Hz, 0.25/0.12 Amp

### ■ IMPROVED DIAGNOSTIC (Optional)

This micro-controller circuitry is optional on all self-powered battery units. This circuitry is programmed to ensure the equipment readiness and reliability by continuously monitoring every critical function of the unit. If a problem occurs, the pilot light located on the front of the unit, will change color from solid green to a flashing red light, indicating a fault. A detailed diagnostic legend is available on the door back side and provides fault identification (battery, charger circuitry, lamps) for the maintenance personnel. The self-test feature will simulate a power loss for minimum 30 seconds every 30 days, 30 minutes every six months and 90 minutes annually.

## DIMENSIONS

Dimensions are approximate and subject to change.

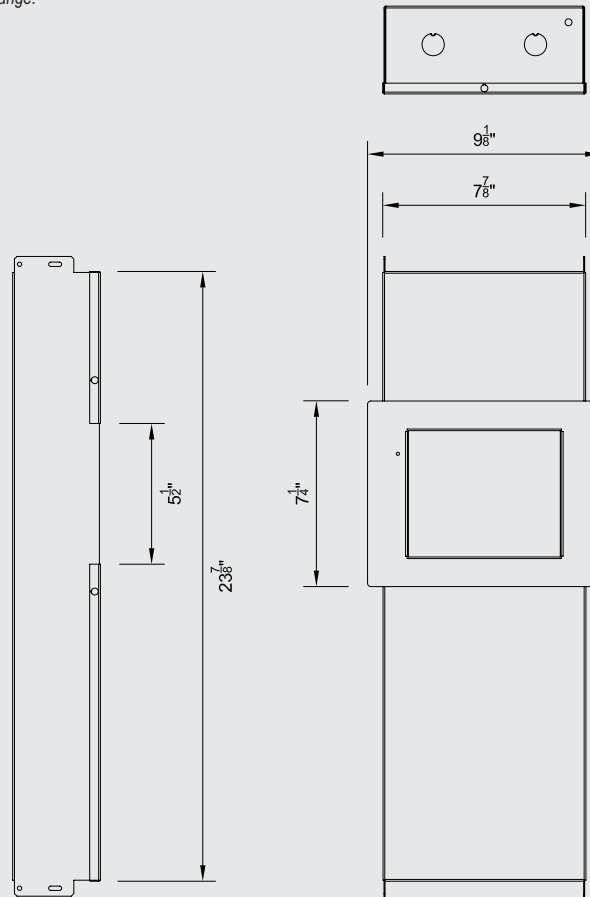

### Charger & Battery Compartment:

For use in walls or ceilings with a cavity, not for use in block walls or solid ceilings.

## ORDERING FORMAT

Battery Unit	PH	M	100	-2(20)	DL
	Series	Battery Type	Unit Capacity	LampWattage	Options
		M= Lead-Calcium	40= 12V, 40W	-2(12)= 12W, MR16 each head	ID= improved diagnostic, audible
		N= Nickel-Cadmium	70= 12V, 70W	-2(20)= 20W, MR16 each head	IDNA= improved diagnostic, non-audible
			100= 12V, 100W	-2(35)= 35W, MR16 each head	T1= time delay 5 minutes
				-2(50)= 50W, MR16 each head	T2= time delay 10 minutes
				-2 (20H)= 20W, MR16 high lumen output	T3= time delay 15 minutes
				-2 (35H)= 35W, MR16 high lumen output	DL= damp Location*
				-2 (50H)= 50W, MR16 high lumen output	X= Backbox Shipped separate
					*DL Damp Location option is available on all models except PHN100.

Generator Unit	PHG	1	-2	(20)
	Series	Input Voltage	# of Lamp	LampWattage*
	PHG	1= 120 Vac, 60 HZ	-2= Two lamp	(12)= 12W, each head
		2= 277 Vac, 60 HZ		(20)= 20W, each head
				(35)= 35W, each head
				(50)= 50W, each head
				(20H)= 20W, MR16 high lumen output
				(35H)= 35W, MR16 high lumen output
				(50H)= 50W, MR16 high lumen output

## ■ Mini-Phantom Series



The Next Generation of concealed emergency lighting: smaller size, full retrofit, impressive illumination of the egress.

Evaluated to UL 924 Standard

The **Mini-Phantom Series** from **Lightalarms** is the next generation of concealed emergency lighting equipment, specially designed for retrofitting in finished walls with a cavity (dry-walls with 4-inch studs). In normal conditions (stand-by) the unit is completely concealed in the wall.

### ▣ FEATURES

#### Reliability

Each unit is fully computer-tested and aligned mechanically for optimum operation. The electrical parts (motor, electronic circuitry) carry a five-year warranty.

#### Unit Data

The normally exposed parts of the unit (flat door and frame) are covered with a high-quality, powder coated textured off-white finish, which integrates well with most wall and ceiling paints. The surface finish can also be customized on site with paint, wallpaper or other coverings. The self-powered battery unit is contained in a heavy-duty galvanized steel back-box, concealed in the wall or ceiling and includes a combined test switch and pilot light, accessible through the frame. The module includes the electrical junction box and is installed on the wall stud or ceiling beam with the help of a simple, U-shape bracket. Each unit comes standard with two (2) MR-16 halogen lamps

#### PulsePlus Battery Charger

The charger circuitry offers a 120/277 Vac 60 Hz, 0.25/0.12 Amp, automatic charger, built around a micro-controller integrated circuit. Circuit standard features: current limiting, temperature-compensated cut-off voltage, brown-out transfer, low-voltage battery disconnect and battery lockout (Prevents activation in the d.c. mode until initial a.c. activation).

#### Power Requirements

120/277Vac, 60Hz, 0.25/0.12 Amp

### ▣ IMPROVED DIAGNOSTIC (Optional)

This micro-controller circuitry that will ensure the equipment readiness and reliability by continuously monitoring every critical function of the unit. If a component failure occurs, the pilot light located on the front of the unit, will change color from green to red and will flash indicating a fault. A detailed diagnostic legend shall be available on the back side of the door and shall provide fault identification (battery, charger circuitry, lamps) for the maintenance personnel. The self-test shall simulate a power loss for minimum 30 seconds every 30 days, 30 minutes every six months and 90 minutes annually.

### ▣ POWER CONSUMPTION CHART

Model	AC Input	Maximum		Stand-By (Ni-Cd, NiMH)*	
		Input Current	Input Power	Input Current	Input Power
MPH_40	120 Vac	0.25 A	30 W	0.1 A	11 W
	277 Vac	0.12 A	30 W	0.05 A	11 W
MPHG	120 Vac	0.95 A	110 W**	-	-
	277 Vac	0.45 A	110 W**	-	-

\* Stand-by power consumption is 50% lower for Lead-Calcium batteries

\*\* Maximum power when equipped with 2 x 50W lamps (generator unit)

### ▣ UNIT RATING CHART

Model	Watts to 87.5% of rated battery voltage*			
	1 1/2 hrs.	2 hrs.	3 hrs.	4 hrs.
MPH_40	40	30	24	-

\* National Electrical Code Specification

### ▣ OPTIONS

(Add Suffix to Model No.)	Suffix
Damp location listing (available on all models except PHN100).....	DL
Improved diagnostic (audible) .....	ID
Improved diagnostic (non-audible) .....	IDNA
Time delay (T1=5, T2=10, or T3=15 minutes) .....	T_*

\*\* (ID or IDNA) includes a Time Delay function, if needed it can be enabled/disabled in the field or it can be preset at the factory by including the suffix ID-T\_ or IDNA-T\_

## ▣ DIMENSIONS

Dimensions are approximate and subject to change.

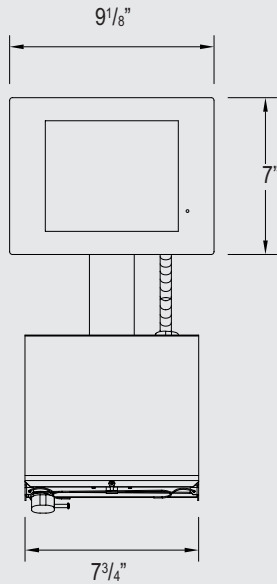

Complete Unit

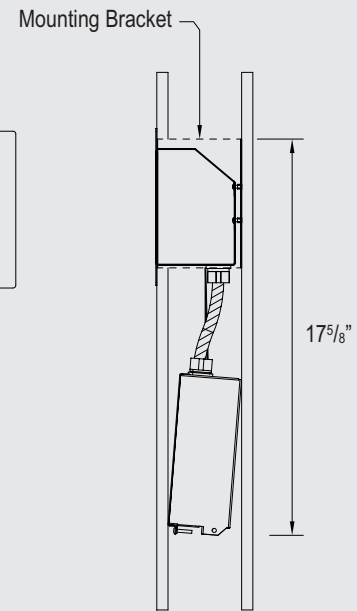
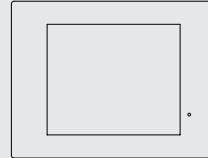
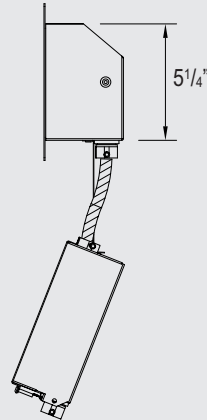

Installed Unit

## ▣ ORDERING FORMAT

	MPH	M	40	-2(20)	DL
Battery Unit	<b>Series</b>	<b>Battery type</b>	<b>Unit Capacity</b>	<b>Lamp Wattage (12V MR16)</b>	<b>Options</b>
	MPH	M= Lead-Calcium N= Nickel-Cadmium H= Nickel-Metal Hydride	40= 12V, 40 watts	-2 (12)= 12 watts each head -2 (20)= 20 watts each head -2 (20H)= 20 watts, high lumen output	ID= improved diagnostic IDNA= improved diagnostic, non-audible T1= time delay 5 min T2= time delay 10 min T3= time delay 15 min DL= damp location (only MPH40, MPH40)
Generator Unit	<b>Series</b>	<b>Battery type</b>	<b>Unit Capacity</b>	<b>AC input</b>	<b>Lamp Wattage (12V MR16)</b>
	MPH	G= Remote AC generator	Blank= max. 100W	1= 120 Vac 2= 277 Vac	-2 (12)= 12 watts each head -2 (20)= 20 watts each head -2 (35)= 35 watts each head -2 (50)= 50 watts each head -2 (20H)= 20 watts, high lumen output -2 (35H)= 35 watts, high lumen output -2 (50H)= 50 watts, high lumen output
					<b>Options</b> DL= damp location

## ■ Camray Series



### A combination of Style & Performance

The **Camray Series** combines the photometrical performance to a visually appealing design.

An efficient reflector combined with two Xenon lamps deliver an incredible center-to-center spacing.

The die-cast aluminum housing is offered in a wide range of colors to complement any interior. It will blend with the most sophisticated decor.

With it's fully gasket housing, the **Camray Series** is also ideal for extreme outdoor environments.

Designed to meet the needs of architects and designers without sacrificing safety, this fixture is available in a widerange of colors to complement any interior.

## ▣ FEATURES

### Reliability

The **Camray Series** comes complete with a 3-year full warranty (excluding lamps and fuses).

### Unit Data

The **Camray** units are made of durable cast aluminum housing, finish with textured polyester powder coat paint. Four colors are available: off white, black, platinum gray and dark bronze. The vacuum-plated die-cast reflector will last over time. The lens is made of an impact and UV resistant polycarbonate.

Units can be installed on various J-box with the universal mounting pattern. It can also be surface mount using the rigid conduit entry provision on the top of the unit.

### Lamp information

The **Camray** units are furnished with two high-output Xenon lamps. These lamps, combined with a patent pending reflector, deliver an incredible center-to-center spacing. The reflector has been designed to provide an evenly distributed illumination pattern for corridors, up to 6' wide.

### Charger

All self-powered battery units come with a 120/277Vac, 60Hz., dual input voltage. Chargers also include low voltage disconnect to prevent deep discharge, battery lockout to prevent battery drain prior to energizing the utility power, brownout protection which will automatically switch unit into emergency mode if the utility power sages below 80% of nominal and battery reverse polarity protection.

**Lead-Calcium Models** are equipped with the Pulse Plus circuitry that will promote long reliable battery life and excellent performance. This current limiting charger will minimize energy consumption.

**Nickel Metal Hydride Models** are equipped with the non-audible version of the Improved Diagnostics circuit. It will also monitor and indicate any of the following failures: battery disconnect, battery, charger and lamp failures. The unit will perform a periodical self-test, of minimum 30 seconds every 30 days, 30 minutes every six months and 90 minutes annually.

### Controls or electrical

- Lead-Calcium Models: green LED indicates AC power is on.
- Nickel Metal Hydride Models: bi-color LED indicates battery state of charge, test activation and four-state diagnostic status.
- Test switch allows for quick operational check of the entire system.

### Power Requirements

120/277Vac, 60Hz, 0.11/0.05 Amp

## ▣ OPTIONS

The **Camray Series** is offered in five different configurations. It can be used in a wide range of applications, environments:

- CAM Remote head: UL listed for damp, wet and cold locations. Operating temperature: -40 °C to +60 °C (-40°F to +140°F) See page 98.
- CAML Regular interior package: cost efficient solution equipped with Lead-Calcium battery.
- CAMN Exterior package: designed for a wide range of temperature. UL listed for wet and cold location. Equipped with NiMH battery. Operating temperature: -20 °C to +40 °C (-4°F to + 104°F)
- CAMN2 High output package: ideal for interior applications where the photometrical performance the 10W Xenon lamps is required. Equipped with NiMH battery, UL listed for operating temperature: +20 °C to +30 °C (+68°F to +86°F)



## ▣ DIMENSIONS

Dimensions are approximate and subject to change.

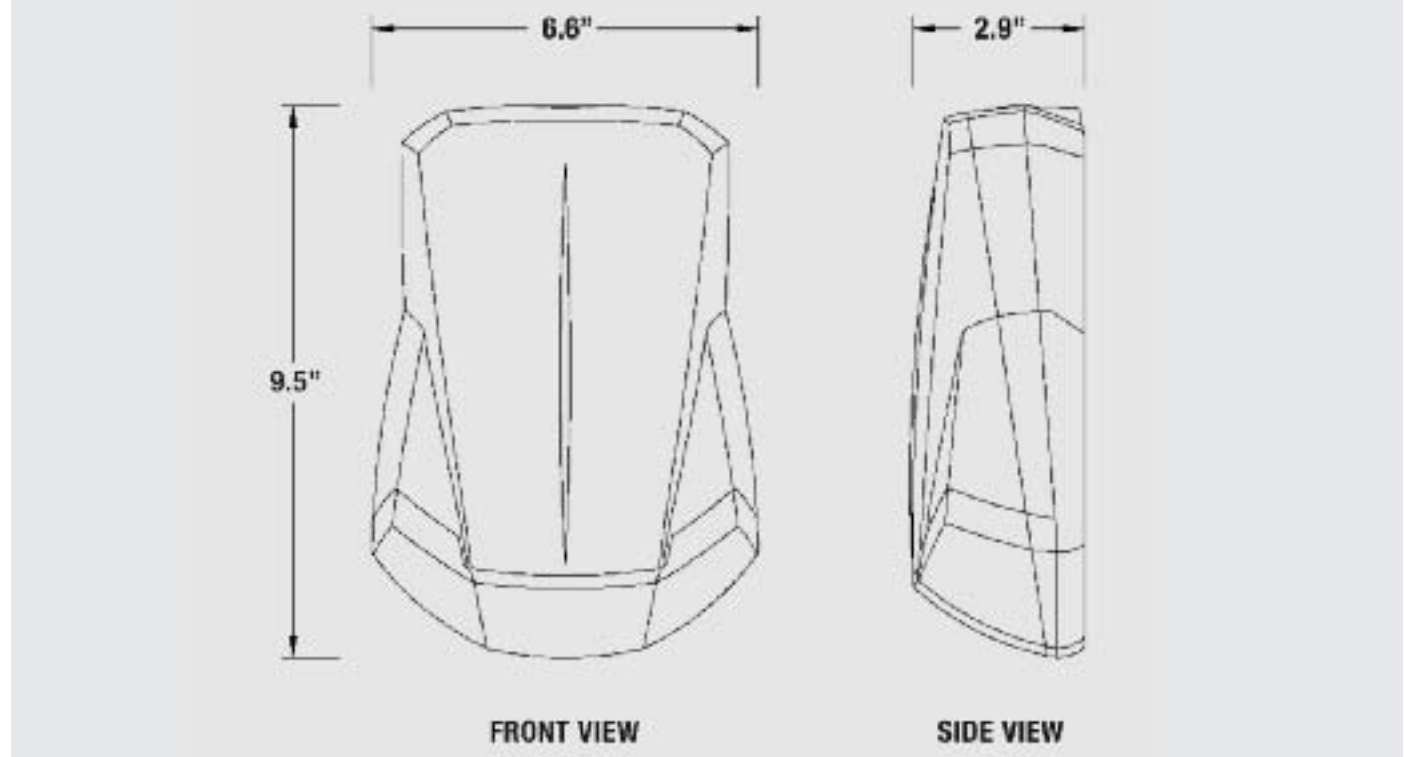

## ▣ ISO CURVE

Lamp Type	Mounting height	Center-to-center	
		A=3'	A=6'
2 X 6W	7.5'	B=28'	B=19'
	8.5'	B=25'	B=18'
2 X 10W	7.5'	B=30'	B=28'
	8.5'	B=34'	B=30'

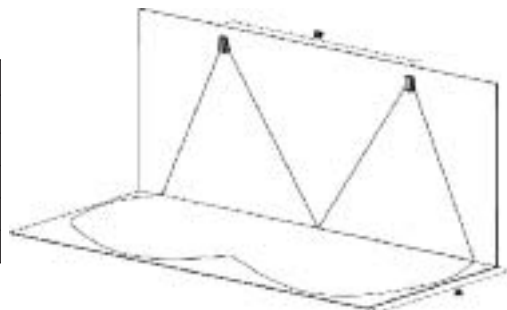

**Note:** Photometric results shown are based on a simulation using the AGI32 software with a 1 foot-candle average and 0.1 foot-candle minimum with a 40:1 maximum ratio. Lightalarms assumes no responsibility for local requirements or specific project variable. This is a guideline to be used as a design aid, not guarantee of any code compliance.

## ▣ ORDERING FORMAT

CAML	/LX6	-OW	T1
Series	Lamp Wattage*	Color	Options
<b>CAML</b> = 6V - 12W, lead calcium (+20°C to +30°C) std charger <b>CAMN</b> = 6V - 12W, NiMH (-20°C to +40°C) comes standard with IDNA <b>CAMN2</b> = 6V - 20W, NiMH (+20°C to +30°C) comes standard with IDNA	<b>/LX6</b> = 6V-6W <b>/LX10</b> = 6V 10W**	<b>-OW</b> = off white <b>-B</b> = black <b>-DB</b> = dark bronze <b>-PG</b> = Platinum gray	<b>-T1</b> = 5 minutes <b>-T2</b> = 10 minutes <b>-T3</b> = 15 minutes
<i>*Xenon wedge base T3-1/4</i> <i>**Only available in CAMN2.</i>		<i>other colors available.</i> <i>consult the factory.</i>	<i>Note: time-delay available only with IDNA CAMN and CAMN2 units.</i>  <b>Limited Warranty</b> LD-CA battery 3 years NiMH battery 5 years

## ■ TBR Series



### ▣ DIMENSIONS

Dimensions are approximate and subject to change.

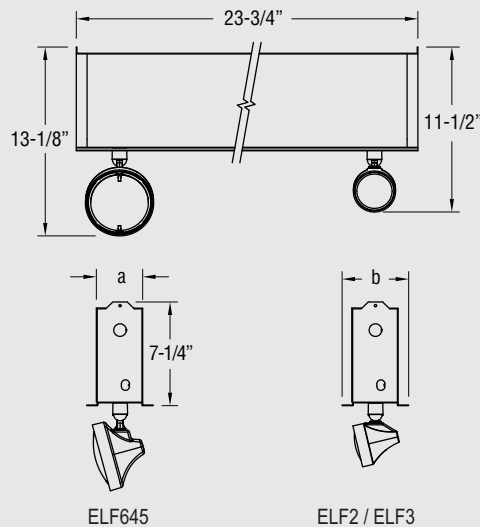

Cabinet	a	b
S	3-1/4"	4-5/8"
L	5-5/8"	7-1/8"

### 6 or 12-Volt Decorative Style T-Bar Unit Maintenance-Free Lead-Calcium or Nickel-Cadmium Battery

#### UL Listed

The **TBR Series** battery units are designed for T-Bar ceiling grid installation. This slim-line, unobtrusive unit is ideally suited for any commercial location where there is limited wall space and where the greater directional flexibility of ceiling-mounted heads is needed to provide greater distribution.

### ▣ FEATURES

#### Reliability

The **TBR Series** has a three-year full warranty (excluding lamps and fuses).

#### Unit Data

The TBR Cabinet is constructed of rugged steel with corrosion-resistant undercoating. Fixtures, cabinet and mounting brackets are available in mist white and black. Battery and charger are concealed above the ceiling level in the unit cabinet. The back box has a removable panel allowing easy access to battery and circuitry. Units mount quickly and easily in standard T-Bar grids without additional hardware. The TBR unit has provisions for mounting up to three lamp heads.

#### Lamp

Standard with two ELF645 PAR36 high impact mar-resistant thermoplastic heads. Furnished with two 6 or 12 volt 9 watt high intensity wedge base incandescent lamps\*. Other lighting head styles are also available see options. Do not exceed unit battery capacity.

\* Note: For optional lamp types and wattages refer to the lamp data chart on page 108-109.

#### PulseType Charger

- Automatic, temperature compensated, pulse type charger.
- High capacity, automatic, dust-tight instantaneous transfer relay.
- Low voltage disconnect prevents overdischarge of battery. Automatic brownout protection is provided.
- Labor saving AC line latch prevents battery discharge during installation to a non-energized circuit.
- Fused output circuit.

#### Controls

- Red charger monitor LED indicates the state of charge of the battery.
- Amber AC-ON LED indicates AC power is on.
- Momentary test switch allows for quick operational check of entire system.

#### Power Requirements

120/277Vac, 60Hz, 0.3/0.15 Amp

### ▣ UNIT RATING CHART

Volts	Model # (Unit/Lamp Suffix)	*Watts to 87 1/2% of Rated Battery Voltage				Watts/ Head	Cabinet Size
		1 1/2 hrs	2 hrs	3 hrs	4 hrs		
6	2TBRC1/L9	27	20	14	10	9	S
	2TBRC2/L9	54	36	25	18	9	S
	2TBRC3/L9	81	48	33	24	9	L
12	2T12BRC2/L9	54	36	25	18	9	S

\* National Electrical Code Specification

### ▣ ACCESSORIES

(Order as a separate item)

Remote Test Switch (Metal faceplate).....PSW  
Remote Test Switch (Plastic faceplate).....PSW1

### ▣ ORDERING FORMAT

2	TBR	C	1	/L9	-V
No. of Heads	Series	Battery Type	Capacity Indicator	Lamp Suffix 6V 9W Incandescent	Option Voltmeter

### ▣ Head & Lamp Type Options

No heads .....	0
Double contact bayonet base, Bi-Pin Halogen,	
Wedge base, Sealed Beam Lamps .....	/ELF 645
Bi-Pin Halogen lamps.....	/ELF 2
MR16 lamps up to 20 watts .....	/ELF 3
MR16 lamps .....	/DR1130

### ▣ OPTIONS

(Add Suffix to Model No.)	Suffix
Black Housing and Heads.....	-B
Ammeter or Voltmeter (choose only one) .....	-A* or -V*
Improved Diagnostics (audible) .....	-ID
Improved Diagnostics (non-audible) .....	-IDNA
Time Delay (specify 5, 10 or 15 minutes) .....	-TD**
Nickel-Cadmium Battery .....	-N

\*Not available with diagnostic option

\*\* (ID or IDNA) includes a Time Delay function, if needed it can be enabled/disabled in the field or it can be preset at the factory by including the suffix ID-TD\_ or IDNA-TD\_



## RD Series

### 6 or 12-Volt Decorative Style Recessed Unit

#### Maintenance-Free Lead-Calcium or Nickel-Cadmium Battery

#### UL Listed

The **RD Series** battery units are designed for fully recessed installation in walls or ceilings. Models are available with two ELF645 heads standard, or two ELF2, ELF3 or DR1130 heads optional, to accent any décor.

### FEATURES

#### Reliability

The **RD Series** has a three-year fully warranty (excluding lamps).

#### Unit Data

The RD Series Cabinet is constructed of 20-gauge steel with an off-white baked enamel finish. Fixtures, cabinet and mounting brackets are available in mist white and black. Mounting brackets are included for installation in grid type suspended ceilings. Adjustable bar hangers are included, although this unit can be framed into sheet rock ceilings, studs or joints as well.

#### Lamp

Standard with two ELF645 PAR36 high impact mar-resistant thermoplastic heads. Furnished with two 6 or 12 volt 9 watt high intensity wedge base incandescent lamps\*. Other lighting head styles are also available see options. Do not exceed unit battery capacity.

\* Note: For optional lamp types and wattages refer to the lamp data chart on page 108-109.

#### PulseType Charger

- Automatic, temperature compensated, pulse type charger.
- High capacity, automatic, dust-tight instantaneous transfer relay.
- Low voltage disconnect prevents overdischarge of battery. Automatic brownout protection is provided.
- Labor saving AC line latch prevents battery discharge during installation to a non-energized circuit.
- Fused output circuit.

#### Controls

- Red charger monitor LED indicates state of charge of the battery.
- Amber AC-ON LED indicates AC power is on.
- Momentary test switch allows for quick operational check of entire system.

#### Power Requirements

120/277Vac, 60Hz, 0.3/0.15 Amp

### Head & Lamp Type Options

No heads .....	0
Double contact bayonet base, Bi-Pin Halogen, Wedge base, Sealed Beam Lamps .....	/ELF 645
Bi-Pin Halogen lamps .....	/ELF 2
MR16 lamps up to 20 watts .....	/ELF 3
MR16 lamps .....	/DR1130

### OPTIONS

(Add Suffix to Model No.)	Suffix
Black .....	-B
Ammeter or Voltmeter (choose only one) .....	-A* or -V*
Improved Diagnostics (audible) .....	-ID
Improved Diagnostics (non-audible) .....	-IDNA
Time Delay (specify 5, 10 or 15 minutes) .....	-TD**
Non-Standard Input Voltage .....	Specify

\*Not available with diagnostic option

\*\* (ID or IDNA) includes a Time Delay function, if needed it can be enabled/disabled in the field or it can be preset at the factory by including the suffix ID-TD\_ or IDNA-TD\_

### ACCESSORIES

(Order as a separate item)

Wire Guard (DR1130, ELF2, ELF3 or ELF645 heads) .....	WG6-L
Remote Test Switch (Metal faceplate) .....	PSW
Remote Test Switch (Plastic faceplate) .....	PSW1



### UNIT RATING CHART

Standard lamp is 6 or 12 volt 9 watt wedge base.

UNIT EQUIPMENT - NO REMOTE CAPABILITY							
Sealed Maintenance-Free Battery Types	D.C. Voltage	Model Number		*Watts to 87 1/2% of Rated Battery Voltage			
		ELF-645 Lamps Heads	ELF-2 Lamp Heads	1 1/2 hrs.	2 hrs.	3 hrs.	4 hrs.
Nickel-Cadmium Δ	6	2RD6C1	2RD6C1/ELF2	18	12	10	-
Long-Life Lead Δ	6	2RD6E1	2RD6E1/ELF2	18	11	8	-
Lead-Calcium Δ	6	2RD6M1	2RD6M1/ELF2	18	12	9	-
UNIT EQUIPMENT - WITH REMOTE CAPABILITY							
Nickel-Cadmium Δ	6	2RD6C2	2RD6C2/ELF2	25	18	12	9
	12	2RD12C3	2RD12C3/ELF2	36	21	15	12
Long-Life Lead Δ	6	2RD6E2	2RD6E2/ELF2	27	19	14	10
	12	2RD12E3	2RD12E3/ELF2	36	24	17	13
Lead-Calcium Δ	6	2RD6M2	2RD6M2/ELF2	27	18	14	10
	12	2RD12M3	2RD12M3/ELF2	36	25	20	14

\*National Electrical Code Specification

Δ = Improved Diagnostics Available

### DIMENSIONS

Dimensions are approximate and subject to change.

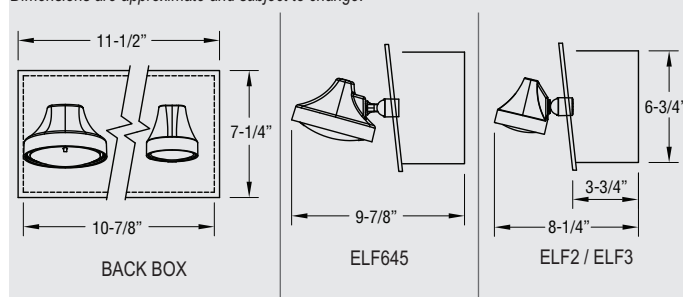

### ORDERING FORMAT

For standard units without options only order Heads Series, Battery, Capacity and Lamps

2	RD	12	C	1	/L9	-TD
No. of Series Heads*	DC Battery Backup	Battery Type	Capacity Indicator	Lamp	Suffix**	Option
		Ni-Cad		12V 9W Incandescent		Time Delay

\* Includes Standard Lamp.

\*\* see lamp data sheet for other lamp wattages.

## ■ 605P1 Series



### ▣ DIMENSIONS

Dimensions are approximate and subject to change.

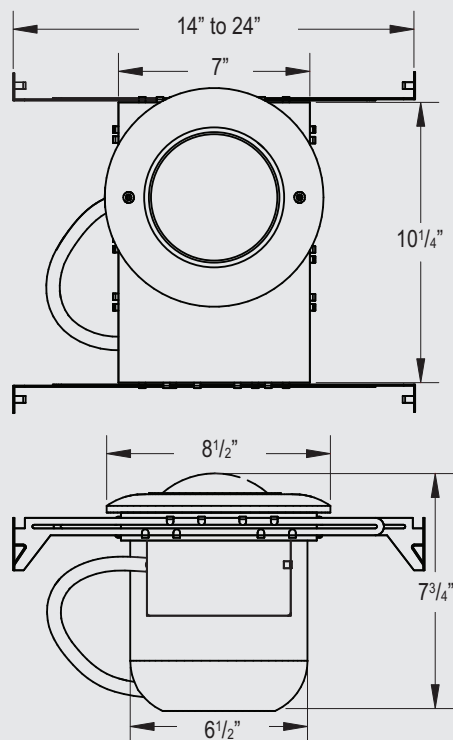

### ▣ UNIT RATING CHART

NO REMOTE CAPABILITY						
Volts	Model Number	Battery Type	*Watts to 87½% of Rated Battery Voltage			
			1½ hrs.	2 hrs.	3 hrs.	4 hrs.
6	LS605P1-HB	Lead-Calcium	10	-	-	-
6	605E1/LH5-R	Long-Life Lead	9	-	-	-
WITH REMOTE CAPABILITY						
6	605C1/LH5-R	Nickel-Calcium	18	12	9	-
6	605E2/LH5-R	Long-Life Lead	18	11	8	-

\*National Electrical Code Specification

**6 Volt Decorative Recessed Gimbal**  
**Maintenance-Free, Lead-Calcium, Long Life**  
**Lead or Nickel-Cadmium Battery**  
**UL Listed**

The **605P1 Series**, a classic top-hat style unit with gimbal mounted lamp, fully recesses into ceiling with only the lens and trim visible. Ideal for low ceilings and blends inconspicuously with existing recessed lighting schemes.

### ▣ FEATURES

#### Reliability

The **605P1 Series** has a three-year full warranty (excluding lamps).

#### Unit Data

All components are contained in drawn steel box. The upper side of the recessed steel housing contains the battery and charger. The lower portion of the housing will contain an 8 watts halogen lamp with a horizontal rotation of 358° and vertical angle adjustable to ±42°. Standard finish of trim is mist-white plastic. NYC approved version will include a metal trim and gimbal assembly, also finished in mist-white. The LED pilot light and test switch are located on the side of the lamp ring.

The 605P1 Series comes standard with a slide out chassis and two quick-connect plugs to make installation and servicing easy. Adjustable hanger bars are supplied with each unit.

#### Lamp

Furnished with one 6 volt, 10 watt high intensity halogen lamp.

#### PulseType Charger

- Automatic, temperature compensated, pulse type charger.
- High capacity, automatic, dust-tight instantaneous transfer relay.
- Low voltage disconnect prevents overdischarge of battery. Automatic brownout protection is provided.
- Labor saving AC line latch prevents battery discharge during installation to a non-energized circuit.
- Fused output circuit.

#### Controls

- Combination AC-ON/charge monitor LED
- Momentary test switch allows for quick operational check of entire system.

#### Power Requirements

120/277Vac, 60Hz, 0.3/0.15 Amp

### ▣ OPTIONS

(Add Suffix to Model No.)	Suffix
Black Housing and Gimbal .....	-B
NYC Approved Version .....	-M *

\*Includes metal trim and gimbal assembly.

### ▣ ACCESSORIES

(Order as a separate item)

Remote Test Switch (Metal faceplate).....	PSW
Remote Test Switch (Plastic faceplate).....	PSW1

### ▣ ORDERING FORMAT

605	E1	/LH5	-R	-M
Series	Battery Type	Lamp	Suffix	Recessed
	Capacity			Option
	(see chart)			NYC Approved

## ■ RSTH Decorative Series

### 6 Volt Self-Powered Recessed Down Light

### Maintenance-Free, Long Life Nickel-Cadmium Battery

### Evaluated to UL 924 Standard

The **RSTH Decorative Series** integrates contemporary design elements with the latest in high-tech emergency lighting capabilities. This self-powered down light brings architects, designers and engineers a sleek, refreshing new take on emergency lighting solutions. Designed with clean, classic lines and available in a range of colors and tones to compliment any commercial or high-end interior where taste is a factor.

## ■ FEATURES

### Reliability

The **RSTH Decorative Series** has a three-year full warranty (excluding lamps and fuses).

### Unit Data

This internally self-powered recessed down light is constructed of a durable powder coated, die cast aluminum and uses a MR16 lamp source powered by a sealed Nickel-Cadmium battery. The RSTH is furnished with a metal, fully recessed back box to house the electronics, battery and wiring. The duration of operation provided by the Nickel-Cadmium battery is 90 minutes minimum, as required by NFPA101 Life Safety Code. Standard finish is white, but also available in black, brushed nickel, chrome and polished brass. Adjustable hanger bars are supplied with each unit.

### Lamp

Furnished with one 6 volt, 6 watts MR16 halogen lamp. The Light source is fully adjustable by rotating the gimbal through 359° in azimuth and or positioning the lamp through 90° in pitch.



### Charger

Dust tight relay automatically and instantly energizes lamp load upon failure of AC supply. Battery protection circuit automatically shuts down lamp load when battery reaches 87-1/2% of it's rated voltage. Charger is 100% solid state, includes auto-equalize, temperature compensation and is controlled by a 1% Zener reference.

### Power Requirements

- 120V, 60 Hz, 0.046 A, 4.17W
- 277V, 60 Hz, 0.024 A, 4.76W

## ■ ACCESSORIES

(Order as a separate item)

- Remote Test Switch (Metal faceplate).....PSW
- Remote Test Switch (Plastic faceplate).....PSW1

## ■ DIMENSIONS

*Dimensions are approximate and subject to change.*

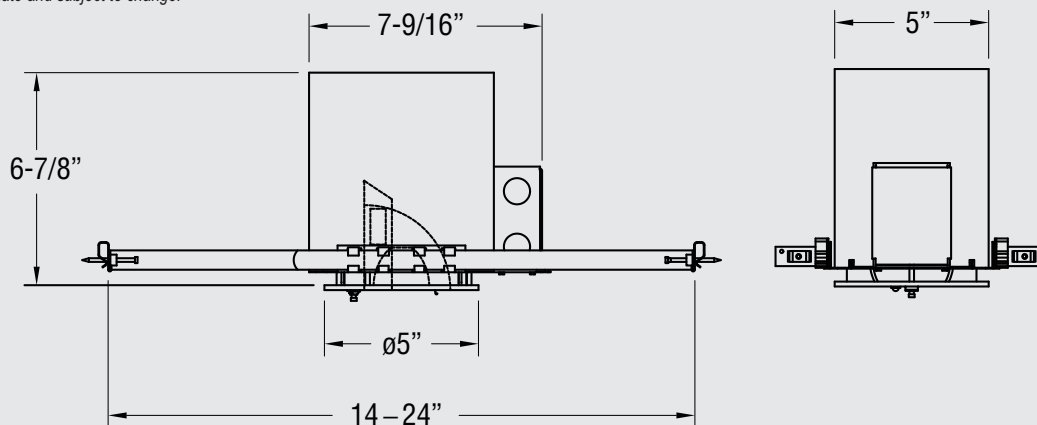

RSTH Decorative Series including back box

## ■ ORDERING FORMAT

RSTH24	WH	SP	- U
Series	Color	Emergency Back-up	Model
	WH= White	SP= Self-Powered	-U= USA model
	BK= Black		
	BN= Brushed Nickel		
	CH= Chrome		
	PB= Polished Brass		

Replacement lamp number: 580.0074-L 6V 6W

## ■ Square-Lite SQ, SQ-D Series



### ▣ DIMENSIONS

Dimensions are approximate and subject to change.

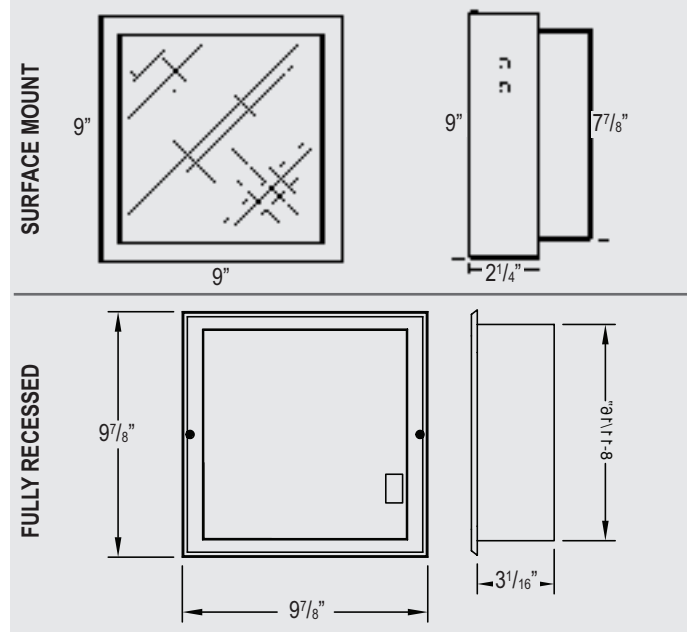

### ▣ UNIT RATING CHART

NO REMOTE CAPABILITY				
Volts	Model Number	Battery Type	*Watts to 87 1/2% of Rated Battery Voltage	
			1 1/2 hrs.	2 hrs.
6	SQG/LH7	Sealed Lead-Calcium	10	-
6	SQN/LH7	Nickel-Cadmium	10	-
WITH REMOTE CAPABILITY				
6	SQG-D/LH5	Sealed Lead-Calcium	24	18
6	SQN-D/LH5	Nickel-Cadmium	30	18

\*National Electrical Code Specification

### ▣ ORDERING FORMAT

SQ	G	/LH7	-V
Series	Battery Type	Lamp Suffix 6V 10W Halogen	Option Voltmeter

### 6 Volt Decorative Style Equipment Sealed Maintenance-Free Lead-Calcium or Nickel-Cadmium Battery UL Listed

The **SQ, SQ-D Series** was designed for institutional and commercial environments where overall style of décor is essential, but directional lighting is not critical. The standard Square-Lite is available as surface mount, but optional mounting includes semi-recessed and fully recessed.

### ▣ FEATURES

#### Reliability

The **Square-Lite "SQ" Series** has a three-year full warranty (excluding lamps and fuses).

#### Unit Data

The Square-Lite unit is constructed of impact resistant, flame retardant, lightweight thermoplastic material in mist white color with a black back. A metal back box is provided where recessed installation is required. The all-metal fully recessed version is constructed of 20-gauge steel with a white baked enamel surface trim. All models are furnished with a specially designed reflector and prismatic lens. SQR conversion kit is available for semi-recessing into ceiling. FSQR, conversion kit available for fully recessed fixture. Bar hangers supplied with recessed kit. To order fully recessed metal fixture, please refer to Options.

#### Lamp

Furnished standard with one high efficiency tungsten halogen lamp (6 volt, 6, 8 or 10 watts). Provides a non-directional even light distribution with beam spread of more than 170°. The two-lamp option is available by specifying "-2" suffix (see Options).

#### PulseType Charger

- Automatic, temperature compensated, pulse type charger.
- High capacity, automatic, dust-tight instantaneous transfer relay.
- Low voltage disconnect prevents overdischarge of battery. Automatic brownout protection is provided.
- Labor saving AC line latch prevents battery discharge during installation to a non-energized circuit.
- Fused output circuit.

#### Controls

- Red charger monitor LED indicates the state of charge of the battery.
- Momentary test switch allows for quick operational check of entire system.

#### Power Requirements

120/277Vac, 60Hz, 0.3/0.15 Amp

### ▣ OPTIONS

(Add Suffix to Model No.) Prefix  
Fully Recessed Metal ..... R \*

\*Bar hangers included

(Add Suffix to Model No.) Suffix  
Improved Diagnostics (audible) ..... -ID  
Improved Diagnostics (Non-audible)..... -IDNA  
Ammeter or Voltmeter (choose only one) ..... -A\* or -V\*  
Two Lamps..... -2  
Polycarbonate Lens ..... -PL  
Time Delay (specify 5, 10 or 15 minutes) ..... -TD\_ \*\*

\*Not available with diagnostic options

\*\* (ID or IDNA) includes a Time Delay function, if needed it can be enabled/disabled in the field or it can be preset at the factory by including the suffix ID-TD\_ or IDNA-TD\_

### ▣ ACCESSORIES

(Order as a separate item)

Wire Guard (For Semi-Recessed)..... WG1-L  
Wire Guard (For Fully-Recessed) ..... WG11-L  
Semi-Recessed Conversion Kit ..... SQR  
Full-Recessed Conversion Kit ..... FSQR

Matching style remote fixture, Model ELF644 available, see remote fixtures section.



## ■ Sunspec Series

### Dual-Purpose Decorative Ceiling Luminaire

### Sealed Maintenance-Free Long Life, Nickel-Cadmium Battery

### Evaluated to UL 924 Standard

The **Sunspec Series**, with its sleek profile and circular shape, sets new standards for aesthetics and performance. The new generation of architectural emergency lighting fixtures that combines emergency mode operation with conventional, normally-on lighting.

## ■ FEATURES

### Reliability

The Sunspec Series has a three-year full warranty (excluding lamps and fuses).

### Unit Data

The unit opal diffuser is anti-corrosive, high-impact, injection-molded polycarbonate. The high temperature rated battery, the lamps and the electronic circuitry are installed on an innermetal chassis, which twists and locks into place for ease of installation and maintenance. The diffuser snaps into the thermoplastic back plate. Each unit is equipped with a dedicated connector for quick disconnect of the AC line. There are several trim assemblies and options available. The Sunspec Series can be surface-mounted or semi-recessed for ceiling and wall mount applications. The semi-recessed models are furnished standard with a bar hanger kit. The Sunspec Series is also available in AC-only for normal illumination, as well as with dual-mode illumination (emergency lighting and normal lighting).

### Lamp

The standard unit will include two high-efficiency, 11 watts (950 lumens each) 2G7 base compact fluorescent lamps. Normally-on models will be powered by high efficiency, high frequency ballasts. Failure (absence) on one lamp will not affect the function of the second lamp. Emergency mode initial light output shall be at least 50% of rated lamp output lumen.

### Charger

A new generation, solid state circuitry including battery charger and high frequency inverters to drive the compact fluorescent lamps. Failure (absence) of one lamp shall not affect the function of the second lamp. The battery unit will supply the rated load for a minimum of 90 minutes.

### Power Requirements

- 120Vac, 60Hz, 0.06 Amps, 7 watts
- 277Vac, 60Hz, 0.03 Amps, 7 watts

## ■ ORDERING FORMAT

SUNS	M	SP	12	W	A	W		-IDNA
Series	Unit Type	Emergency Back-up	Voltage/ Lamp Wattage	Body Color	Trim Type	Trim Color	Mounting Options	Options
SUNS= Sunspec Fixture	M= Normally-On	SP= Self-Powered	12= 120Vac, 2 x 11W, CFL 22= 277Vac, 28W 2D, CFL 11= 120Vac, 28W 2D 21= 277Vac, 28W 2D	W= White B= Black	Blank= No Trim	W= White	Blank= Surface Mount	-IDNA= Improved Diagnostics Non-Audible
	A= Angled				B= Black	PD= Pendant Mount		
	B= Banded				CH= Polished Chrome	SR= Semi-Recessed Mount*		
	NM= Normally-Off				SC= Slim Captive	PB= Polished Brass	RT= Semi-Recessed T-Bar Mount	
*Note: Semi-Recessed is NI (Non Insulation)								



## ■ DIMENSIONS

Dimensions are approximate and subject to change.

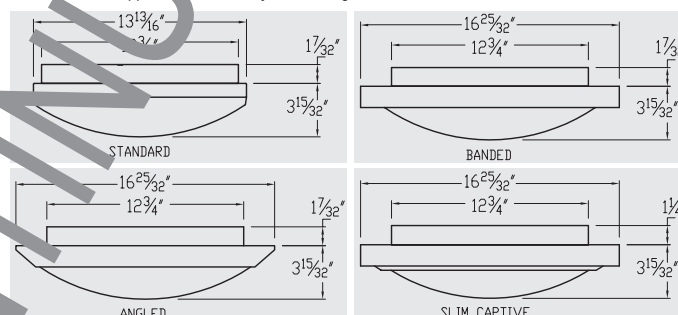

## ■ OPTIONS

(Add Suffix to Model No.)	Suffix
Improved Diagnostics Non-Audible.....	IDNA
Damp Location (10°C to 40°C), (50°F to 104°F)	
normally-off only .....	DL
Semi-Recessed Mount .....	SR*
Semi-Recessed T-Bar Mount .....	RT*

\*Note: Semi-Recessed is NI (Non Insulation)

## ■ IMPROVED DIAGNOSTICS (optional)

The unit will come complete with a self-diagnostics micro-controller board. The unit shall self test for 1 minute every 30 days, 30 minutes on the 6th month and 90 minutes every 12 months.

## ■ Gloweye Series

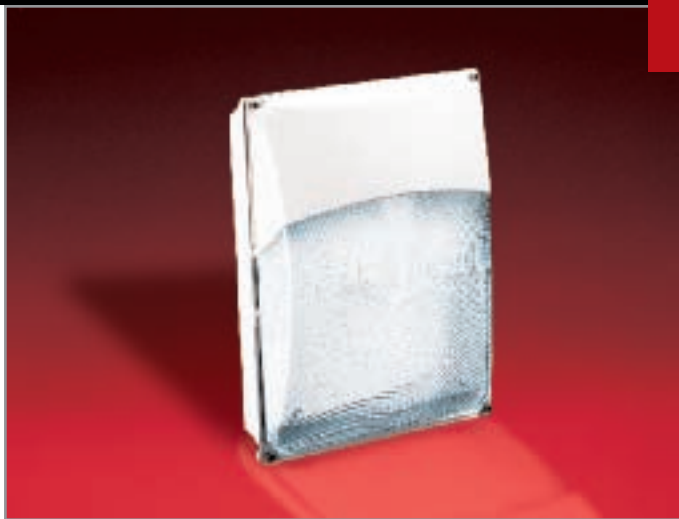

### ■ DIMENSIONS

Dimensions are approximate and subject to change.

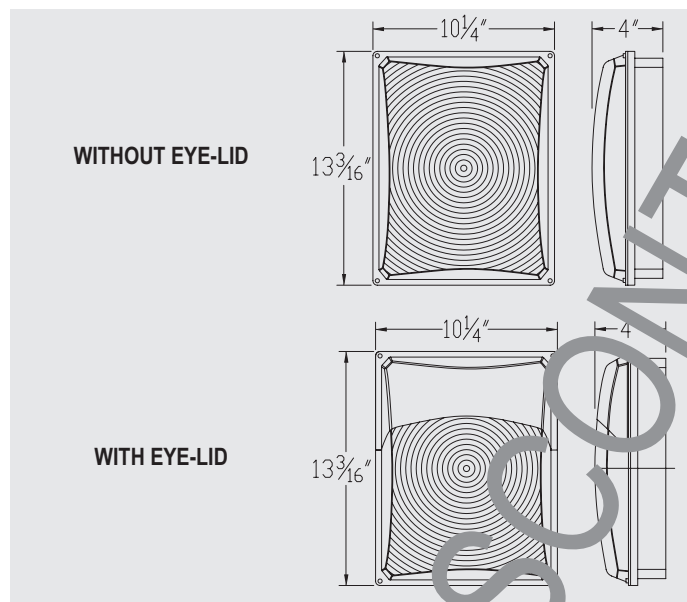

### ■ IMPROVED DIAGNOSTICS (optional)

The unit will come complete with a self-diagnostics micro-controller board. The unit shall self test for 1 minute every 30 days, 30 minutes on the 6th month and 90 minutes every 12 months.

### ■ ORDERING FORMAT

GLOW	M	SP	12	W	W	-IDNA
Series	Unit Type	Emergency Back-up	Voltage/Lamp Wattage	Body Color	Trim (Eye-Lid)	Options
GLOW= Gloweye Fixture	Blank= AC Only M= Normally-On NM= Normally-Off	SP= Self-Powered	12= 120Vac, 2 x 11W, CFL 22= 277Vac, 28W 2D, CFL 11= 120Vac, 28W 2D 21= 277Vac, 28W 2D	W= White B= Black G= Gray	Blank= No Eye-Lid *W= White Eye-Lid Cover *B= Black Eye-Lid Cover *G= Gray Eye-Lid Cover	-IDNA= Improved Diagnostics Non-Audible

\*Eye-Lid is suggested for wall mount applications

### Dual-Purpose Decorative Wall or Ceiling Luminaire Sealed Maintenance-Free long life, Nickel-Cadmium Battery Evaluated to UL 924 Standard

The **Gloweye Series**, the new generation of architectural emergency lighting fixtures, combining emergency mode operation with conventional, normally-on lighting. Ideal for damp, wet and humid covered areas such as indoor swimming pools and garages. An attractive design combined with the strength of a weatherproof enclosure.

### ■ FEATURES

#### Reliability

The **Gloweye Series** has a three year full warranty (excluding lamps and fuses).

#### Unit Data

The unit consists of a rectangular, injection-molded thermoplastic housing and is furnished standard with a clear prismatic polycarbonate diffuser. The diffuser is fixed onto the thermoplastic back plate with four screws. The nonobtrusive test switch, pilot light, lamps and battery are all concealed under the diffuser. Optional body and trim (eye-lid) colors are available. This unit is Nema-3 rated for damp and/or wet location. Unit is offered with option of dual mode illumination, emergency lighting and normal illumination, as well as AC-only units.

#### Lamps

The standard unit will include two high-efficiency, 11 watts (950 lumens each) E-C7 base compact fluorescent lamps. Normally-on models will be powered by high efficiency, high frequency ballasts. Failure (absence) on one lamp will not affect the function of the second lamp. Emergency mode initial light output shall be at least 50% of rated lamp output lumen.

#### Charger

A new generation, solid state circuitry including battery charger and high frequency inverters to drive the compact fluorescent lamps. Failure (absence) of one lamp shall not affect the function of the second lamp. The battery unit will supply the rated load for a minimum of 90 minutes.

#### Power Requirements

- 120Vac, 60Hz, 0.06 Amps, 7 watts
- 277Vac, 60Hz, 0.03 Amps, 7 watts

### ■ OPTIONS

(Add Suffix to Model No.)	Suffix
Improved Diagnostics Non-Audible .....	IDNA
Opal Lens .....	OP
Damp Location (10°C to 40°C), (50°F to 104°F) normally-off only .....	DL
Vandal Resistant Screws .....	VR

Note: Non-maintained= Normally-off Maintained= Normally-on



## ■ Permanence Series

**Dual-Purpose Decorative Wall or Ceiling Luminaire**  
**Sealed Maintenance-Free long life, Nickel-Cadmium Battery**  
**Evaluated to UL 924 Standard**

The **Permanence Series** was designed for institutional and commercial environments where overall style of décor is essential, but directional lighting is not critical. The unit is available as surface mount, semi-recessed or fully recessed mount.

### ■ FEATURES

#### Reliability

The **Permanence Series** has a three-year full warranty (excluding lamps and fuses).

#### Unit Data

The battery, lamps and the electronic circuitry are installed on an inner metal chassis, constructed of rugged 20-gauge steel. The front and side translucent diffusers are made of injection molded, durable polycarbonate, which completely encompass the lamps, AC pilot light and test switch. Each unit is equipped with a dedicated connector for quick disconnect of the AC line. Choice of white, black or gray finishes. The Permanence Series can be surface mounted or recessed for ceiling and wall-mount applications. The recessed models are furnished standard with steel trim plate. Permanence is offered with options of dual mode illumination, emergency lighting and normal illumination, as well as AC-only units.

#### Lamp Heads

The standard unit will include two high-efficiency, 11 watts (950 lumens each) compact fluorescent lamps or optional one PL 27 watt CFL. Normally on models will be powered by high efficiency, high frequency ballasts. Failure (absence) on one lamp will not affect the function of the second lamp. Emergency mode initial light output shall be at least 50% of rated lamp output lumen.

#### Charger

A new generation, solid state circuitry including battery charger and high frequency inverters to drive the compact fluorescent lamps. Failure (absence) of one lamp shall not affect the function of the second lamp. The battery unit will supply the rated load for a minimum of 90 minutes.

#### Power Requirements

- 120Vac, 60Hz, 0.06 Amps, 7 watts
- 277Vac, 60Hz, 0.03 Amps, 7 watts

### ■ OPTIONS

(Add Suffix to Model No.)

Improved Diagnostics, Non-Audible .....	<b>IDNA</b>
Damp Location (10°C to 40°C), (50°F to 104°F), normally-off only .....	<b>DL</b>
Recessed Mount .....	<b>RM*</b>
Recessed Mount T-Bar .....	<b>RT*</b>

\* Note: Recessed is NI (Non Insulation)

### ■ IMPROVED DIAGNOSTICS (optional)

(The unit will come complete with a self-diagnostics micro-controller board. The unit shall self test for 1 minute every 30 days, 30 minutes on the 6th month and 90 minutes every 12 months.

### ■ ORDERING FORMAT

PER	M	SP	12	W	-IDNA
<b>Series</b> <b>PER=</b>	<b>Unit Type</b> <b>M=</b> Normally-On <b>NM=</b> Normally-Off Fixture	<b>Emergency Back-up</b> <b>Blank=</b> AC only <b>SP=</b> Self-Powered	<b>Voltage/Lamp Wattage</b> <b>12=</b> 120Vac, 2 x 11W, CFL <b>22=</b> 277Vac, 28W 2D, CFL <b>11=</b> 120Vac, 28W 2D <b>21=</b> 277Vac, 28W 2D	<b>Body Color</b> <b>W=</b> White <b>B=</b> Black <b>G=</b> Gray	<b>Mounting Options</b> <b>Blank=</b> Surface Mount <b>RM=</b> Recessed Mount <b>RT=</b> Recessed Mount T-Bar
					<b>Options</b> <b>-IDNA=</b> Improved Diagnostics Non-Audible



### ■ DIMENSIONS

Dimensions are approximate and subject to change.

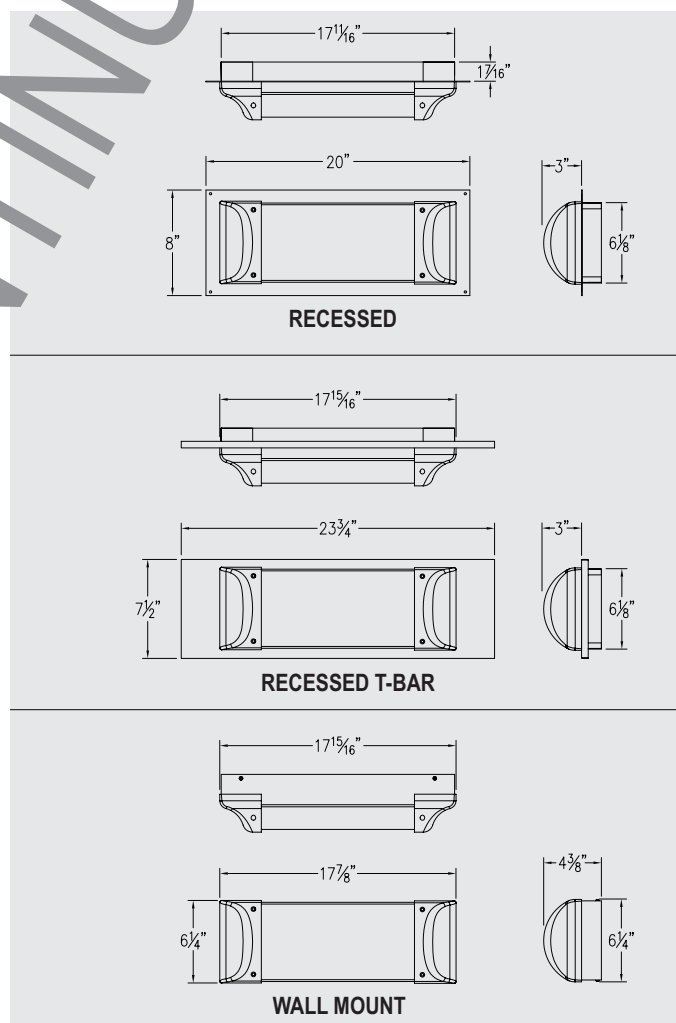



## ■ Notes

[illegible]