

Galaxy Series AC/DC, Self Powered LED Exit Sign

IMPORTANT SAFEGUARDS

When using electrical equipment, basic safety precautions should always be followed including the following:

READ AND FOLLOW ALL SAFETY INSTRUCTIONS

1. Do not use outdoors.
2. Do not let power supply cords touch hot surfaces.
3. Do not mount near gas or electric heaters.
4. Use caution when handling batteries. Avoid possible shorting.
5. Equipment should be mounted in locations and at heights where it will not readily be subjected to tampering by unauthorized personnel.
6. The use of accessory equipment not recommended by the manufacturer may cause an unsafe condition.
7. Do not use this equipment for other than intended use.
8. All servicing should be performed by qualified service personnel.

SAVE THESE INSTRUCTIONS

Installation Instructions

1. Turn off unswitched AC power.

Canopy mount

- a. Remove canopy assembly from carton. Remove mounting plate from canopy and retain securement screw.
- b. Route unswitched AC circuit wires into the junction box and leave 12" of wire length.
- c. Remove proper knockouts in mounting plate for desired mounting position.
- d. Feed unswitched AC wires through large hole in canopy mounting plate.
- e. Make sure the securement screw is accessible (see fig. 1 and 2). Use existing screws in junction box to secure canopy back plate to the junction box.
- f. Remove exit door. Firmly grip top of door and pull forward.
- g. In order to access the knockouts of the frame, first remove the top reflector assembly by removing the reflector assembly screw(s) (see fig. 3); there are two screws to remove for AC/DC models, and there is only one to remove for Self-Powered models.
- h. Determine which holes in the exit frame will be used for mounting. Support frame by two blocks of wood, maximum one inch apart. Strike knockouts with a hammer and screwdriver. Clear holes of burrs to allow proper fit with canopy.

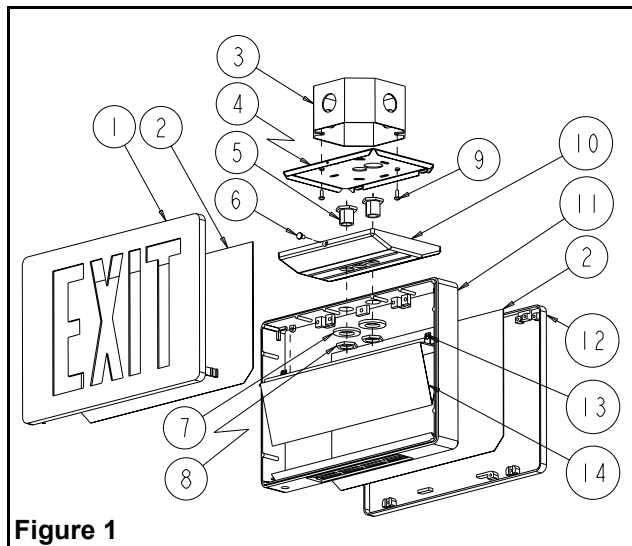

Figure 1

Part List

- | | |
|---------------------------------------------------------------------------------|------------------------------------------------------------------------------------|
| 1. Exit door | 9. Junction box screws (not supplied) |
| 2. Colored lens (one for single sided units and two for the double sided units) | 10. Canopy |
| 3. Junction box (not supplied) | 11. Exit frame |
| 4. Canopy back plate | 12. Exit back (or second exit door for double sided units) |
| 5. Nipple (2) | 13. Reflector assembly screw (two for AC/DC models or one for Self Powered models) |
| 6. Securement screw | 14. Reflector |
| 7. Nylon washer | |
| 8. Nut | |

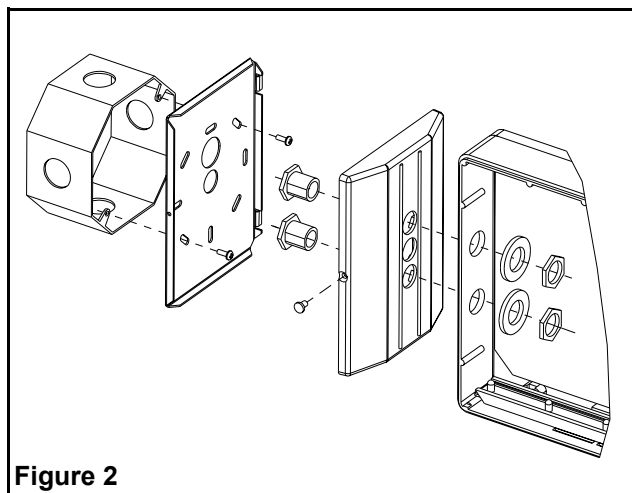

Figure 2

- i. Secure canopy to exit housing using the threaded nipples and nuts provided. Make sure the nipples are inside the canopy and the nuts and washer inside the exit sign (see fig. 2).
- j. To knock out chevrons (see fig. 3), remove colored lens(es) by warping center of lens and pulling out from the securement clips. Support door chevrons with two blocks of wood, strike chevron knockouts from the inside with a hammer and screwdriver. To reinstall colored lens(es), warp to slide under securement clips. Press securement clips tightly onto lens.
- k. Reinstall the reflector assembly on the frame with the reflector assembly screw(s). Ensure the PCB is correctly located in the grooves in the "V"-shaped reflector.
- l. Route AC service and ground wire from the sign into the canopy. Continue to step 2.

Wall mount (no canopy required)

- a. Determine the proper knockouts in the exit back cover for mounting. In order to access the knockouts, you may need to remove the top reflector assembly by removing the reflector assembly screw(s) (see fig. 3); there are two screws to remove for AC/DC models, and there is only one to remove for Self-Powered models.
 - b. Support area around knockouts with two blocks of wood. Strike knockouts from the inside with a hammer and a screwdriver.
 - c. Route AC and DC if applicable unswitched wires through large hole in the exit back cover.
 - d. Mount to the junction box with existing screws in the junction box (see fig. 4).
 - e. Reinstall the reflector assembly if applicable. Continue to step 2.
2. Connect the white lead to neutral and the purple lead to the AC line voltage (the input is universal 110 to 347 VAC). See fig. 5. For AC models used with DC remote power, connect the red lead to positive, and the blue lead to the negative of the remote DC input.
 3. For Canopy mount only: mount exit/canopy assembly to canopy back plate by guiding the two studs on the canopy plate into the holes in the canopy. Use the securement screw provided to fasten canopy to backplate (see fig. 2).
 4. Reinstall exit door(s).
 5. Energize AC. The AC On LED and the LEDs will illuminate.

Manual testing (Self-Powered Models)

To test, depress test switch (see fig. 6). The AC On LED will go out, the legend will flicker, but remain illuminated. Release test switch. The AC On LED will go on, the legend will flicker but remain illuminated.

Automatic testing (Self-Powered Models)

Unit will perform an automatic test of 30 seconds every 30 days, a 30 minutes every 60 days and 90 minutes every 12 months.

Automatic diagnostic (Self-Powered Models)

There are three diagnostic indicators: one external and two internal. Unit must be opened to gain access to internal indicators.

External: General alarm, "Service Required". The LED will blink if any alarm condition is detected (see fig. 6).

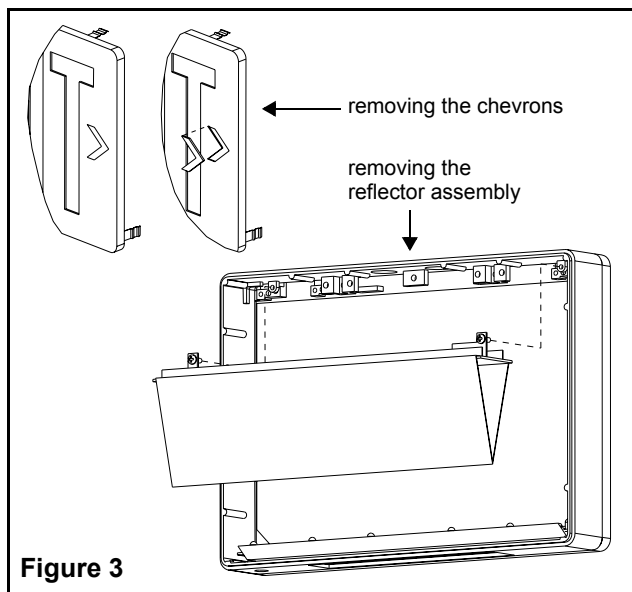

Figure 3

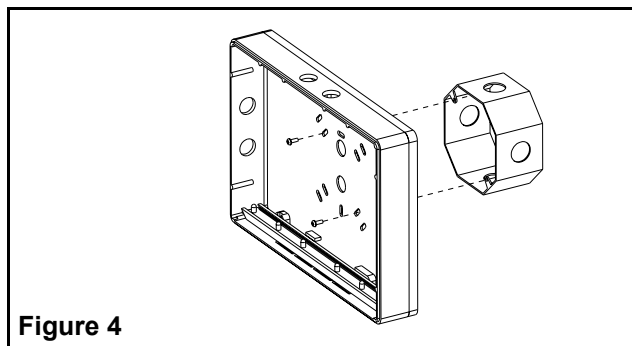

Figure 4

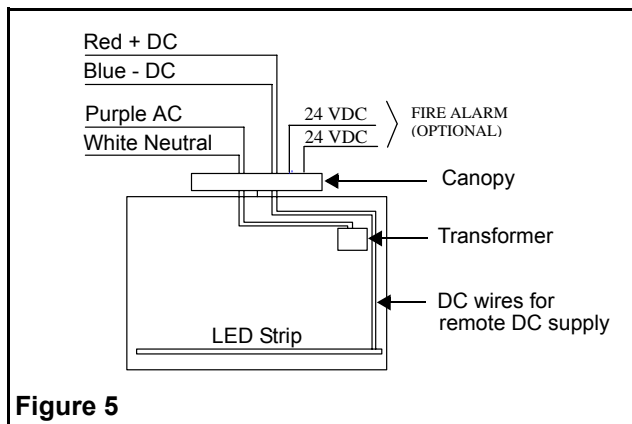

Figure 5

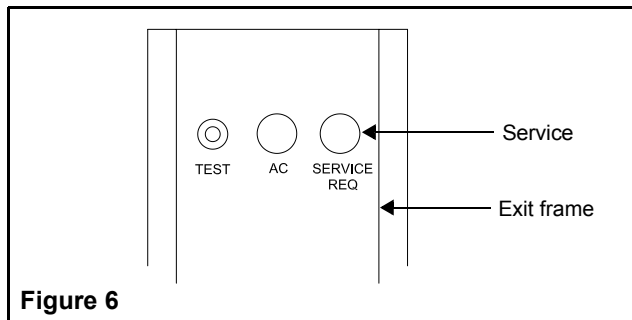

Figure 6

Internal: Battery Alarm (D1), Charger Alarm (D2). Steady ON if alarm condition exists (See fig. 7).

Normal operation, No fault — “Service Required” is OFF and one of the two internal LED blinks, showing that the micro controller is active.

Faulty operation — “Service Required” blinks.

Battery Alarm ON, Charger Alarm OFF: Check battery or replace battery.

Battery Alarm ON, Charger Alarm ON: Check LED strip.

Battery Alarm OFF, Charger Alarm ON: Check charger circuit.

Maintenance (All models)

None required. If AC supply to the unit is to be disconnected for 2 months or more, the battery must be disconnected, Self-Powered Models only.

